

A. General information

For proper operation of Tempomat/cruise control and correct adjustment of Tempomat/cruise control connecting rod or control cable, the following points must be observed:

- Check for easy operation and wear of regulating shafts, regulating lever, guide lever, ball sockets, Bowden wire and regulating linkage. Renew worn out parts.
- Clean dirty and hard-to-move regulating assemblies.
- Lubricate all bearing points of all regulating shafts, regulating levers, joints of regulating linkage and wire lines with an oil can.
- On (USA) version vehicles only the following hydraulic fluids may be used:
 - Castrol DB Hydraulik Fluid
 - Mobil Aero HFA
 - Shell Aero Fluid 4
- During assembly jobs, use protective anti-corrosion grease, part No. 000 989 87 15 10.

B. Engine 102 with Stromberg carburetor

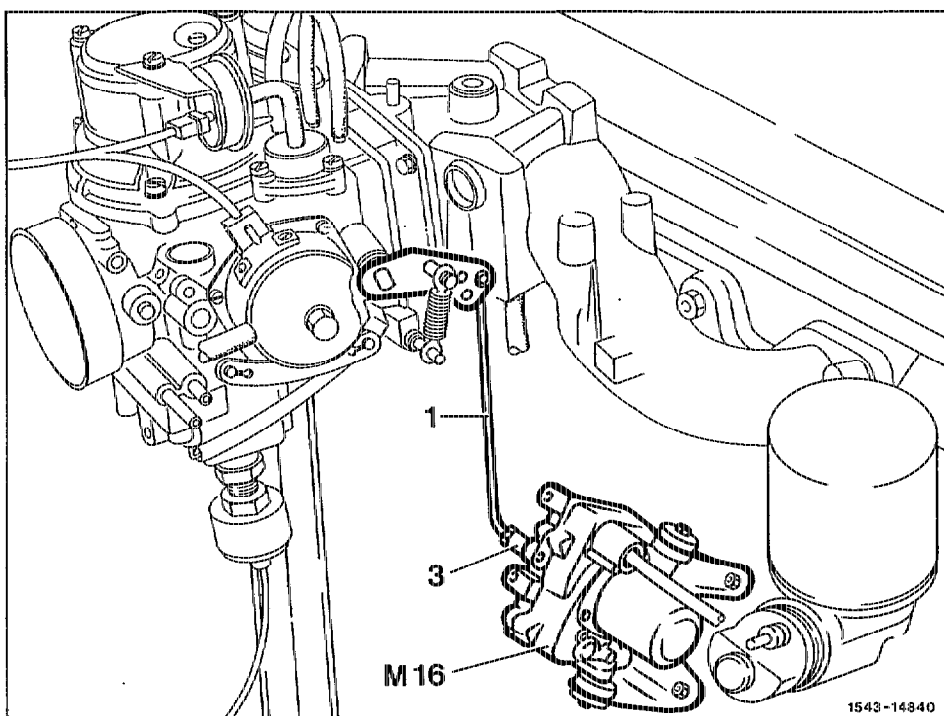

Engine	bring to operating temperature.
Engine	allow to idle.
Ball socket (3)	unlock, press off and secure.
Connecting rod (1)	detach, attach at Tempomat/cruise control (TPM) actuator (M16).
Lever of Tempomat/cruise control (TPM) actuator (M16)	push toward engine in idling speed position.
Connecting rod (1)	adjust approx. 1 mm or 1 revolution shorter.

C. Engine 102 with 2E-E carburetor

Preceding work:
Air cleaner removed (09-400).

Operation no. of operation texts and work units or standard texts
and flat rates

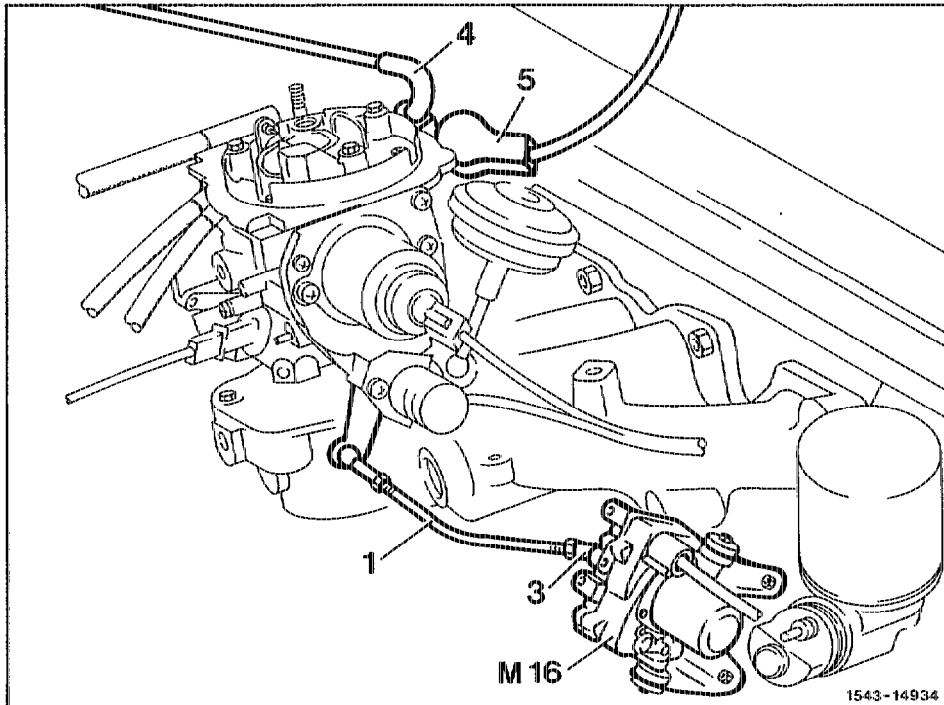

Plug from throttle valve actuator (5)	disconnect, connect.
Throttle valve actuator connection 2	contact to ground. (Using electrical connection set 201 589 00 99 00).
Throttle valve actuator connection 8	contact to battery positive. (Using electrical connection set 201 589 00 99 00).
Throttle valve actuator	apply with vacuum until plunger is fully retracted then switch off voltage (valve coils are not constant current-proof). (Using hand vacuum pump 001 589 73 21 00).
Ball socket (3)	unlock, lock.
Connecting rod (1)	disengage, engage at Tempomat/cruise control (TPM) actuator (M16).

Lever of Tempomat/cruise control (TPM) actuator
(M16)
Connecting rod (1)

push towards engine in idling speed position.
adjust approx. 1 mm or 1 revolution shorter.

Special tools

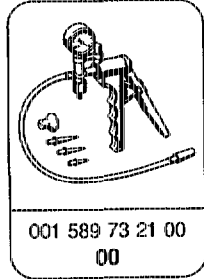
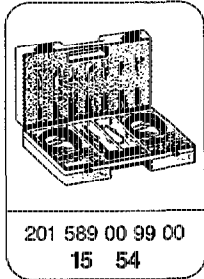

D. Engine 102 with injection system, except engines 102.983/990

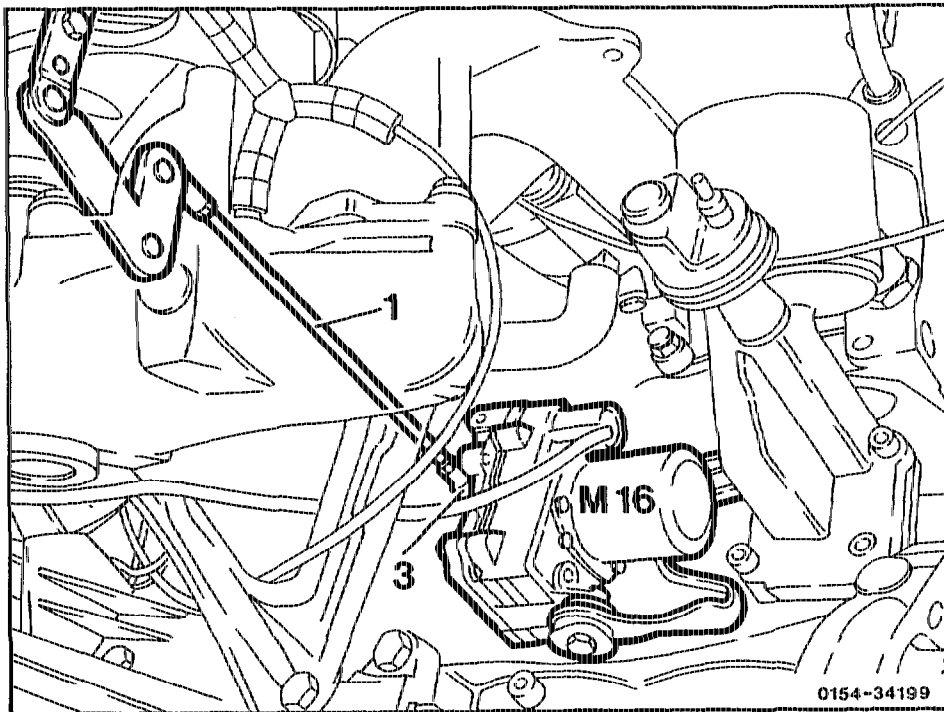

Ball socket (3)	unlock, lock.
Connecting rod (1)	detach, attach at Tempomat/cruise control (TPM) actuator (M16).
Throttle control	move into idle speed position.
Lever of Tempomat/cruise control (TPM) actuator (M16)	push toward engine in idling speed position.
Connecting rod (1)	adjust approx. 1 mm or 1 revolution shorter.

E. Engines 102.983/990

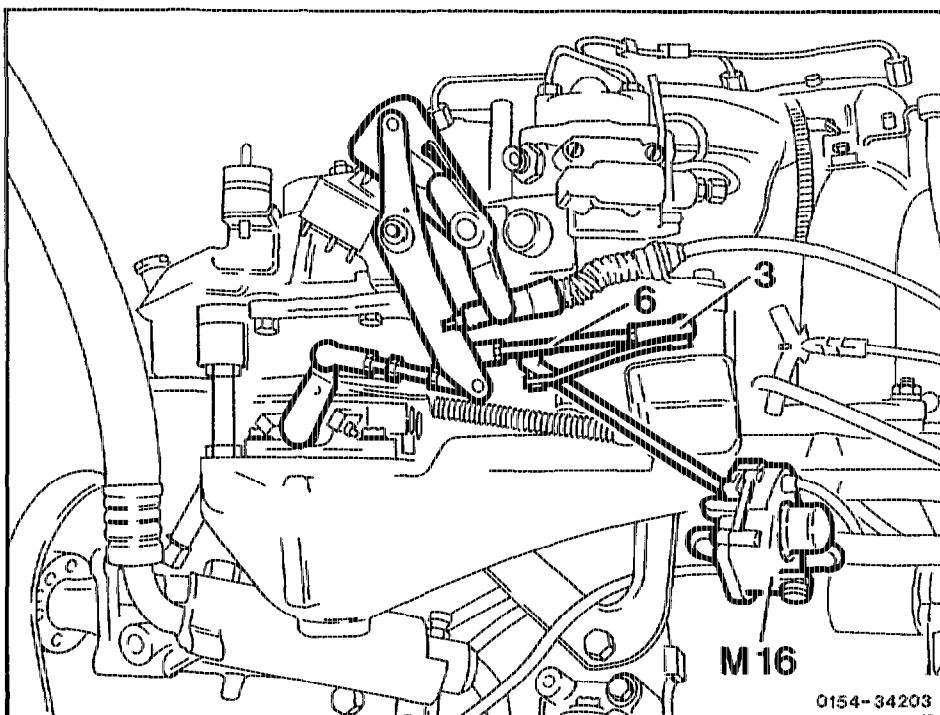

1st version up to approx. 30.06.86 (round rod)

Throttle control	move into idle speed position.
Connecting rod (6)	disengage, engage at reversing lever.
Ball socket (3)	unlock, lock.
Connecting rod (6)	adjust approx. 1 mm or 1 revolution shorter.

2nd version as of approx. 01.07.86 (profilated rod)

Hex. head screw	loosen at profilated rod (6).
Throttle control	move into idle speed position.
Lever of Tempomat/cruise control (TPM) actuator (M16)	raise approx. 1 mm from idle speed position and tighten hex. screw on the connecting rod (6) in this position.

F. Engine 103 and engines 104.980/981 with round rod

Preceding work:
Air cleaner removed (09-400).

Operation no. of operation texts and work units or standard texts
and flat rates

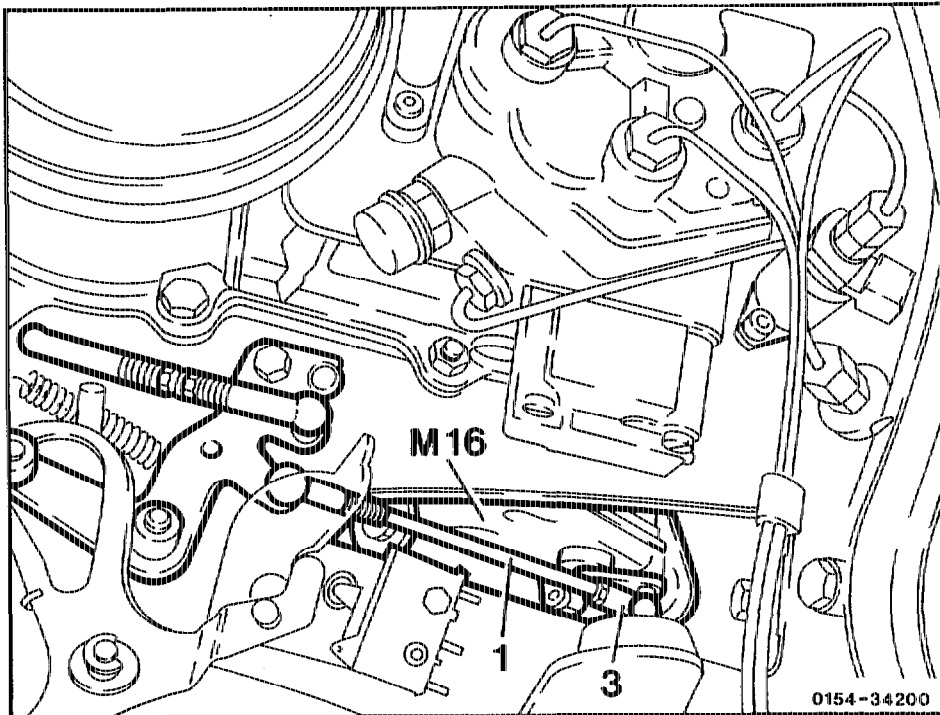

Ball socket (3)	unlock, lock.
Connecting rod (1)	disengage, engage at throttle control.
Throttle control	move into idle speed position.
Lever of Tempomat/cruise control (TPM) actuator (M16)	push with connecting rod (1) into idle speed position.
Connecting rod (1)	adjust approx. 1 mm or 1 revolution shorter.



On engine 104 (J) and (USA) version do **not** install a profilated rod instead of the round rod. At full throttle the distance between profilated rod (1) and coolant pipe is insufficient (arrow).

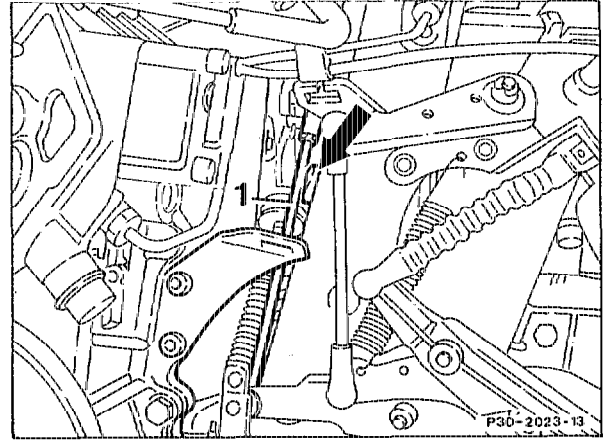

G. Engine 103 and engines 104.980/981 with profilated rod

Preceding work:
Air cleaner removed (09-400).

Operation no. of operation texts and work units or standard texts
and flat rates

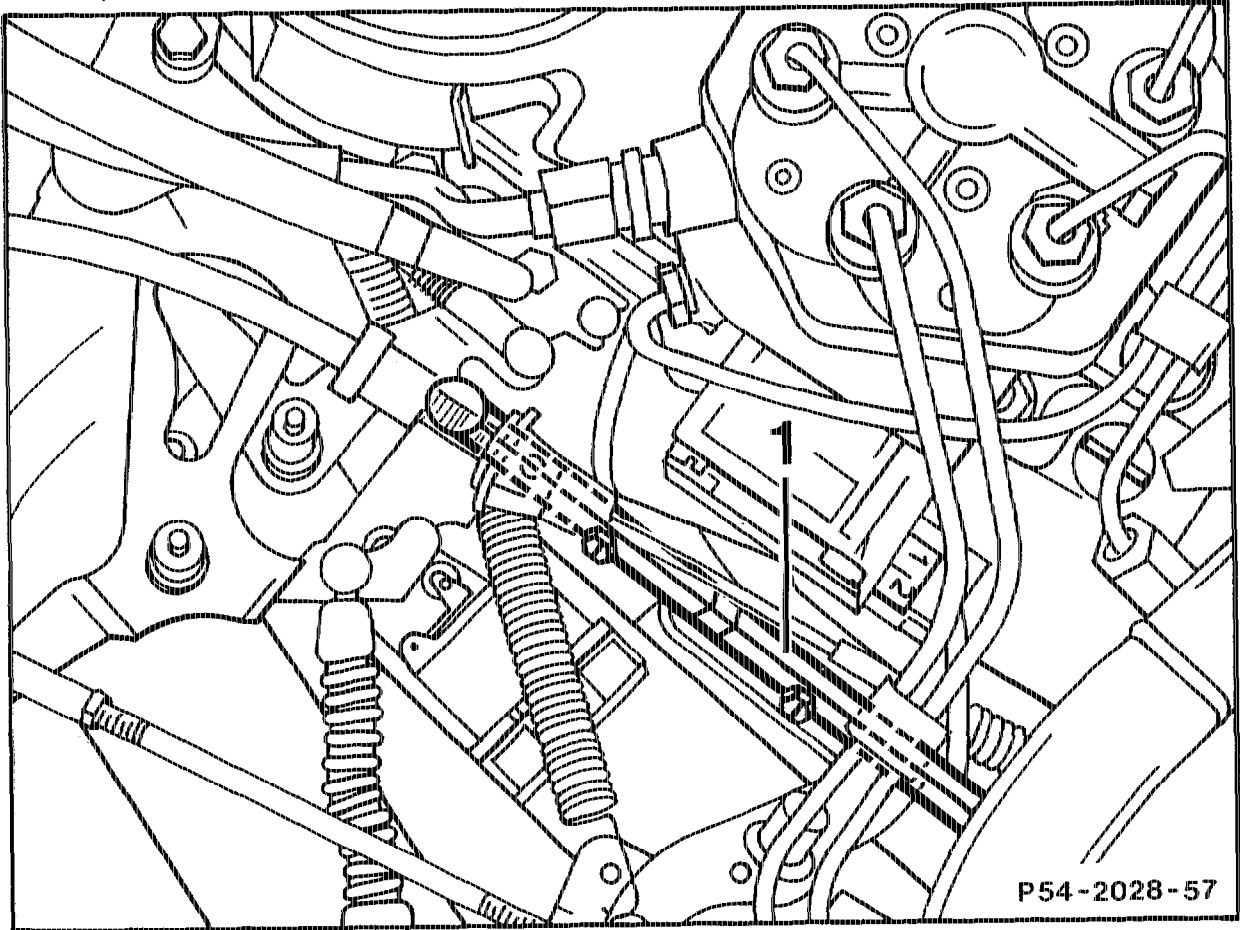

P54-2028-57

Connecting rod (1)	disengage, engage at throttle control.
Throttle control	move into idle speed position.
Lever of Tempomat/cruise control (TPM) actuator (M16)	push with connecting rod (1) into idle speed position.
Length of connecting rod (1)	check, should be 1 mm shorter. If required, remove connecting rod (1) and adjust.



On engine 104 (J) and (USA) version, only a round rod may be installed (refer to section F).

H. Engine 111

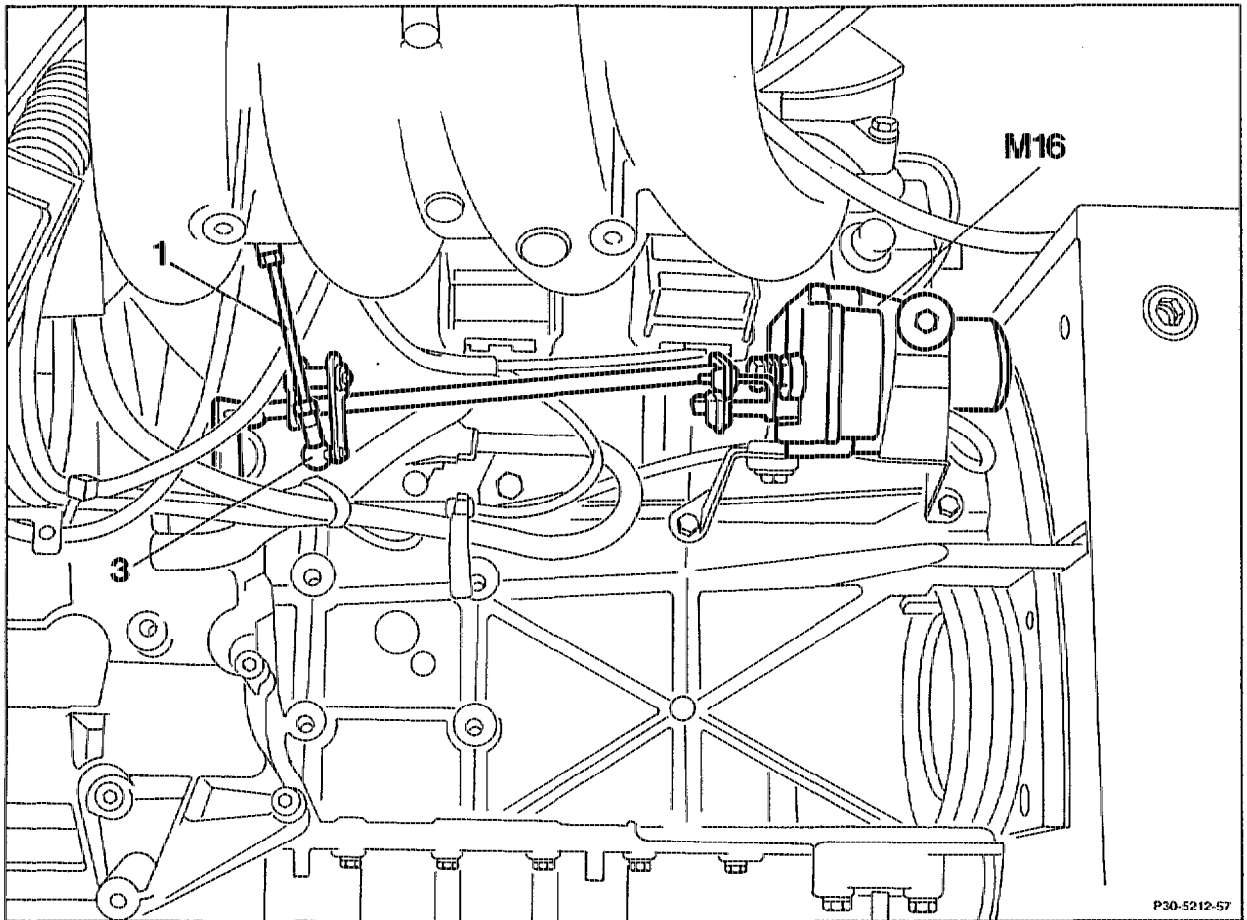

P30-5212-57

Ball socket (3)	unlock, lock.
Connecting rod (1)	disengage, engage.
Throttle control	move into idle speed position.
Lever of Tempomat/cruise control (TPM) actuator (M16)	push toward engine in idling speed position.
Connecting rod (1)	adjust approx. 1 mm or 1 revolution shorter.

I. Engine 119.960

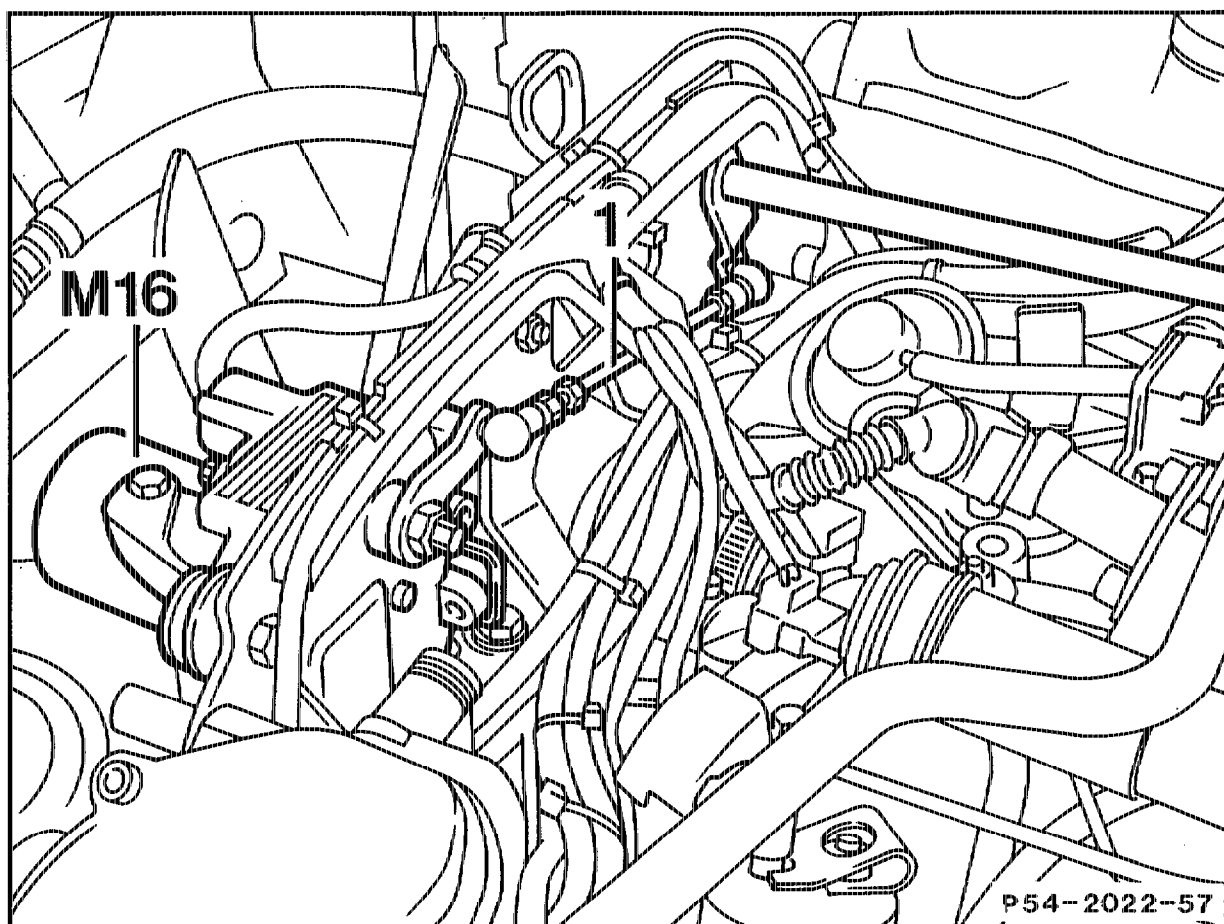

Cover prior to air cleaner	remove, install.
Ball socket	unlock, lock.
Connecting rod (1) at Tempomat/cruise control (TPM) actuator (M16)	disengage, engage.
Throttle control	move into idle speed position.
Lever of Tempomat/cruise control (TPM) actuator (M16)	push toward engine in idling speed position.
Connecting rod (1)	adjust approx. 1 mm or 1 revolution shorter.

J. Engines 601.91/92, 602.91 and 603.91

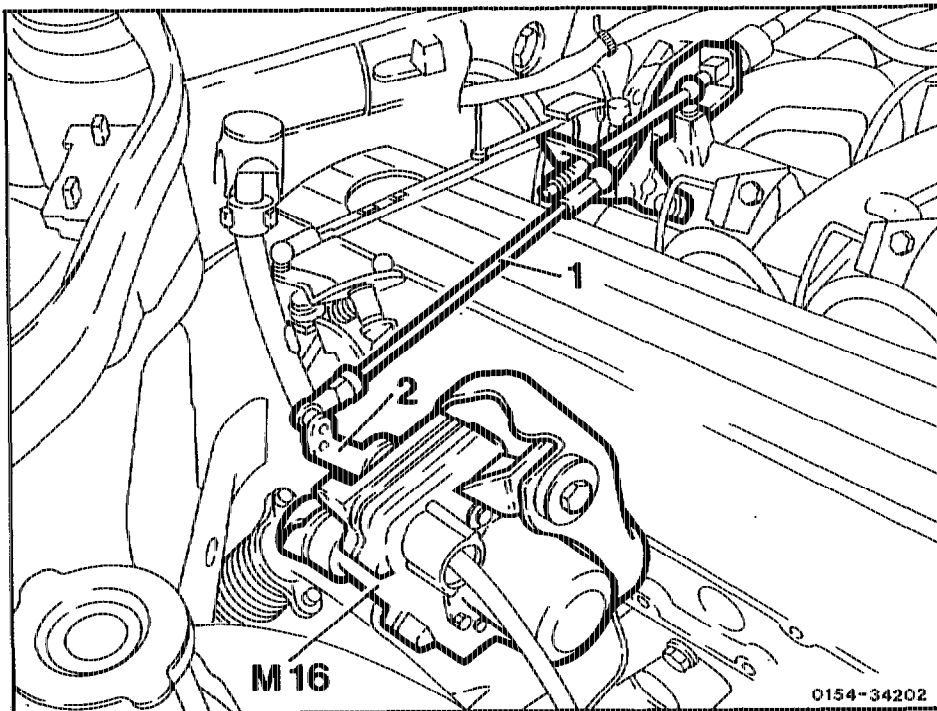

Ball socket	unlock, lock at Tempomat/cruise control (TPM) actuator (M16).
Connecting rod (1)	disengage, engage at Tempomat/cruise control (TPM) actuator (M16).
Throttle control	move into idle speed position.
Lever (2) of Tempomat/cruise control (TPM) actuator (M16)	push away from engine into idle speed position.
Connecting rod (1)	adjust approx. 1 mm or 1 revolution shorter.

Note

When replacing the connecting rod (1) be sure to install only the version with black ball heads. These parts are available as a repair set. This means that the connecting rod (1), the lever (2) on Tempomat/cruise control (TPM) actuator (M16) and the ball head on the regulating lever must be replaced simultaneously.

K. Engine 602.96

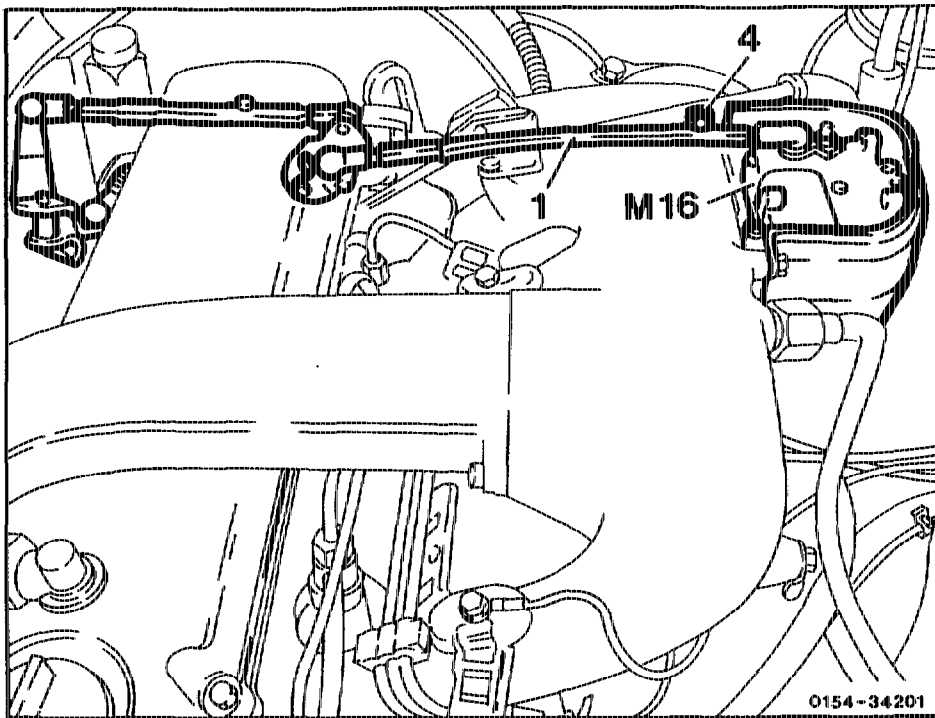

Hex. head screw (4)	loosen at profilated rod (1).
Throttle control	move into idle speed position.
Lever of Tempomat/cruise control (TPM) actuator (M16)	push toward engine in idling speed position.
Profilated rod (1)	adjust approx. 0.5 mm longer and tighten hex. head screw (4) in this position.

L. Engines 603.96/971

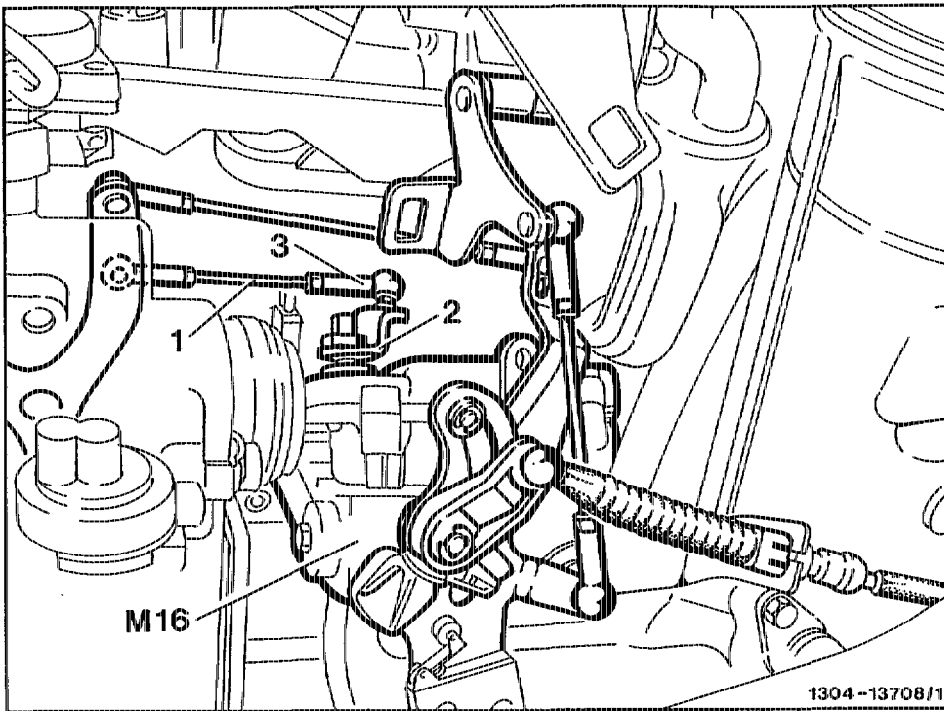

Ball socket (3)	unlock, lock.
Connecting rod (1)	disengage, engage at Tempomat/cruise control (TPM) actuator (M16).
Throttle control	move into idle speed position.
Lever (2) of Tempomat/cruise control (TPM) actuator (M16)	push into idle speed position.
Connecting rod (1)	adjust approx. 1 mm or 1 rotation shorter.

M. Engine 605

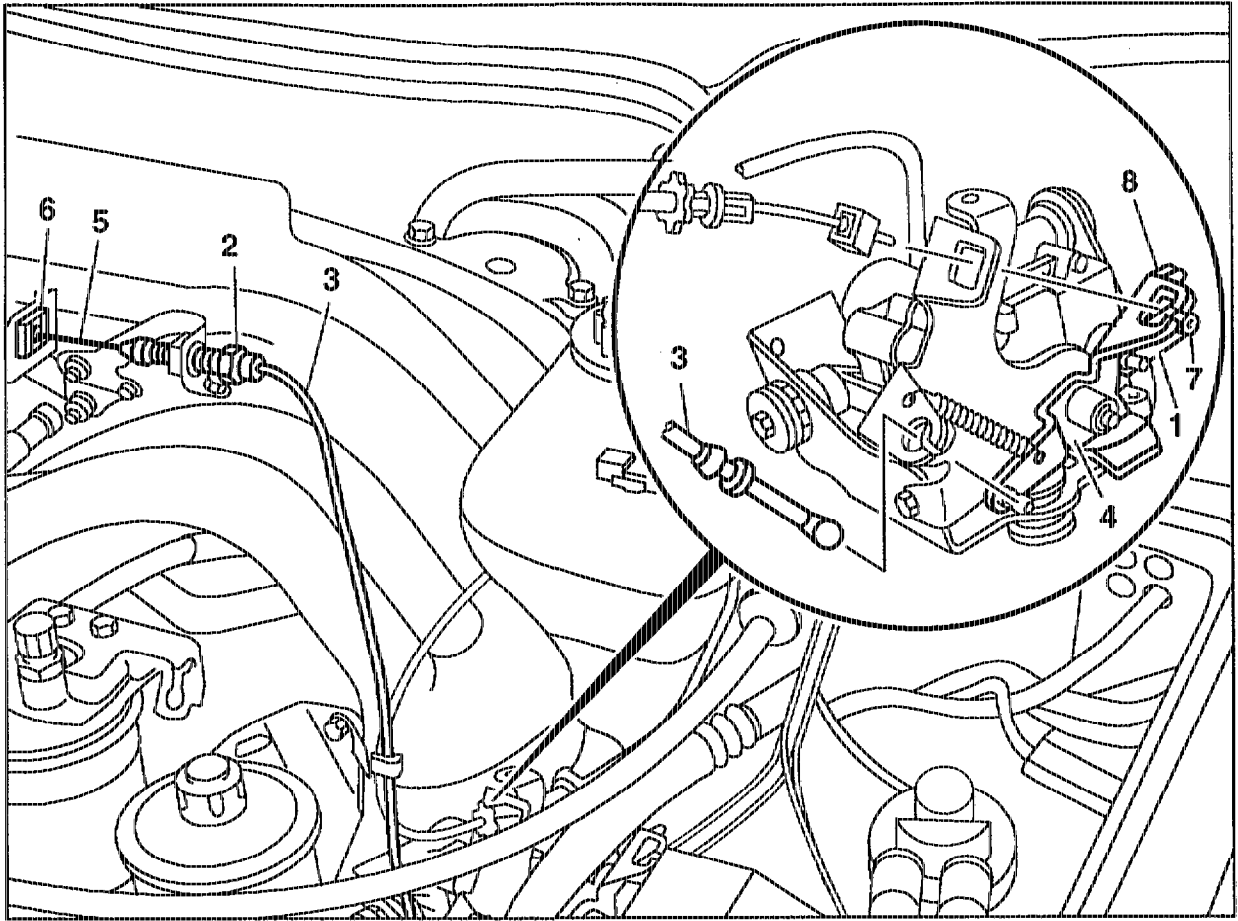

P30-5319-57

- Control lever (1) turn clockwise until it abuts the internal idle stop.
- By rotating the bowden cable adjusting screw (2) on the engine side adjust the control cable (3) until the gate lever (4) has reached the idle limit stop, or play between cable (5) and end piece (6) is approx. 0 to 1 mm.

Note

Gate roller (7) must abut idle limit stop (8) without any play.

N. Engine 606

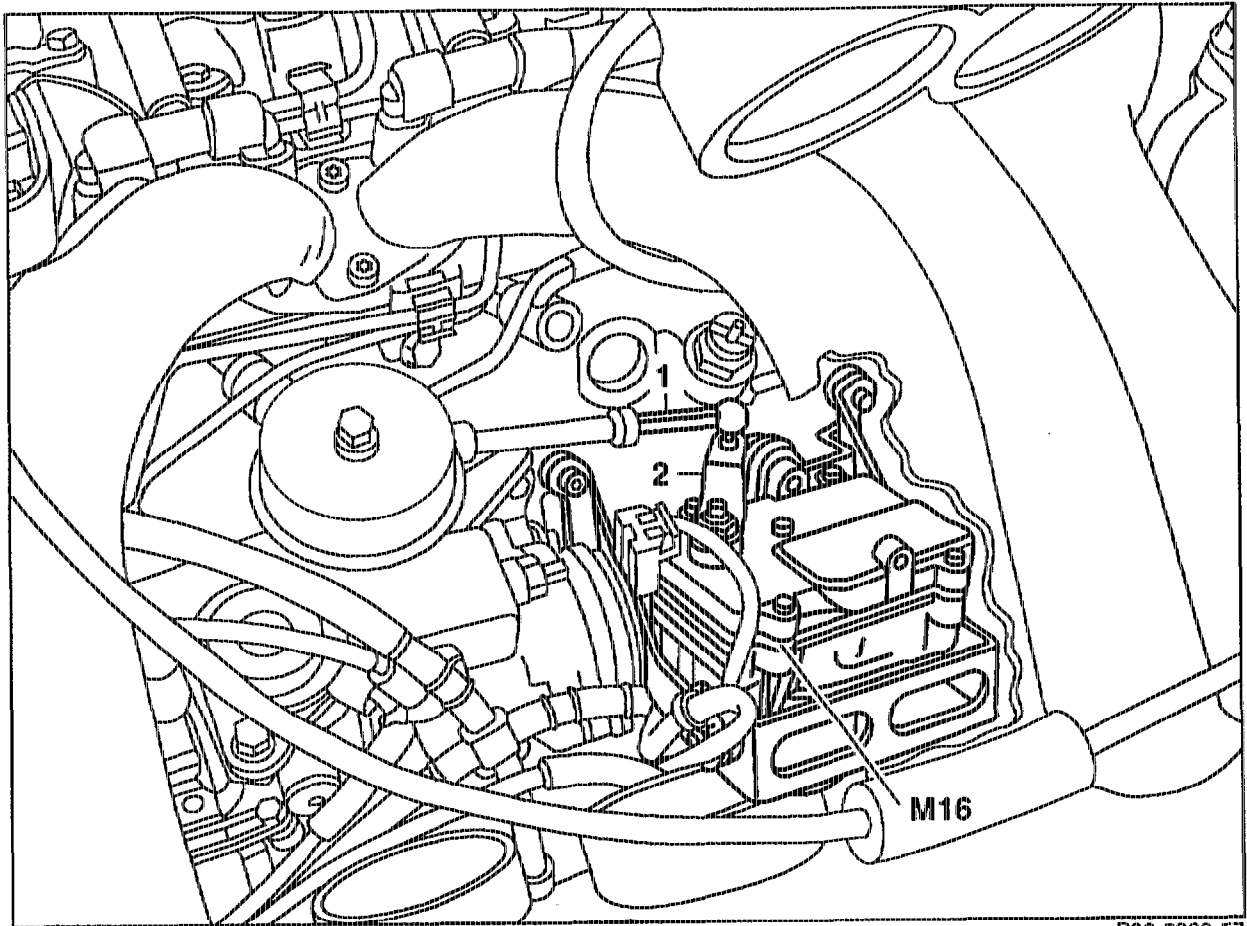

P30-5320-57

Resonance suction line	loosen and fold backwards, fold forwards and secure (14-1984).
Connecting rod (1) on Tempomat/cruise control actuator (M16)	disengage, engage.
Throttle control	move into idle speed position.
Lever (2) of Tempomat/cruise control actuator (M16)	push into idle speed position in opposite direction to arrow.
Connecting rod (1)	adjust approx. 1 mm or 1 revolution shorter.

Note

Pay attention to ease of movement and wear of connecting rods, transfer lever and ball sockets. Worn parts are to be replaced.