

20-2250 Sealing coolant pump

Preceding work:
Coolant pump removed (20-2100).

Operation no. of operation texts and work units or standard texts
and flat rates:
20-1884

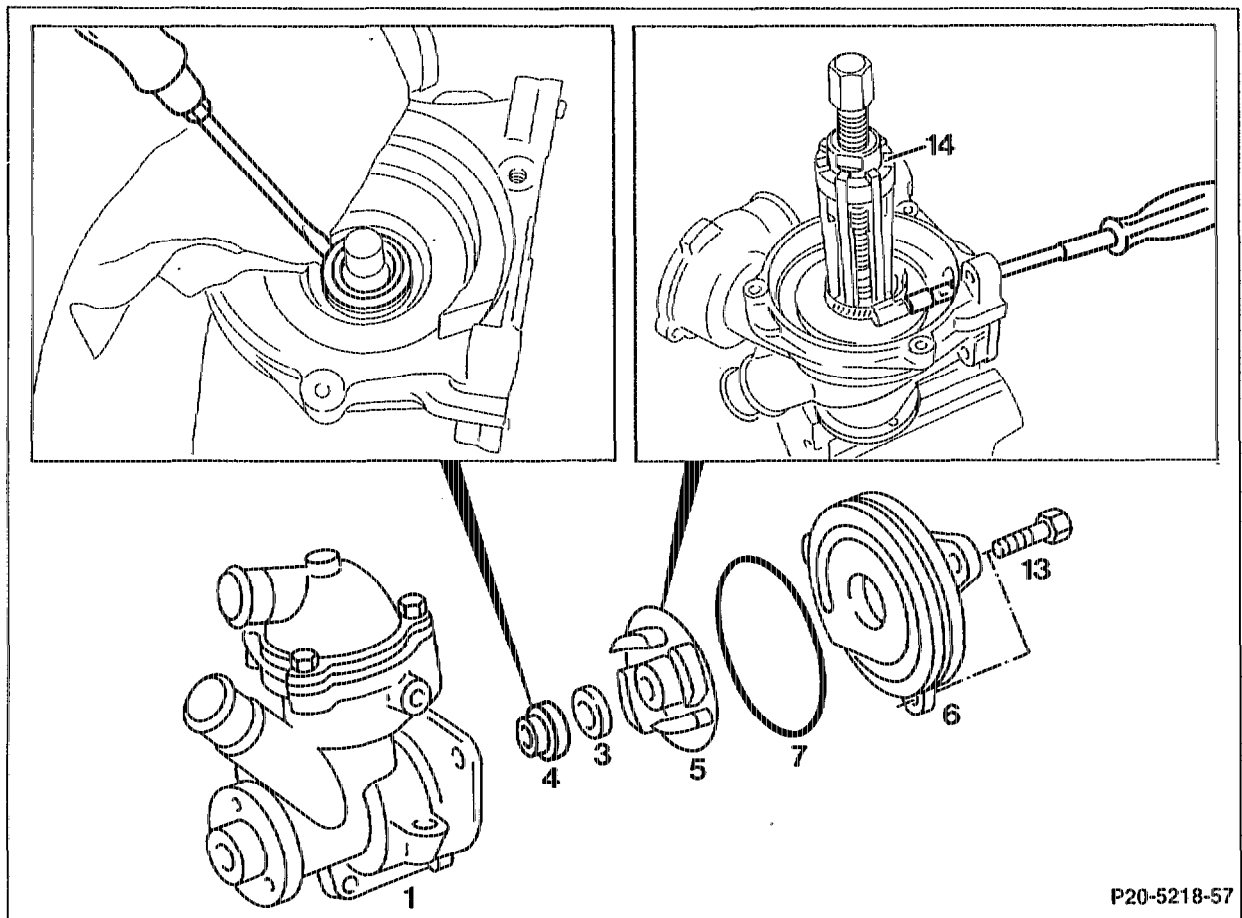

P20-5218-57

13 M6 x 20 bolt + washer

Spiral housing (6)	unbolt, bolt on (10 Nm).
O-ring (7)	replace.
Puller (14) 000 589 94 33 00	fit onto impeller (5).
Jaws of puller (14)	tension with sleeve inner dia. 40 mm (shop made) or suitable hosestrap.
Impeller (5)	pull off.
Mating ring (3)	pull off with pliers.

Cassette-type seal (4) press around circumference with screwdriver to remove from coolant pump (1).



Do not damage coolant pump (1), use clean cloth as base.

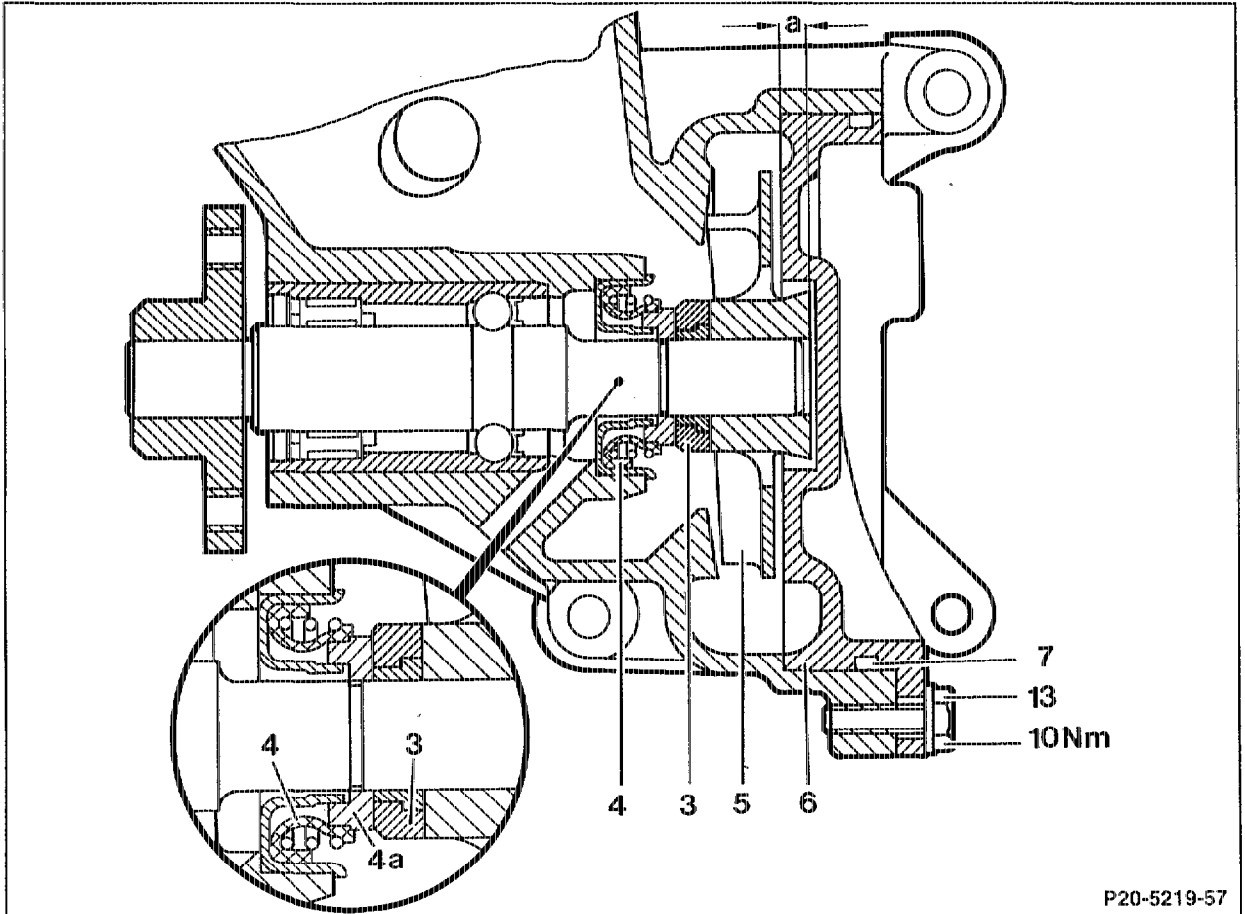

P20-5219-57

Mount for cassette-type seal (4) clean.

Note

Sealing compound is applied to the circumference of the cassette-type seal (4).

New cassette-type seal (4) press in with 40 mm diameter sleeve as far as the stop

Mating ring (3)	fit onto pump shaft with ground face toward seal (4a).
Impeller (5)	heat to approx. 100 °C.
Impeller (5)	press on.
Size (a) (5.6 – 5.8 mm)	note.
Tight seat of impeller (5) on pump shaft	check.

Special tool

