

18-3320 Testing oil level sensor

Operation no. of operation texts and work units or standard texts and flat rates:

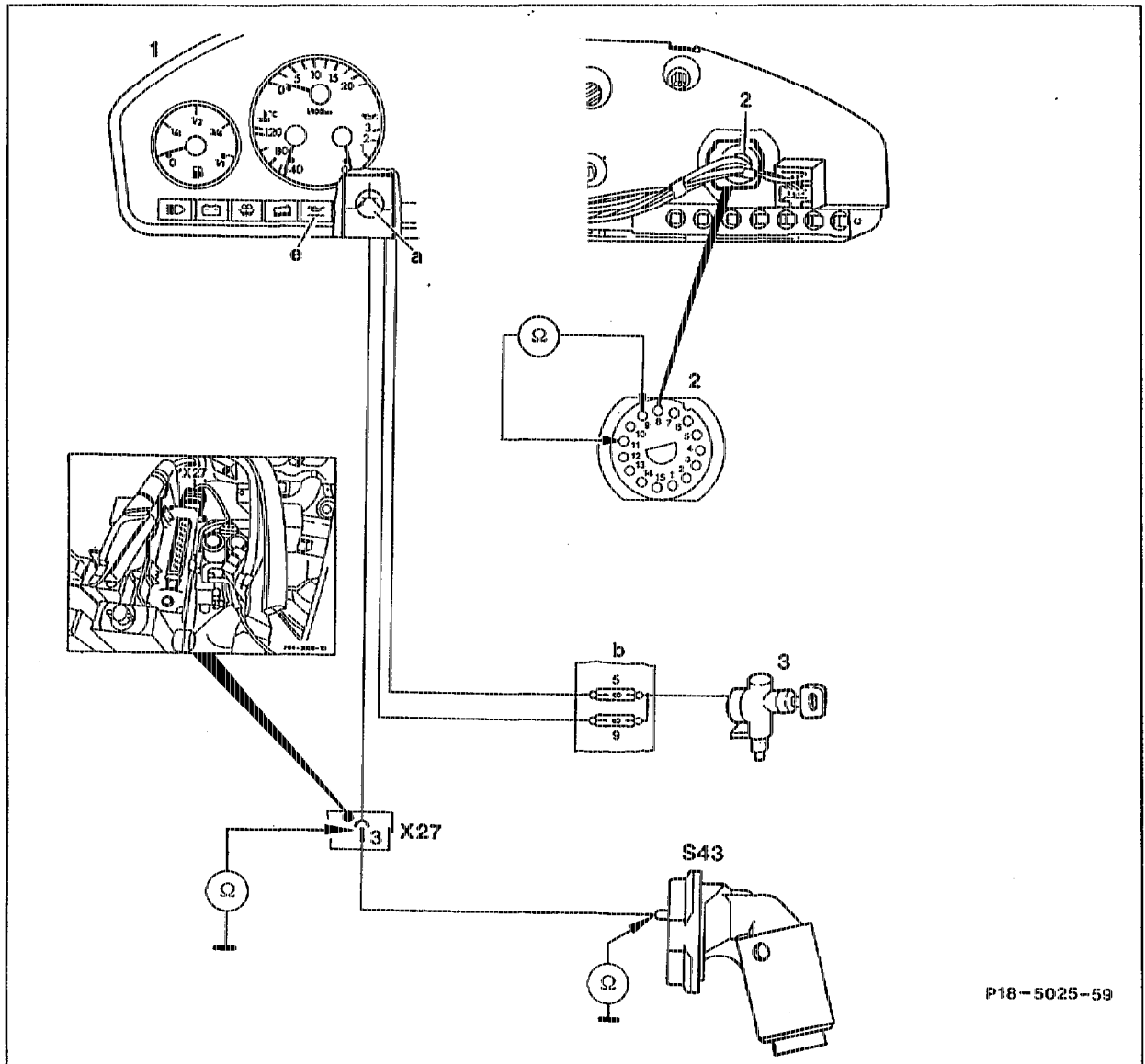

P18-5025-59

Shown on model 129

- | | |
|---|---|
| <p>1 Instrument panel unit
 2 Connector 2, instrument panel unit
 3 Ignition lock</p> | <p>a Microprocessor
 b Fuses 5 and 9
 e Oil level indicator lamp
 S43 Oil level sensor
 X27 Connector, starter wiring harness connector</p> |
|---|---|

If the following problems exist:

- A: Key in position "2" indicator lamp (e) does not come on.
B: Engine oil level "max" and engine running indicator lamp (e) comes on and remains on.
C: Engine oil level "max" and engine running indicator lamp (e) comes on intermittently.

Test data

Resistance of oil level sensor at "max" oil level	< 0.10 Ω
Resistance of oil level sensor at "min" oil level	∞ Ω

Test conditions

Engine oil temperature	> 60 °C
Battery voltage	12 V

Special tool

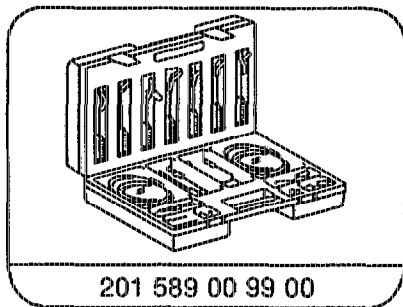

Commercially available tools and testers

Designation	e. g. make, order no.
Multimeter	e. g. Sun DMM-5

Test in the case of problem "A"

Indicator lamp (e) does not come on when key in position "2" (requirement: voltage supply exists at instrument cluster).

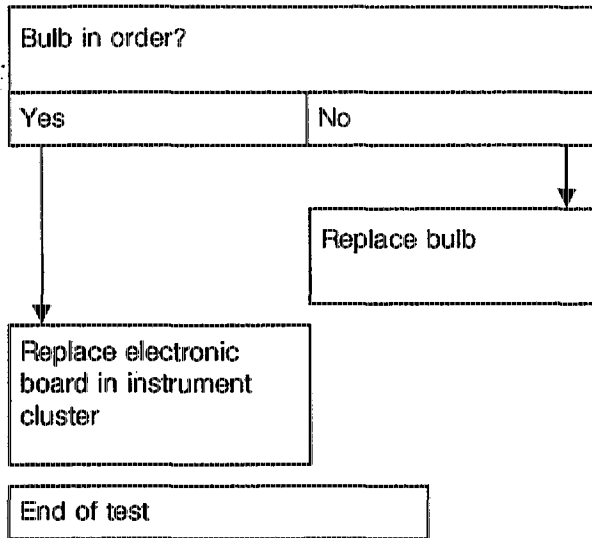

Test in the case of problem "B"

When engine oil at "max" level and engine running, indicator lamp (e) comes on and remains on.

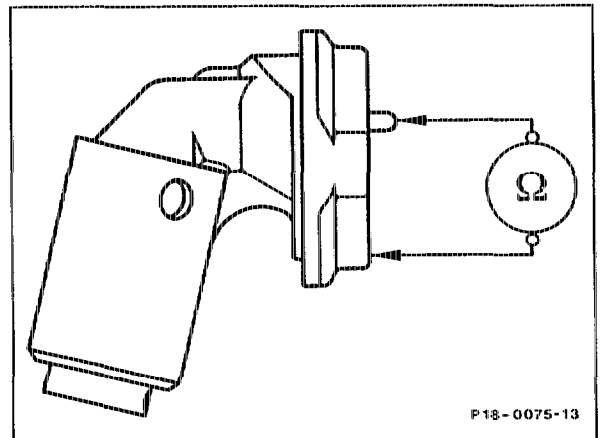
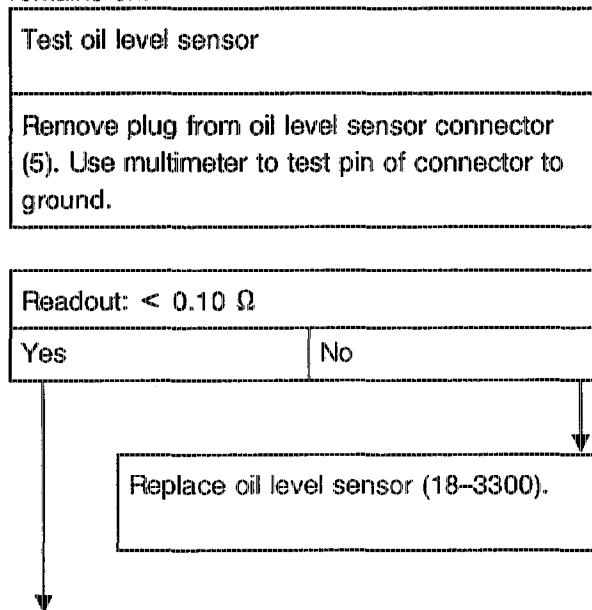

Insert plug of oil level sensor, test cable with oil level sensor to instrument cluster. Remove instrument cluster for this step. Disconnect plug (2) and use multimeter to measure resistance between contact 9 (oil level sensor wiring harness) and contact 11 (W1 main ground behind instrument cluster).

Readout: $< 1 \Omega$

Yes

No

Use multimeter to test pin of connector (X27) to ground.

Readout: $< 1 \Omega$

Yes

No

Wiring harness to instrument cluster has open circuit.

Starter wiring harness has open circuit.

Replace electronic board in instrument cluster.

End of test

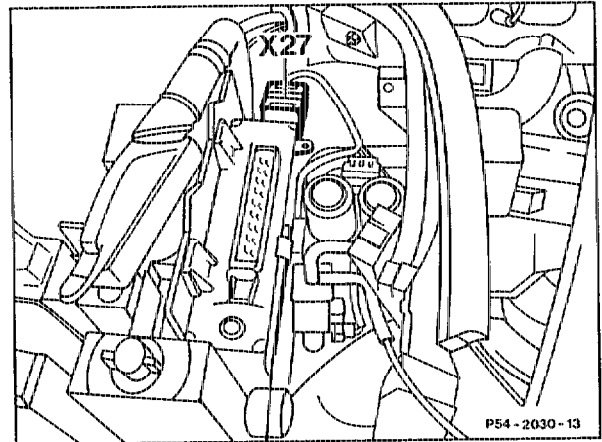
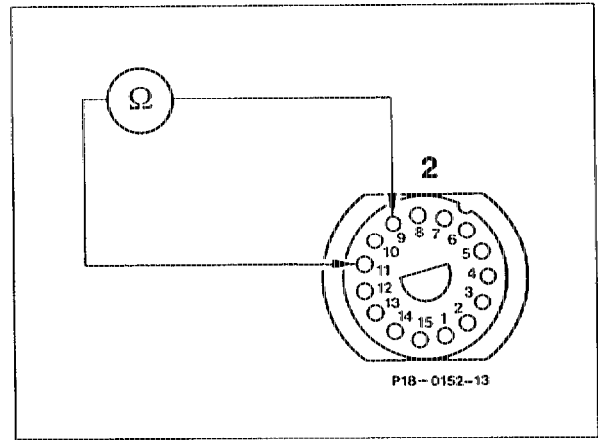

Test in the case of problem "C"

Indicator lamp (e) comes on intermittently when engine running and oil at correct level.

