

07.1-1826 Testing and setting vacuum control valve

Preceding work:

Operation no. of operation texts and work units or standard texts
and flat rates: 07-1826

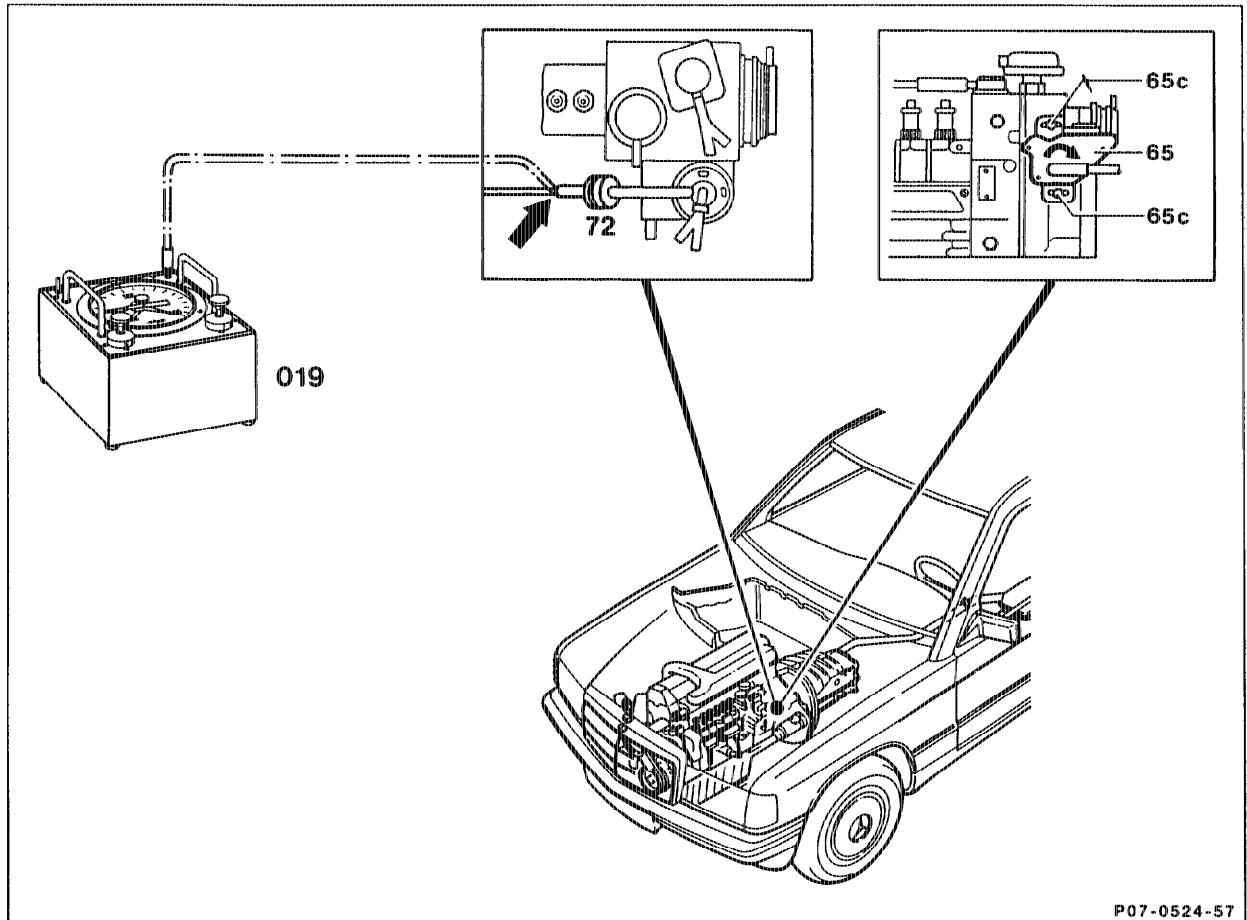

P07-0524-57

Test conditions:

Run engine up to normal operating temperature
(approx. 80 °C coolant temperature).

Accelerator control correctly set (30-300).

Testing vacuum control valve	connect vacuum tester (019) to damper (72) of vacuum line and read off vacuum at idling speed. Specification: Engine 602, 420 ± 25 mbar Engine 603, 385 ± 25 mbar
Setting vacuum control valve	When engine is switched off, move accelerator control to full-load stop. Specification: 0 mbar, it may be necessary to set vacuum control valve. Test vacuum lines, test vacuum pump, renew vacuum control valve. slacken fastening bolts (65c), run at full throttle until control lever of injection pump is resting against full-load stop. Turn vacuum control valve (65) in direction of arrow until a resistance is felt. Tighten vacuum control valve in this position.
Vacuum control valve	replace (27-140).

Special tool

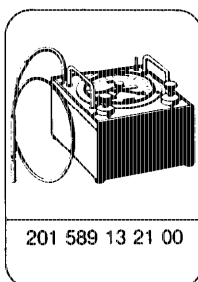

Engines 602.962, 603.960/963/971

Vacuum control valve modified, seal integrated.

Production breakpoint: as of November 1993

Model	Engine	Engine end no. Automatic transmission
124.128/188	602.962	019269
124.133/193	603.960	049904
124.333/393	603.963	004244
140.134	603.971	008156

Engines 602.962, 603.960/963/971

Vacuum control valve modified, restrictor integrated in vacuum control valve.

Production breakpoint: as of June 1994

Model	Engine	Engine end no. Manual transmission	Engine end no. Automatic transmission
124.128/188	602.962	032105	020045
124.133/193	603.960	-	052278
124.333/393	603.963	-	004444
140.134	603.971	-	012107

