

07.1-5701 Testing Fuel Pump for Delivery

Preceding work:

Operation no. of operation texts and work units or standard texts and flat rates: 07-5701

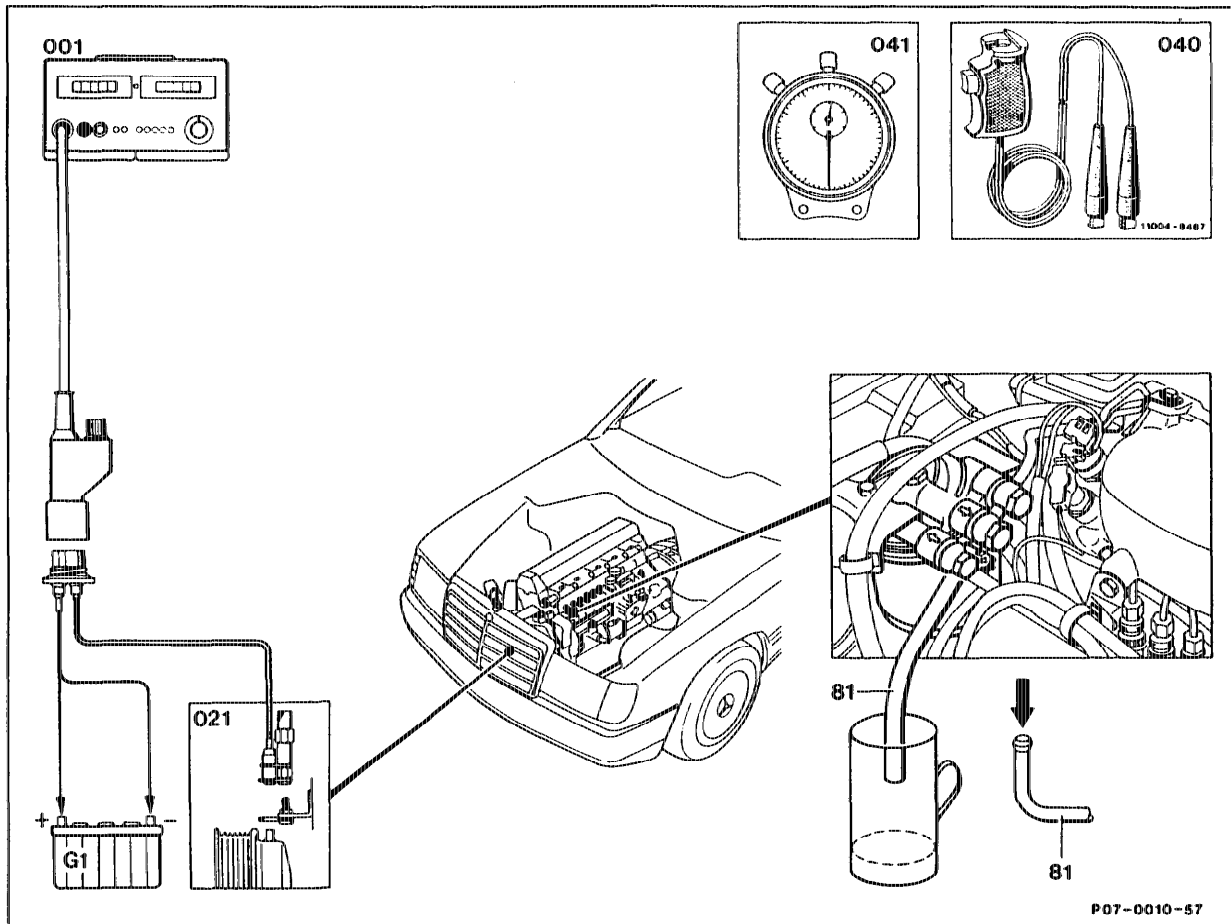

- | | |
|--------------------------|--|
| Testers (001, 021) | connect. |
| Return line (81) | disconnect and hold in measuring beaker (approx. 1 l). |
| | Note |
| | The return line to the fuel tank must be sealed. |
| Glow start switch | move into position "0", the injection pump is in the zero delivery position. |

Contact handle (040) connect to terminal 30 and terminal 50 and start engine for 30 seconds. Use stopwatch (041). Specification: Delivery at least 150 cm³/30 seconds at 150 rpm. If the specification is not achieved, test fuel pressure (07.1-5702).

Test data

Engine	602, 603
Delivery at at least 150 rpm	at least 150 cm ³ /30 s
Test condition	Glow start switch in position "0"

Special tools

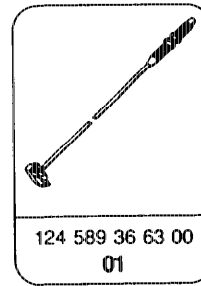
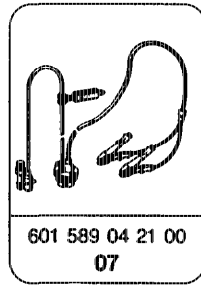
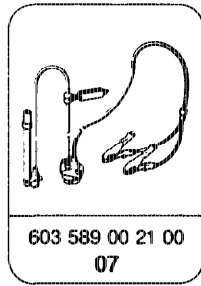
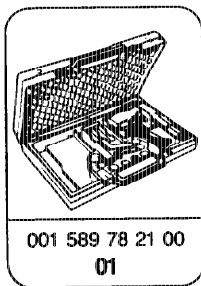

Commercially available tools

Digital tester	e. g. Bosch, MOT 001.03
Measuring glass or measuring beaker (at least 1 liter)	
Stopwatch	

Testing

1 Connect digital tester (001) as shown in connection diagram.

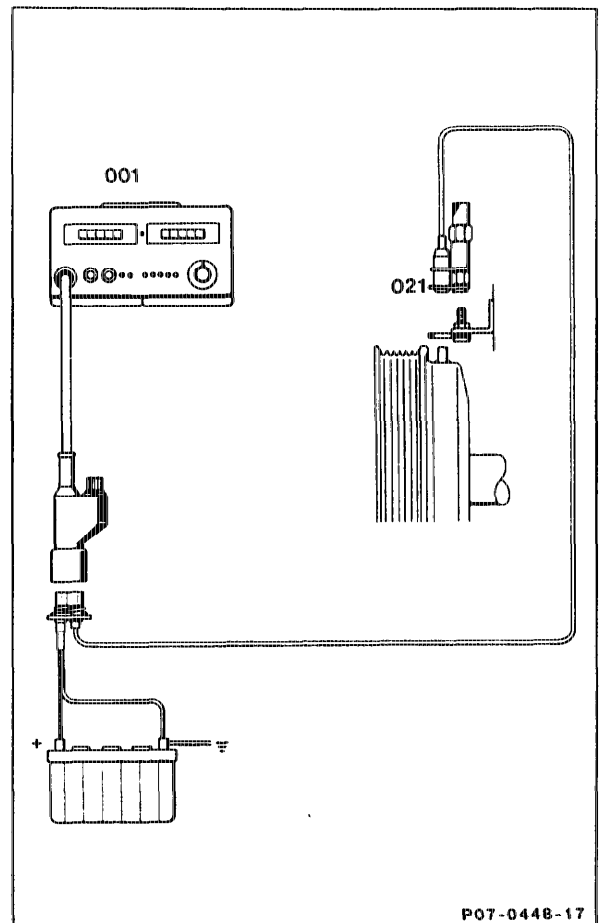

001 Digital tester
021 TDC pulse generator

2 Disconnect return line (E) and hold in measuring beaker.

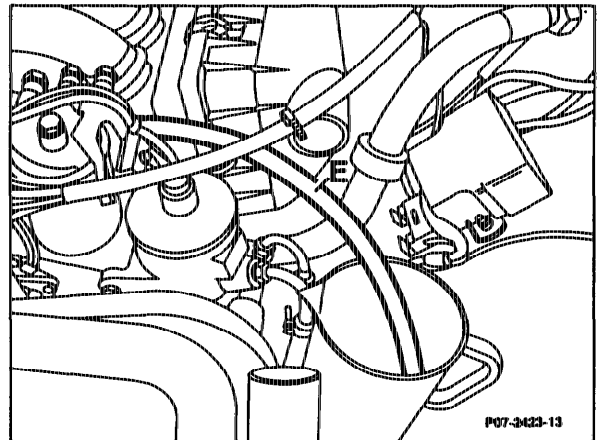

3 Turn glow start switch into position "0", the injection pump is in the "zero" delivery position when performing this step.

4 On model 124 and model 201, unplug coupling (X27) and connect adapter cable to terminal 50.

Model 124

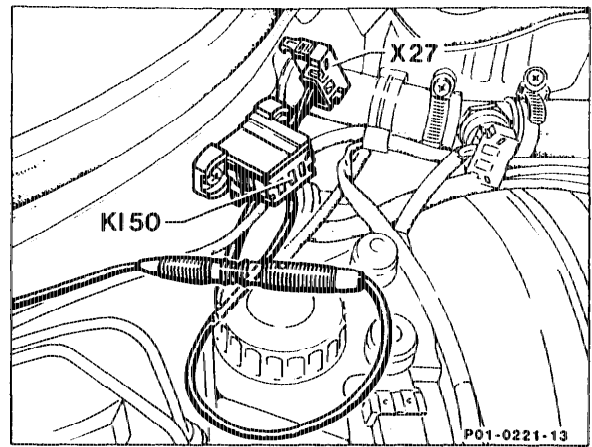

Model 201

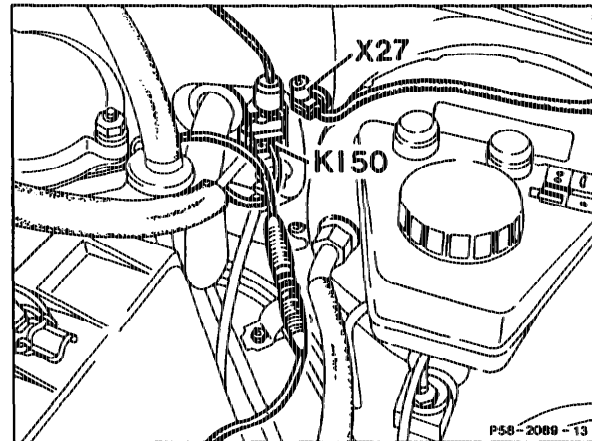

Model 126

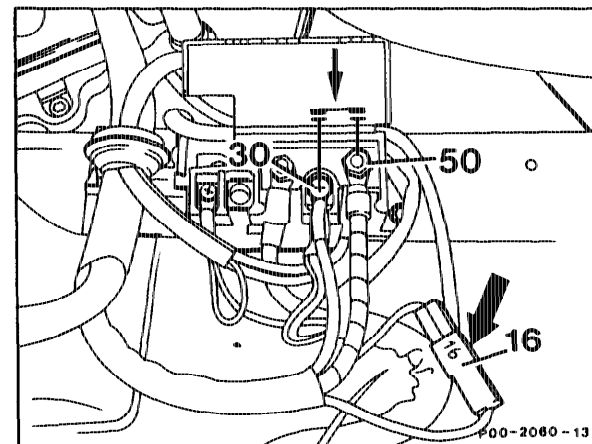

5 Connect contact handle to adapter cable or to terminal 50 (KI 50) and to terminal 30 (KI 30) and start engine for 30 seconds. Use stopwatch. (Starting voltage at least 10 V)

Delivery: at least 150 cm³/30 seconds at 150 rpm.

If the specification is not achieved, test fuel pressure (07.1-5702).