

05-437 Removal and installation of pressure oil pump drive

Preceding work:
Boost air pipe removed (turbo engines).

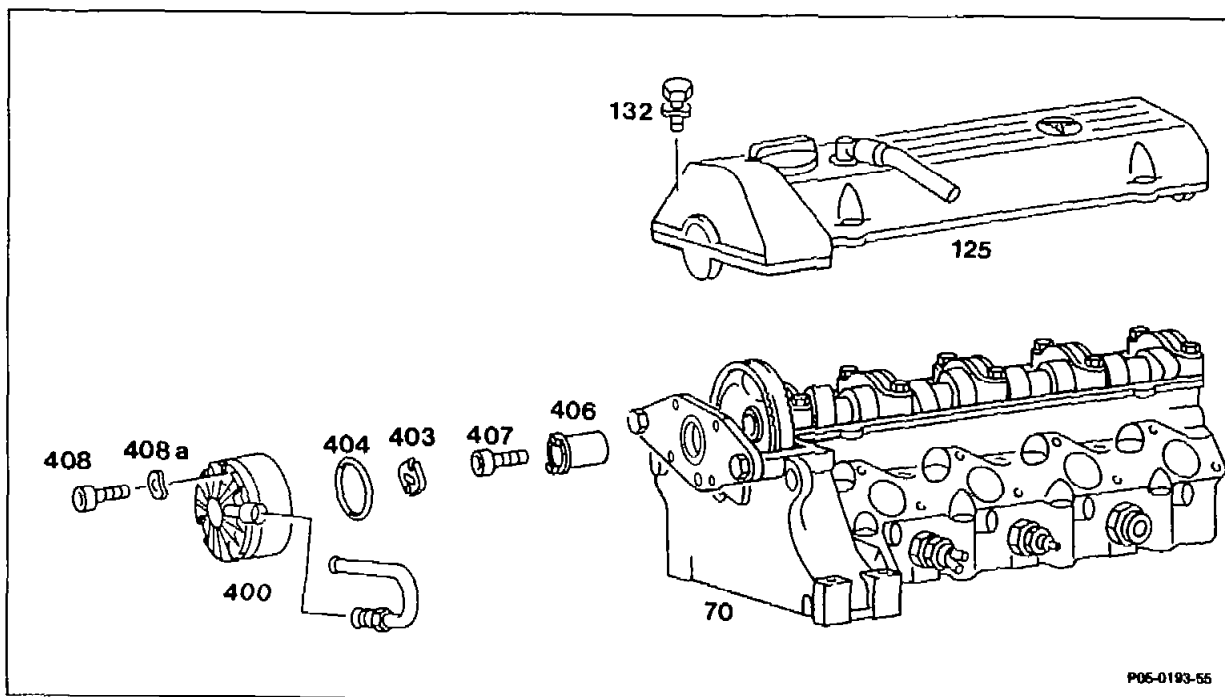

Cylinder head cover (125)	remove, install, fastening bolt (132), 10 Nm.
Pressure oil pump (400)	unscrew, screw on, fastening bolt (408) with washers (408a), 11 Nm, put pressure oil pump to one side with lines connected.
O-ring (404)	replace.
Carrier (403)	remove, install, check.
Bolt (407)	unscrew, screw on. Note different bolt (05-220). Tightening torque and tightening angle Hexagon bolt 25 Nm, Bihexagonal necked down bolt 25 Nm, 90°.
Carrier sleeve (406)	remove, install. Use grease when installing. Note different design (05-220).

Note

Since 11/88 the camshaft timing gear has been fitted with a 12-point necked down bolt M11 (previously hexagon bolt M10). The carrier has been modified as a result of this change.

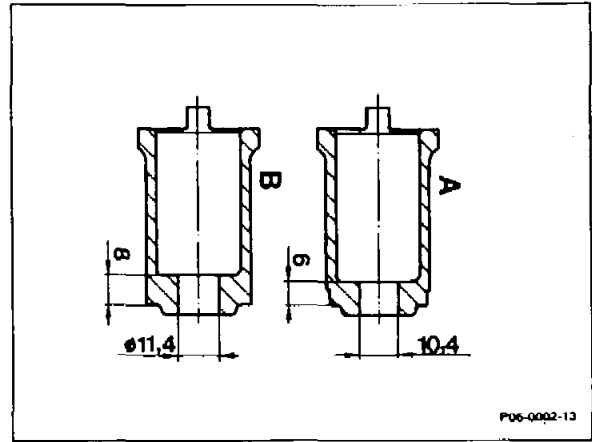

- A Previous version
- B Revised version

Special tool

