

C7

AR30.20-P-1262EA





Removing and installing electronic accelerator with throttle valve body

17.3.95

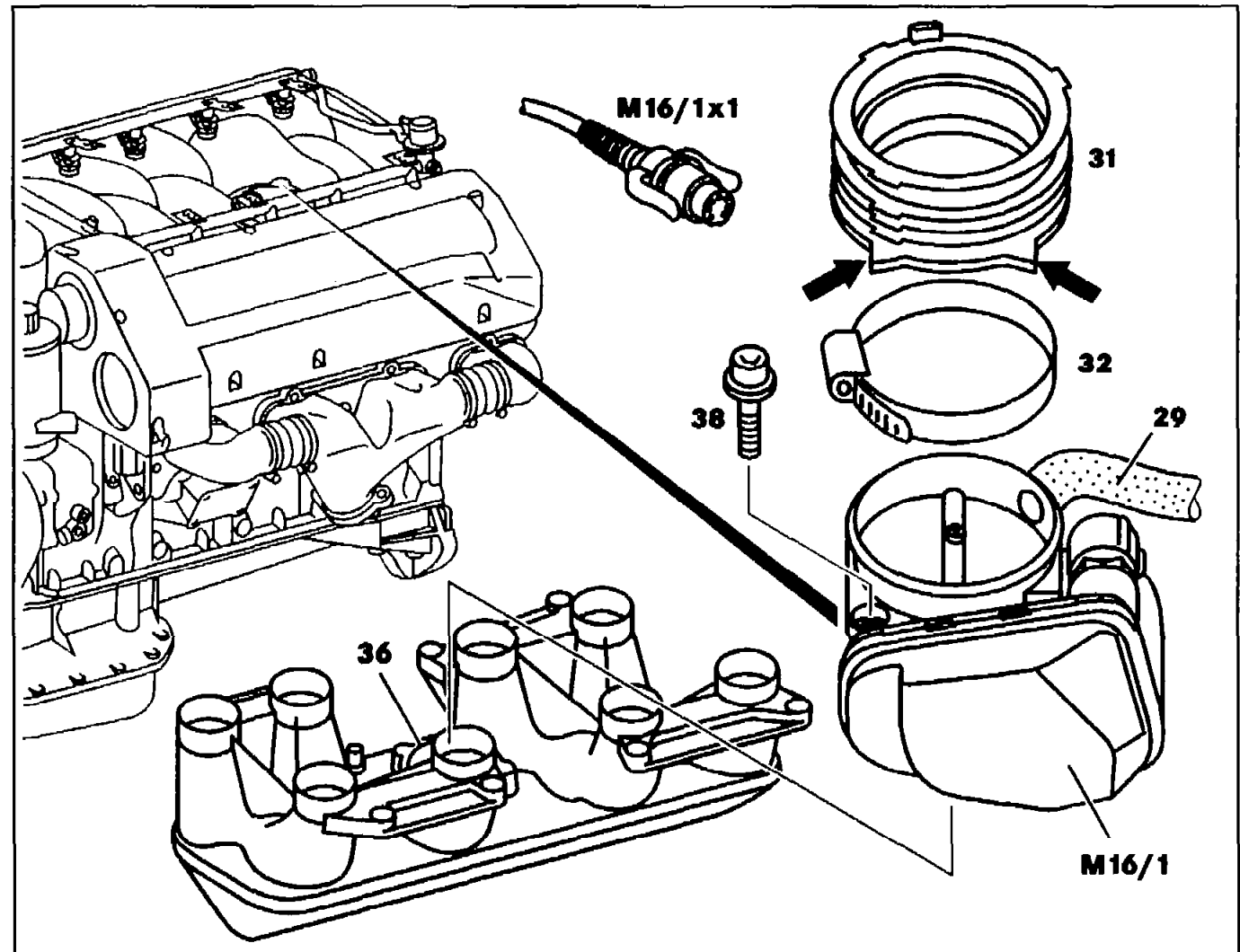
ENGINE 119.981/982/985

- 31 Connecting hose
- 32 Hose clip
- 36 Gasket
- 38 Bolts
- M16/1 Electronic accelerator actuator
- M16/1x1 Electronic accelerator actuator connector



	Removal, installation		
1	Remove hot film mass air flow sensor, install		AR07.07-P-1453E
2	Slacken hose clip (32) and take off connecting hose (31)	 Pay attention to installation position (arrows)	WH58.30-Z-1002-06A
3	Unplug actuator connector (M16/1x1)	Fold locking bar up for this step	
4	Take off vent hose (29)		
5	Unscrew bolts (38)	 Replace micro-encapsulated bolts 	BA30.20-P-1001-01A
6	Take off electronic accelerator actuator (M16/1)		
7	Examine gasket (36), replace if necessary		
8	Install in the reverse order		

 **Electronic accelerator actuator**

Number	Designation	Engines 119, 120
BA30.20-P-1001-01A	Bolt, electronic accelerator to intake pipe	Nm 25

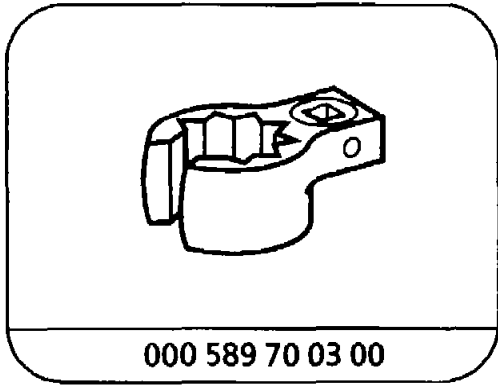

Box wrench socket

Commercially available tools (see Workshop Equipment Manual)

Number	Designation	Make (e.g.)	Order number
WH58.30-Z-1002-06A	7 mm wrench hexagon on flexible shaft for hose clips with worm drive	Hazet Güldenwerther Bahnhofstraße 25-28 D-42857 Remscheid	426-7