

05-3200 Replacing and riveting timing chain

Preceding work:
Spark plugs removed (AP15.00-1580CA)

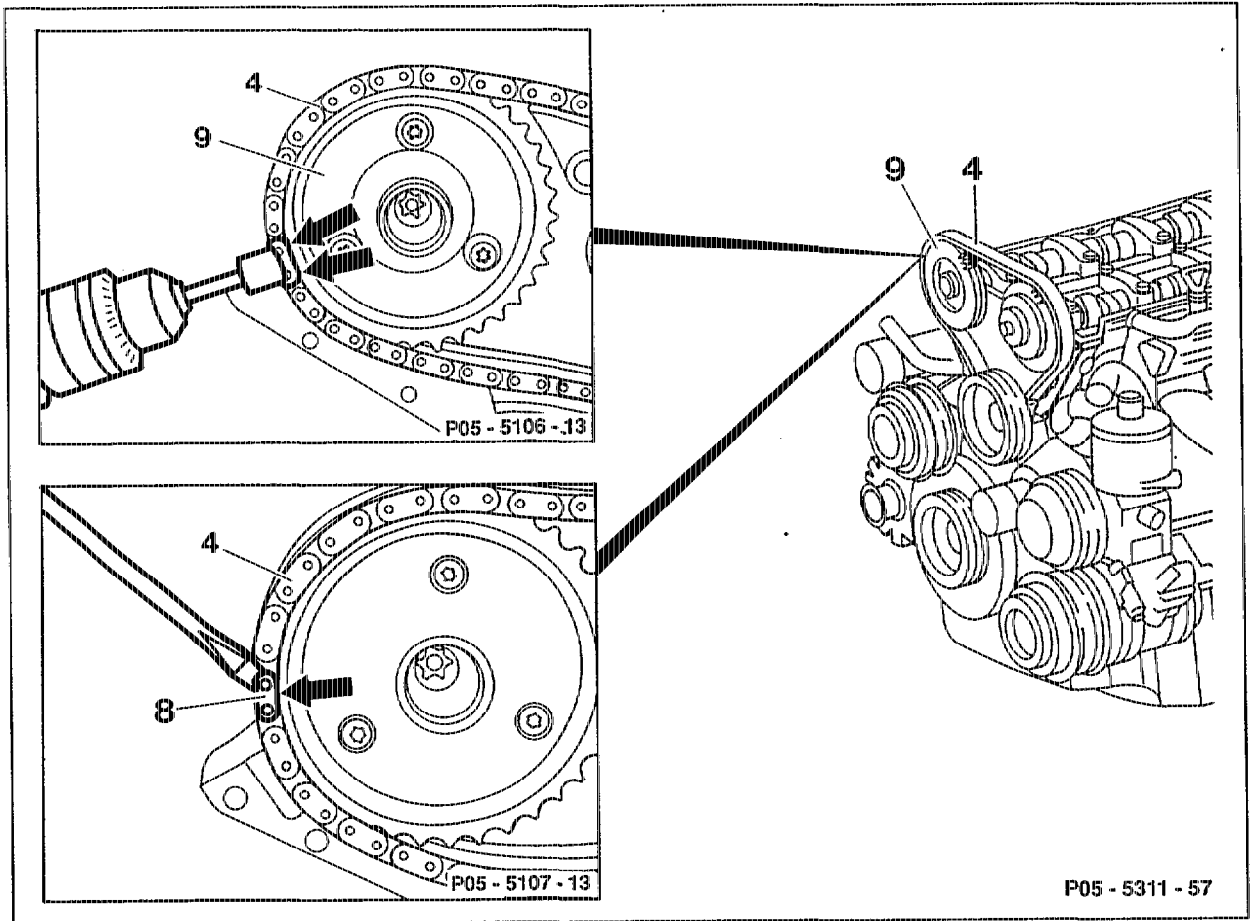

Chain tensioner	remove (05-3100).
Engines with HT distributor:	remove front cover and topguide rail (01-2120).
Engines without HT distributor:	remove top guide rail (05-3400).
Chain box	cover over with a clean cloth.
Chain pin (arrows) of timing chain (4) at exhaust camshaft sprocket (9)	grind open (arrows), separate with chain separating tool 602 589 02 33 00 and thrust spindle 602 589 04 63 00 (\varnothing 2.9 mm).
Plate (8) of timing chain (4)	prise off with screwdriver.
Ground-open double link	press out.

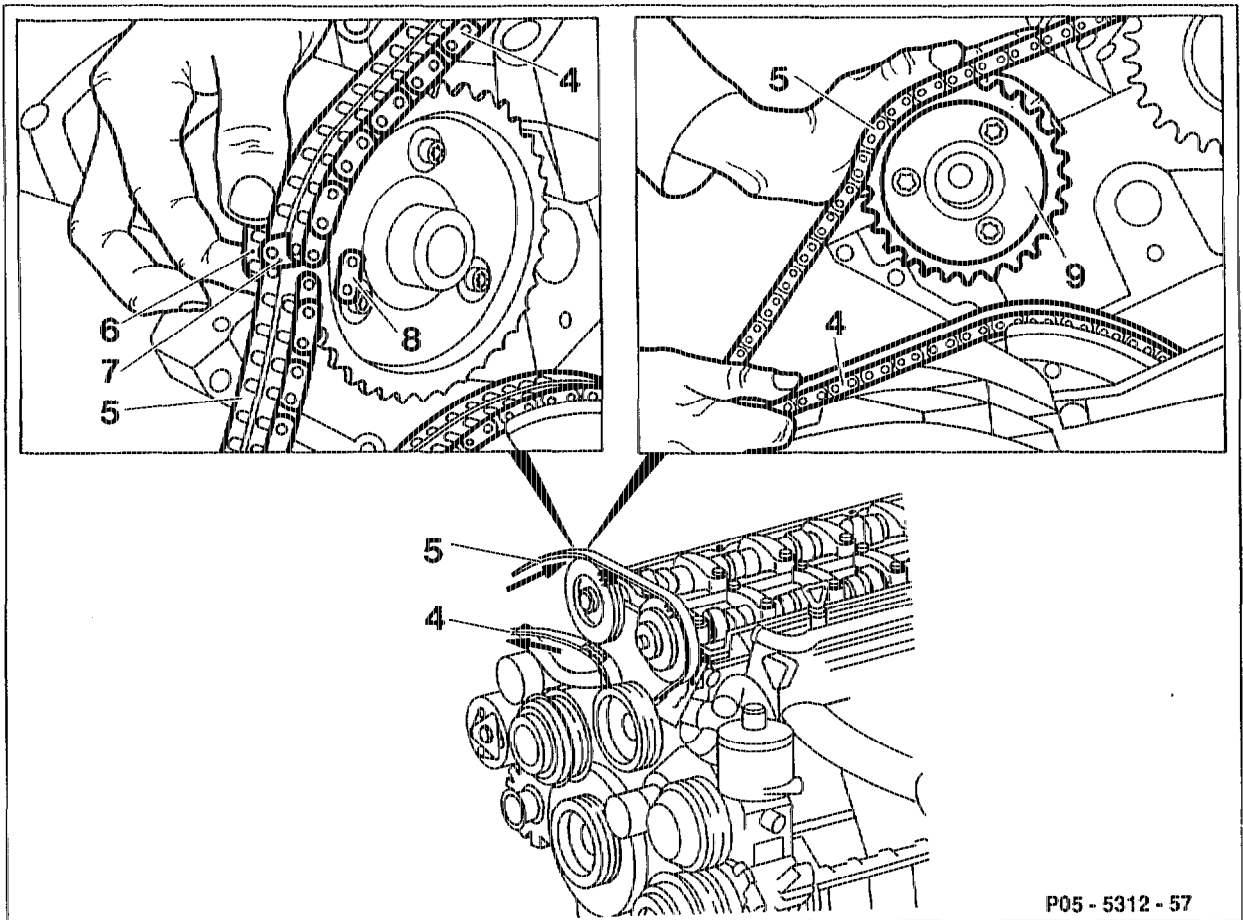

P05 - 5312 - 57

- | | | | | | |
|--|---|--------------------|-----------|------------------|-----------|
| <p>New timing chain (5)</p> <p>Crankshaft</p> | <p>connect to old timing chain (4) with riveted link (6) and centre plate (7) (thickness 1.6 mm) and ground-open outer plate (8).</p> <p>rotate with wrench socket insert in direction of rotation of engine.</p> <p>Pay attention to different lengths of timing chains:</p> <table border="0"> <tr> <td>Engine 104.980/981</td> <td>130 links</td> </tr> <tr> <td>Engine 104.94/99</td> <td>126 links</td> </tr> </table> | Engine 104.980/981 | 130 links | Engine 104.94/99 | 126 links |
| Engine 104.980/981 | 130 links | | | | |
| Engine 104.94/99 | 126 links | | | | |
| <p>New separated timing chain (5)</p> <p>Timing chain</p> | <p>pull in.</p> <p>hold meshed at exhaust camshaft sprocket (9) by hand when pulling in.</p> | | | | |
| <p>Bottom free end (4) of timing chain</p> <p>Crankshaft</p> | <p>pull out of chain box.</p> <p>rotate sufficiently until the end of the new timing chain can be connected with the riveted link.</p> | | | | |

New timing chain (5)

connect to inserted link (6) and centre plate (7).

Note

Riveted links of the IWIS version part no. 000 997 22 98 should be matched to the IWIS timing chain and riveted links of the Renold version should be matched to the Renold timing chain. The identifications are stamped in each case on the outer plates of the timing chain.

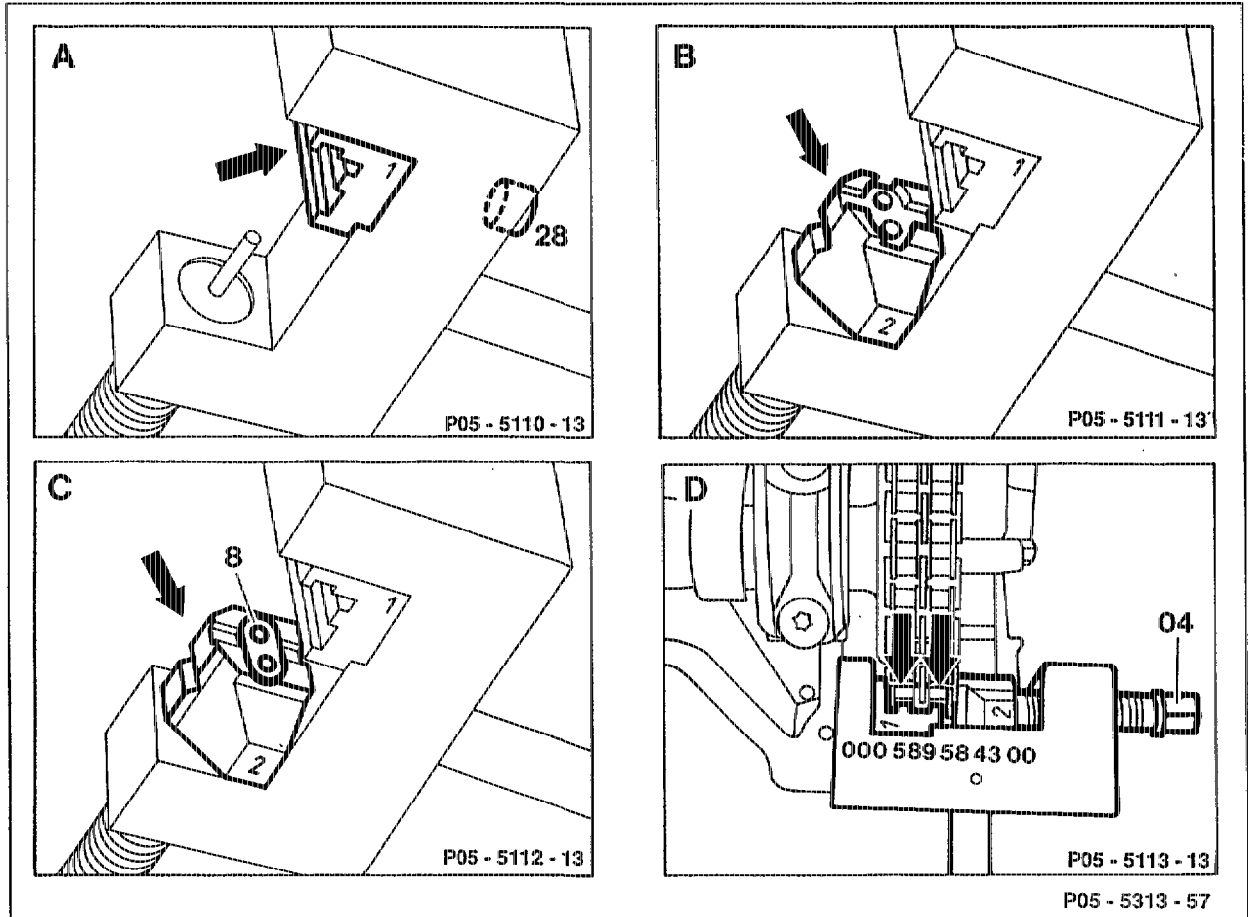

Jaw for duplex roller chain with digit 1

insert into pressing-on tool and screw on with screw (28) (Fig. A).

Moving thrust piece for simplex roller chain with the digit 2

insert into pressing-on tool (Fig. B).

Outer plate (8) of 1.2 mm thickness
 Webs (arrows)
 Spindle (04)
 Pressing-on tool

insert into moving thrust piece (Fig. C).
 fit onto rollers at riveted link (Fig. D).
 screw in until tight resistance felt (Fig. D).
 When screwing in, ensure that the pins of the
 riveted link are inserted into the holes of the
 outer plate (8).
 take off.

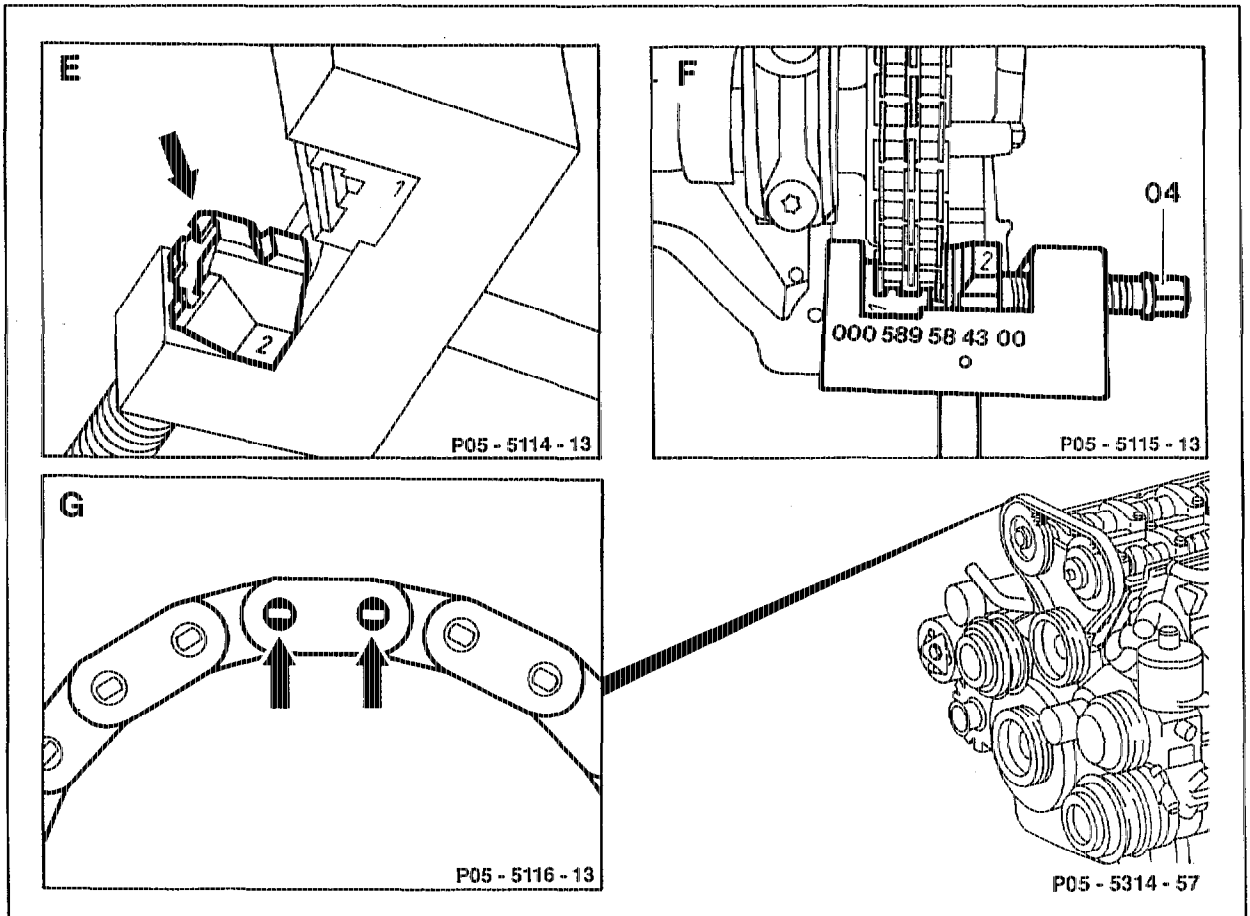

Moving thrust piece with the digit 2
 Pressing-on tool
 Spindle (04) to 30 Nm
 Pins of inserted link (6)
 Riveting

turn over (riveting profile) (Fig. E).
 position exactly over middle of pin (Fig. F).
 tighten (Fig. F).
 rivet individually.
 inspect, re-rivet if necessary (Fig. G).

Basic position of camshafts	adjust (05-2240).
Front cover and top guide rail	install (01-2120).
Chain tensioner	install (05-3100).
Basic position of camshafts	check (05-2230).

Special tools

