

30-330 Removal and installation of accelerator pedal

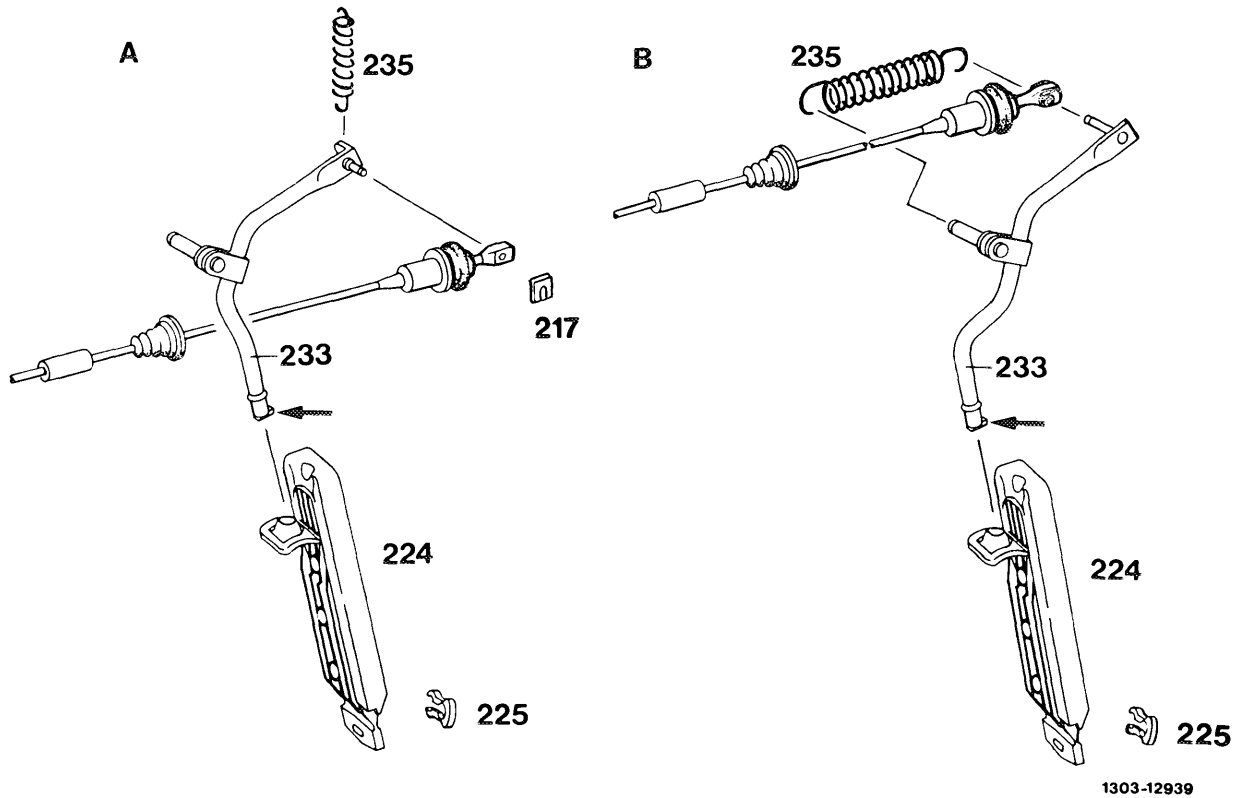

1303-12939

A Model 201

Expanding clip (225)	Compress behind accelerator pedal and remove.
Accelerator pedal (224)	Push down and turn through 180°, then pull down. When doing this, the lug (arrow) on accelerator lever (233) must be aligned with the slot in accelerator pedal.
Accelerator lever (233)	
Return spring (235)	

Note

The connection between accelerator lever and accelerator pedal is maintenance-free and does not require grease.