

30-315 Removal and installation of firewall bearing for accelerator lever

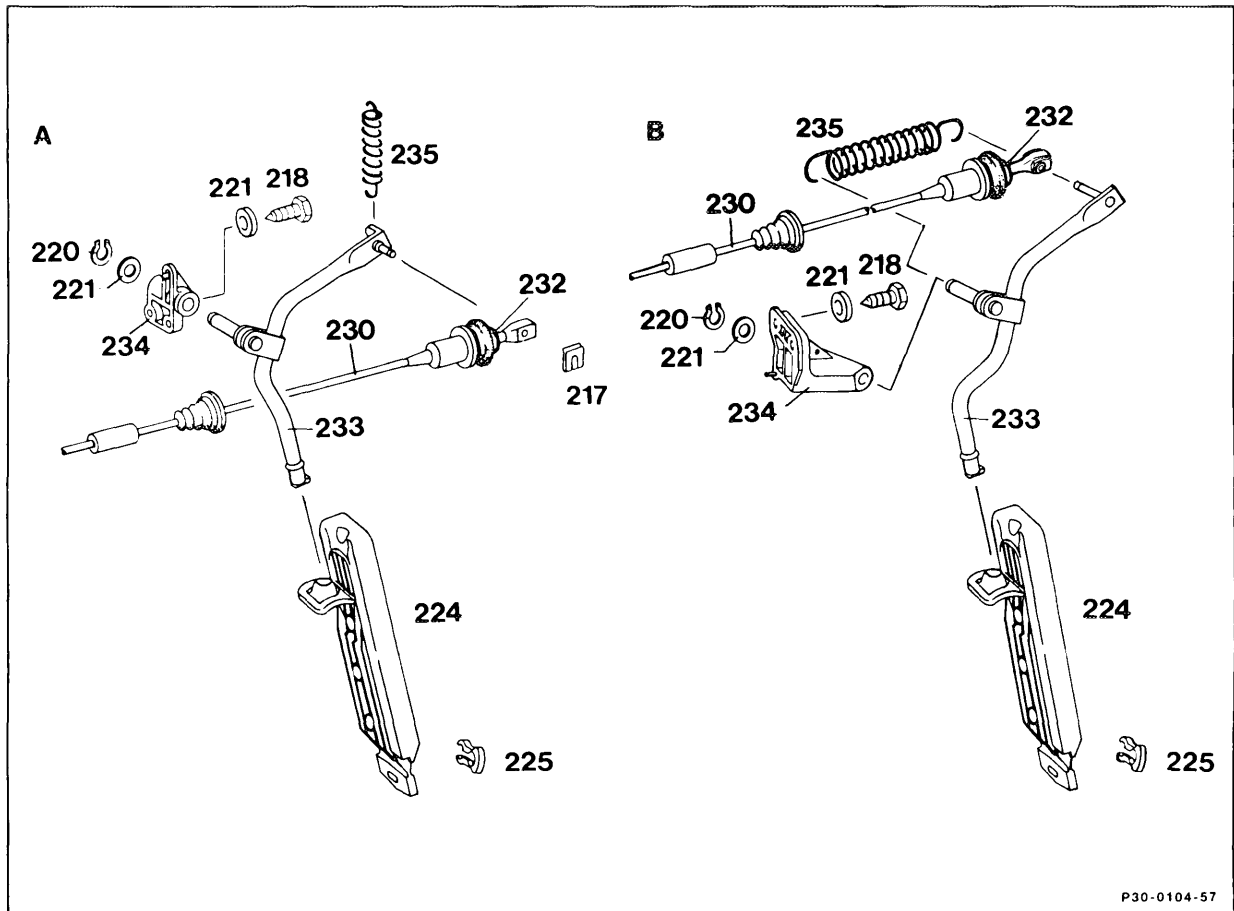

- A Model 201
B Model 124

Footwell cover	Remove, install.
Accelerator pedal (224)	Remove, install (30-330), remove, install expanding clips (225) for this purpose.
Return spring (235)	Detach, attach.
Locking plate (217)	(Model 201 only) remove – refit.
Bowden cable (230)	Detach, attach.
Adjusting nut (232)	
Firewall bearing (234) with accelerator lever (233)	Remove, install.

- Bolt (218)
- Washer (221)
- Locking ring (220) Detach from – fit on to accelerator lever.
Press accelerator lever out of firewall bearing,
press in again.
- Accelerator control Check, adjust if necessary (30-300).

Removal, installation

- 1 Remove footwell cover.
- 2 Remove accelerator pedal (30-330).
- 3 Detach return spring (235).
- 4 Pull off locking plate (Model 201 only).

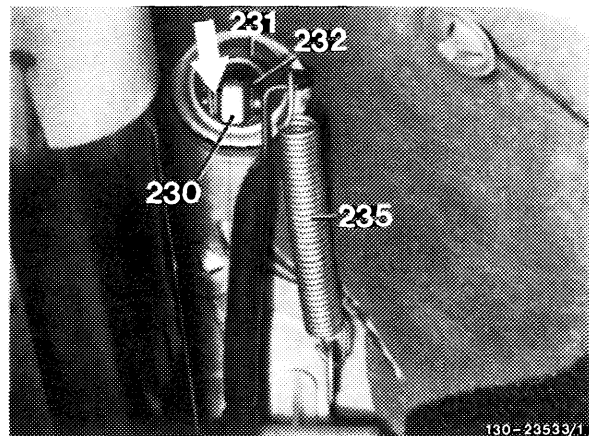

Model 201

- 6 Unbolt firewall bearing (234) and withdraw together with accelerator lever (233).
- 7 Remove firewall bearing (234) from accelerator lever (233). Remove locking ring (220) for this purpose.

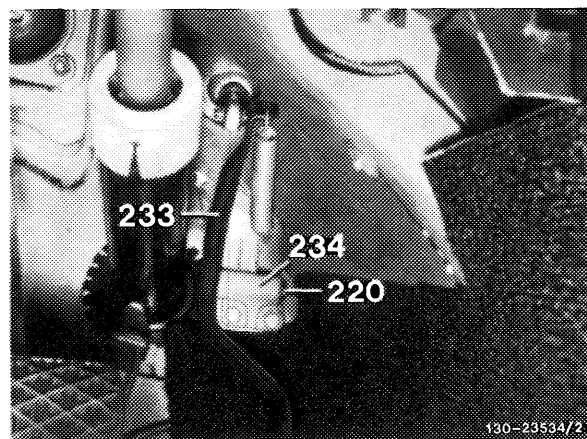

Installation note

Ensure that the stud (arrow) of the firewall bearing (234) fits into the hole on the firewall (241).

Check accelerator control linkage, adjust if necessary (30-300).

Model 201

