

22-240 Removal and installation of engine shock absorber

Preceding work:
Bottom engine compartment lining removed (01-006).

Engine 603.96/97 in Model 126

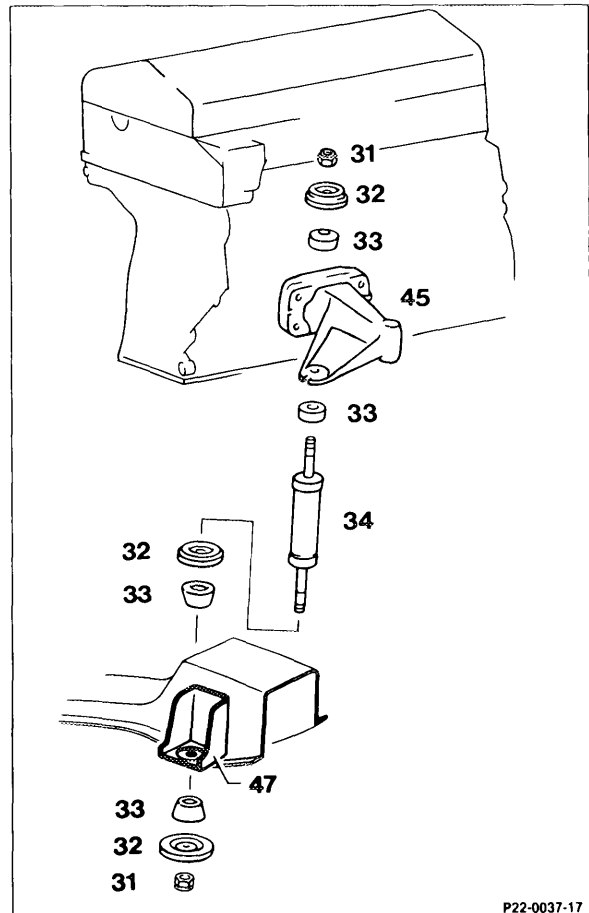

P22-0037-17

Model 126

Model 126

- | | |
|---------------------------|---|
| Hexagon nut (31) | of left and right shock absorber (34), unscrew at frame cross member and at engine supporting bracket, screw on, 10 Nm. |
| Shock absorber (34) | take off, install. |

Note

Check condition of shock absorbers and all attached parts; renew, if necessary.

Tightening torques

Nm

Hexagon nuts, shock absorber mounting

10

Hexagon bolts, shock absorber mount Model 201.128

10

Special tool