

14-180 Removal and installation of charge air pipe - Turbodiesel

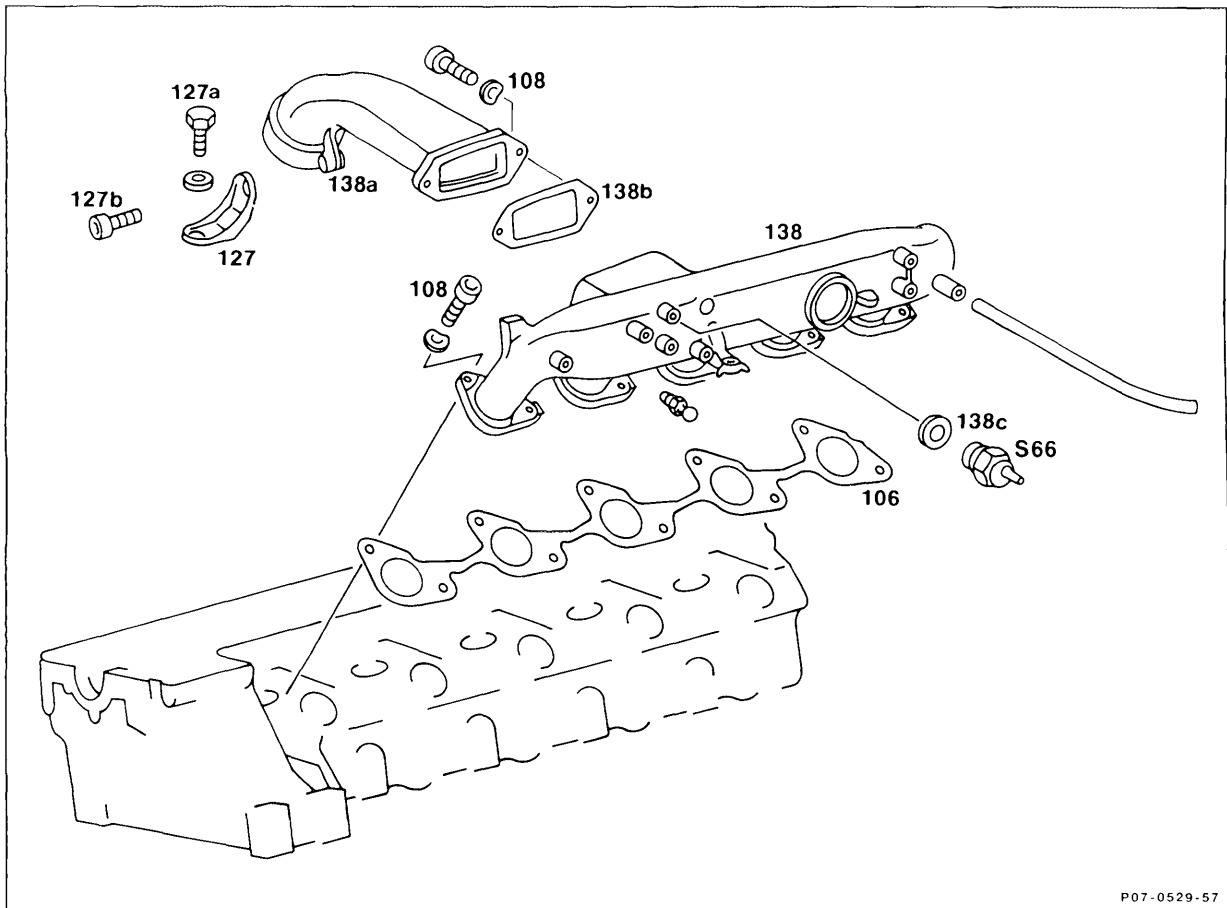

P07-0529-57

Pressure line (transparent) on charge air pipe . . .	disconnect, connect, loosen hose clamp.
Connector on pressure switch (S66)	disconnect, connect.
Pressure switch (S66)	remove, install, replace seal (138 c).
Bracket (127)	remove, install.
Screw-and-washer assemblies (108)	10 or 12 off, remove, install, torque 25 Nm.
Charge air connecting line (138a)	remove, put on, replace seal (138 b).
Charge air pipe (138)	remove, attach, replace gasket (106).