

07.1-241 Reconditioning injection timing device - Turbodiesel

Preceding work:

Removal and installation of timing device (07.1-240)

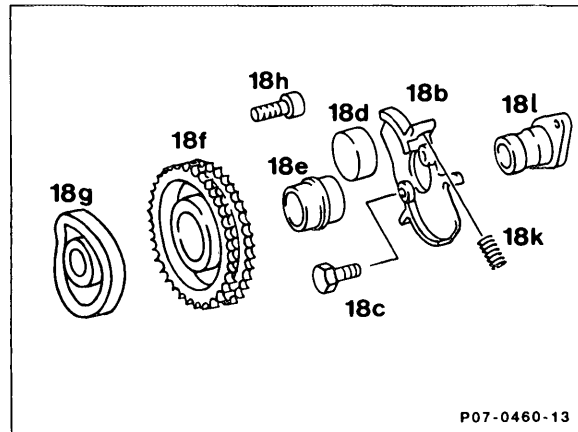

Bolt (18h)	M6 x 16, remove and install. Tightening torque 15 Nm.
Drive hub (18l)	remove, install.
Bolt (18c)	M8 x 16, remove and install. Tightening torque 25 Nm.
Cam (18g)	examine for signs of wear.
Sprocket wheel (18f)	examine for signs of wear.
Bush (18e)	remove, install, examine for signs of wear.
Segment flange (18e)	examine for signs of wear.
Compression spring (18k)	remove, install.
Flyweight (18d)	M8 x 16, remove, install, examine for signs of wear.