

07.1-200 Removal and installation of injection pump - Turbodiesel

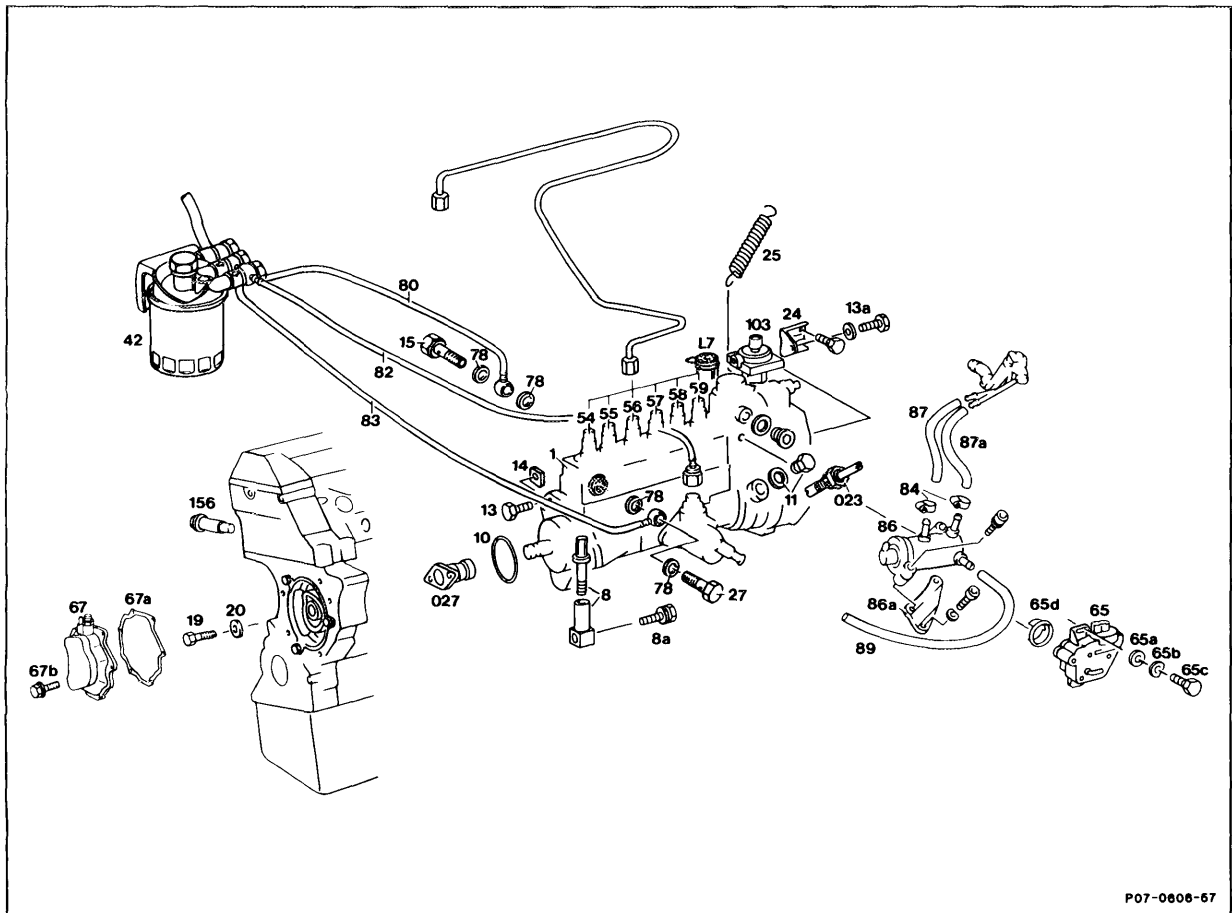

P07-0606-57

Bottom section of noise encapsulation	remove, fit (94-0050).
Belt tensioning device	remove, install (13-340).
Fan cowl and fan	remove, install (20-335).
Vacuum pump (67)	remove, install (43-610). Replace gasket (67).
Assembly sleeve (067)	install, remove, so that engine can be turned over easily. Special tool 601 589 05 14 00 (engines effective 09/89).
Radiator	remove, install (20-470). Model 201.128 only.
Actuator of cruise control	Remove, install (54-541), Engine 603 only.

Central fastening bolt (19) with washer (20) Unscrew, screw in, tightening torque 40–50 Nm.

Caution!

Left-hand thread

Crankshaft

in direction of rotation
turn to 15° ATDC of no. 1 cylinder.

Chain tensioner (156)

remove, install (05–310).
Special tool 001 589 65 09 00.

Injection lines (54–59) at injection pump

disconnect, connect.
Tightening torque 10–20 Nm.
Special tool 000 589 77 03 00.

Fuel lines (80, 82, 83)

disconnect, connect, replace seals.

Caution!

Do not mix up hollow bolt (27) and overflow orifice (15).

Fuel thermostat (86) and fuel line (89)

disconnect, connect.

Pressure lines at ALDA unit (103) and vacuum lines

disconnect, connect.

Electric cables

disconnect, connect at control rod travel sensor (L7) and at actuator (Y22).

Accelerator control linkage

detach, attach. Check setting (30–300).

Injection pump (1)

Remove bolt (13 and 13a), tightening torque 20–25 Nm. Withdraw injection pump to the rear; **hold timing device tight** when performing this step.

O-ring (10)

replace.

Start of delivery adjusting device(8)

remove, install; remove bolt (8a) for this step.

Spring (25)

detach, reattach.

- Screw plug (11) remove and turn removed injection pump with serrated wrench (027) until lug is visible in the governor housing hole. In this position, push in locking bolt (023) until it is felt to engage.
- Caution!**
Remove locking bolt (023) after installing injection pump and refit screw plug (11).
- Start of delivery check (07.1–112), set if necessary.
- Vacuum control valve (65) remove, install, set (07.1–170).

Special tools

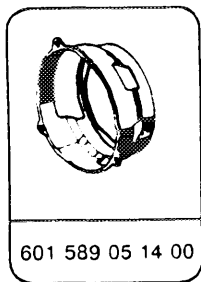
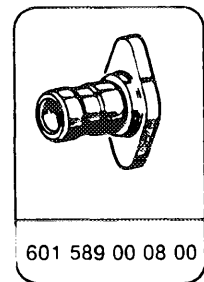
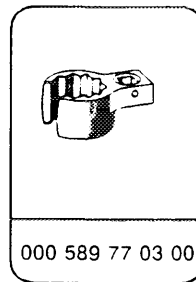
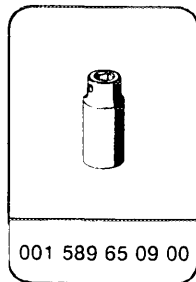
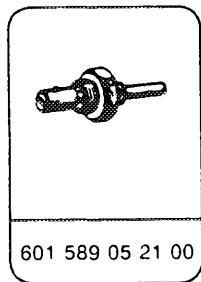
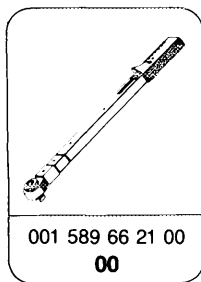

Removal and installation

1 Loosen central fastening bolt (19), unbolt while holding crankshaft tight.

Caution!

Left-hand thread

Mount assembly basket using bolts (67b), so that the engine can be cranked easily (on engines effective 09/89).

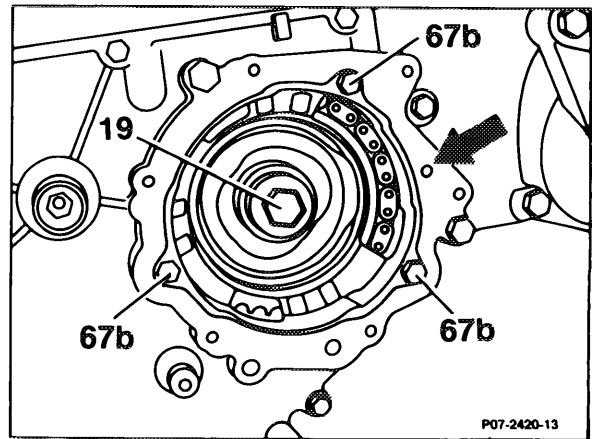

2 Turn crankshaft in direction of rotation to 15° ATDC of no.1 cylinder.

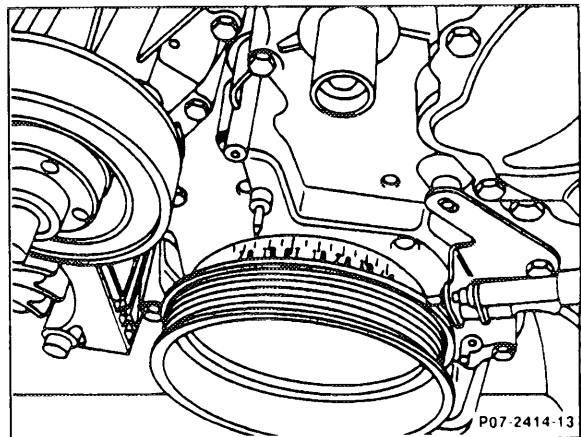

3 Remove chain tensioner (05-310).

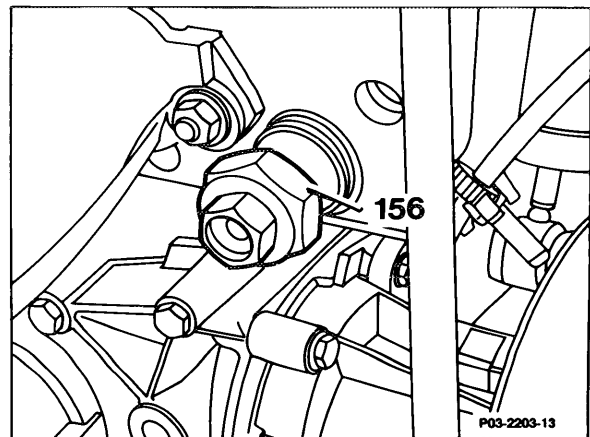

156 Wrench socket
Special tool 001 589 65 09 00

4 Detach injection and fuel lines at the injection pump.

Arrow Box wrench socket
Special tool 000 589 77 03 00
with 1/4" ratchet

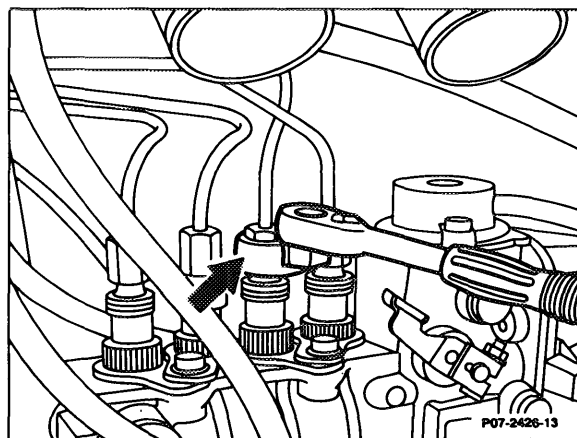

5 Disconnect vacuum lines at vacuum unit for stop unit and vacuum control valve. Detach 2-pin connector at actuator (Y22) of electronic idle speed control.

6 Disconnect electric cables at control rod travel sensor (L7) and at actuator (Y22).

7 Disconnect pressure line at ALDA unit.

8 Detach accelerator control linkage at control lever and spring.

9 Remove vacuum control valve.

10 Remove injection pump; remove fastening bolts (arrows) and bolt on mounting bracket for this step. Withdraw injection pump to the rear, holding timing device in place.

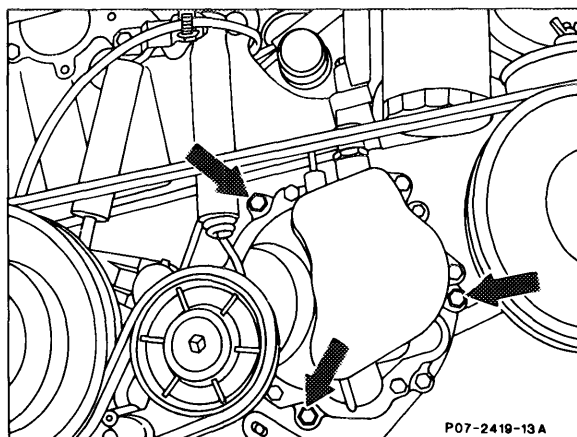

11 Remove fuel thermostat (86) complete; remove bolts (arrows) for this step.

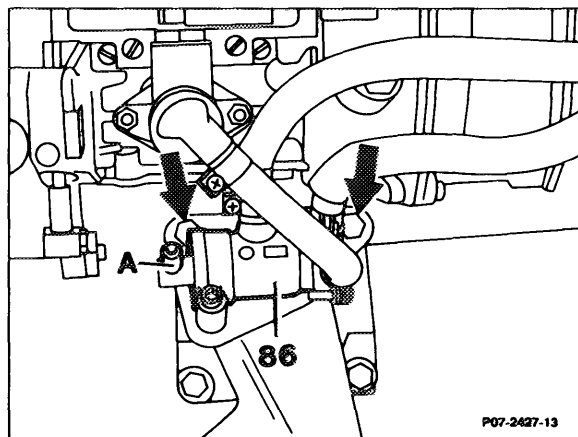

A Inlet from fuel tank

12 Check whether the engine is positioned at 15° ATDC of no.1 cylinder; adjust if necessary.

Caution!

Engine must only be cranked in direction of rotation!

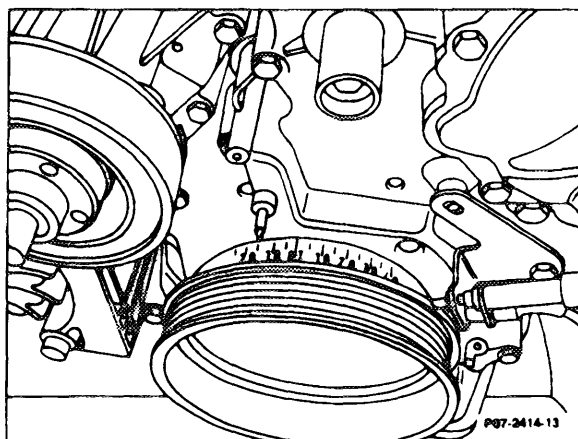

13 Unscrew plug (11).

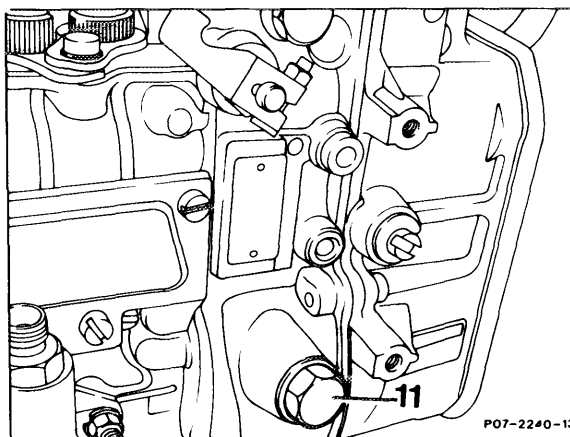

14 Use serrated wrench (027) to turn injection pump on the injection pump crankshaft until the lug of the governor is visible at the hole, i.e. push in locking bolt (023) in this position until it is felt to engage, and tighten by hand.

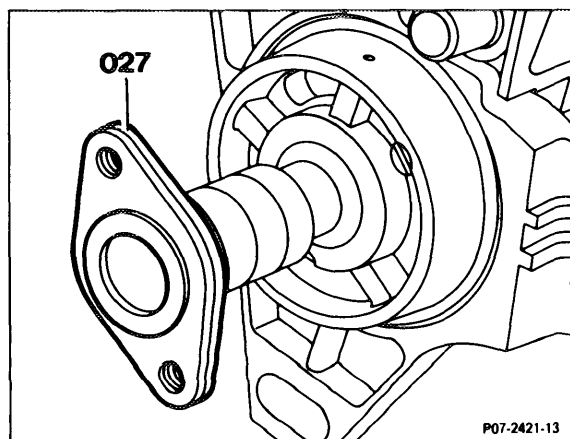

027 Serrated wrench
Special tool 601 589 00 08 00

Caution!

Remove locking bolt (023) after installing injection pump, otherwise the injection pump will be damaged when starting the engine.

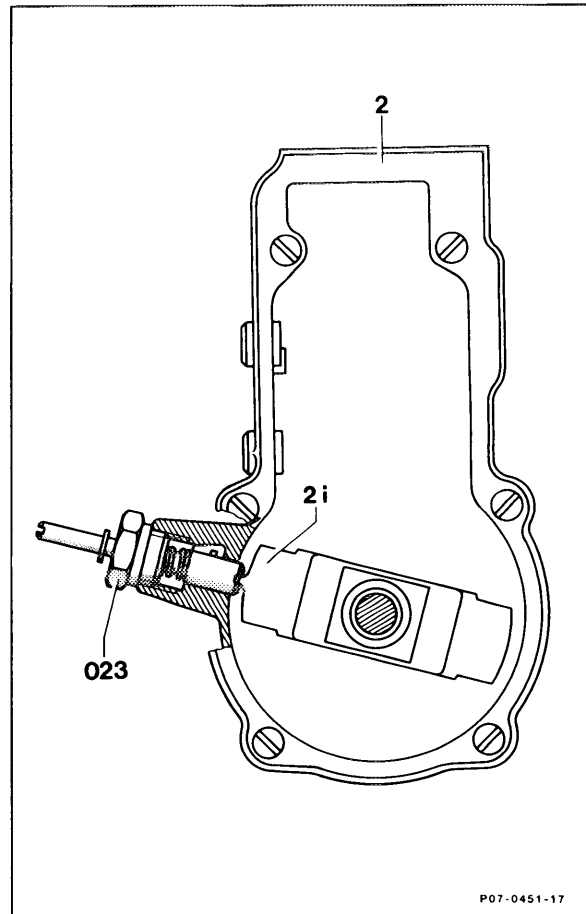

023 Locking bolt
Special tool 601 589 05 21 00

15 Install remaining parts on engine.

Note

When starting engine, the injection system is automatically bled.

16 Check start of delivery (07.1-112); set start injection if necessary (07.1-117).

17 Install vacuum control valve and set (07.1-170).