

07.1-170 Testing and setting vacuum control valve for automatic transmission - Turbodiesel

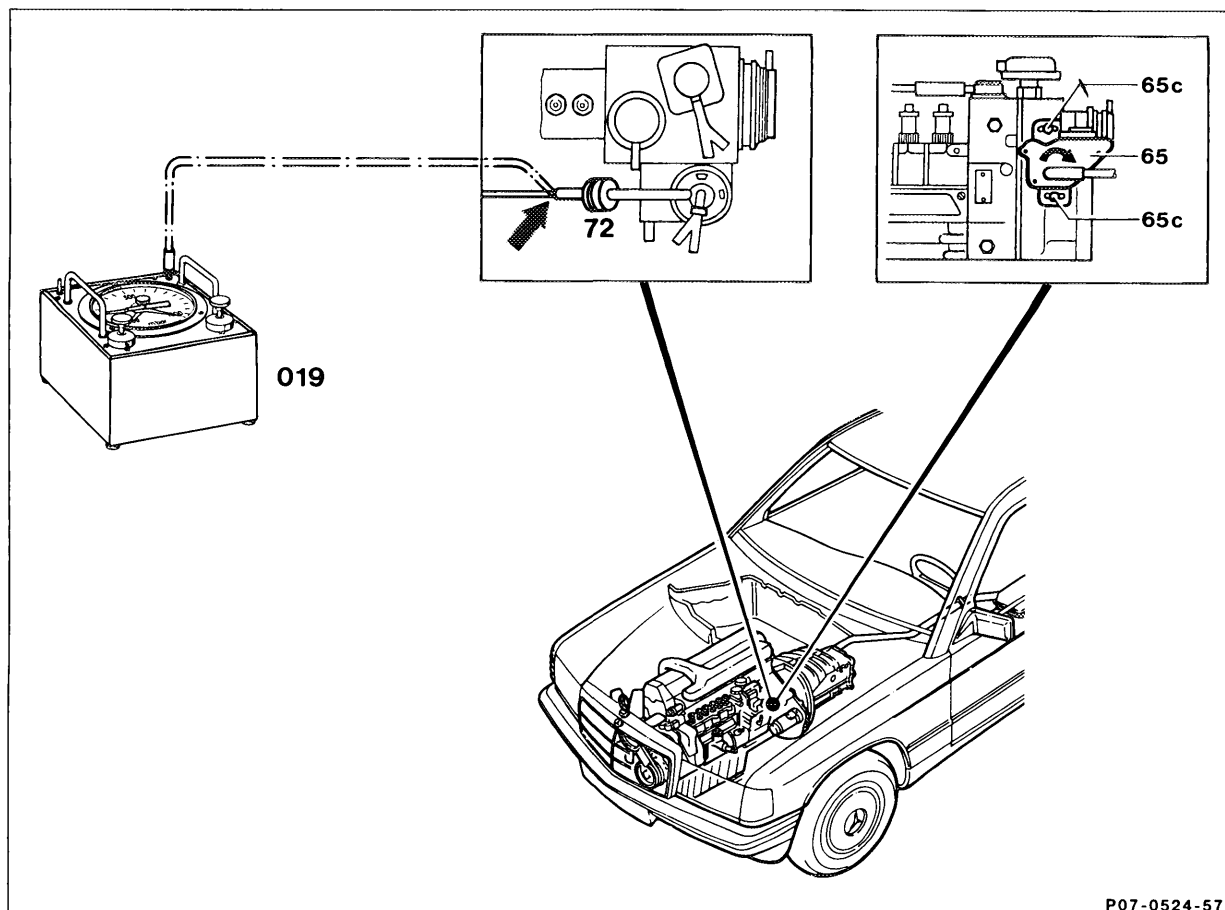

Note

Test conditions:

run engine up to normal operating temperature
(approx. 80°C coolant temperature).

Accelerator control correctly set (30-300).

Vacuum tester (019) connect to damper (72) of vacuum line and take reading of vacuum at idle speed.
 Specification: Engine 602, 420 ± 25 mbar
 Engine 603, 385 ± 25 mbar

With engine off, move accelerator control to full-load stop.

Specification: 0 mbar, it may be necessary to set vacuum control valve. Test vacuum lines, test vacuum pump, replace vacuum control valve.

Fastening bolts (65c) loosen, run at full throttle until control lever of injection pump is resting against full-load stop. Turn vacuum control valve (65) in direction of arrow until resistance is felt. Tighten vacuum control valve in this position.

A seal (arrow) is installed in the vacuum control valve to prevent dust and dirt getting into the valve.

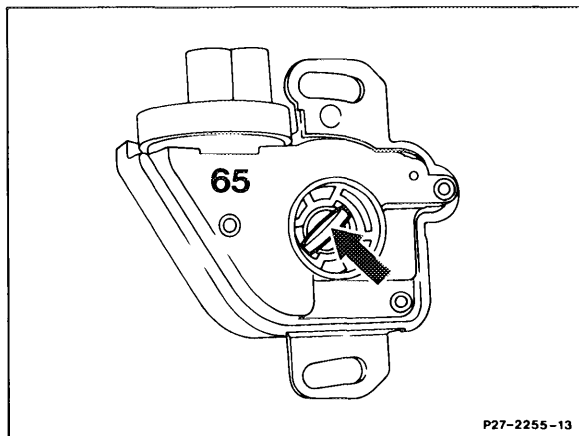

Special tool

