

07.1-145 Checking fuel pump

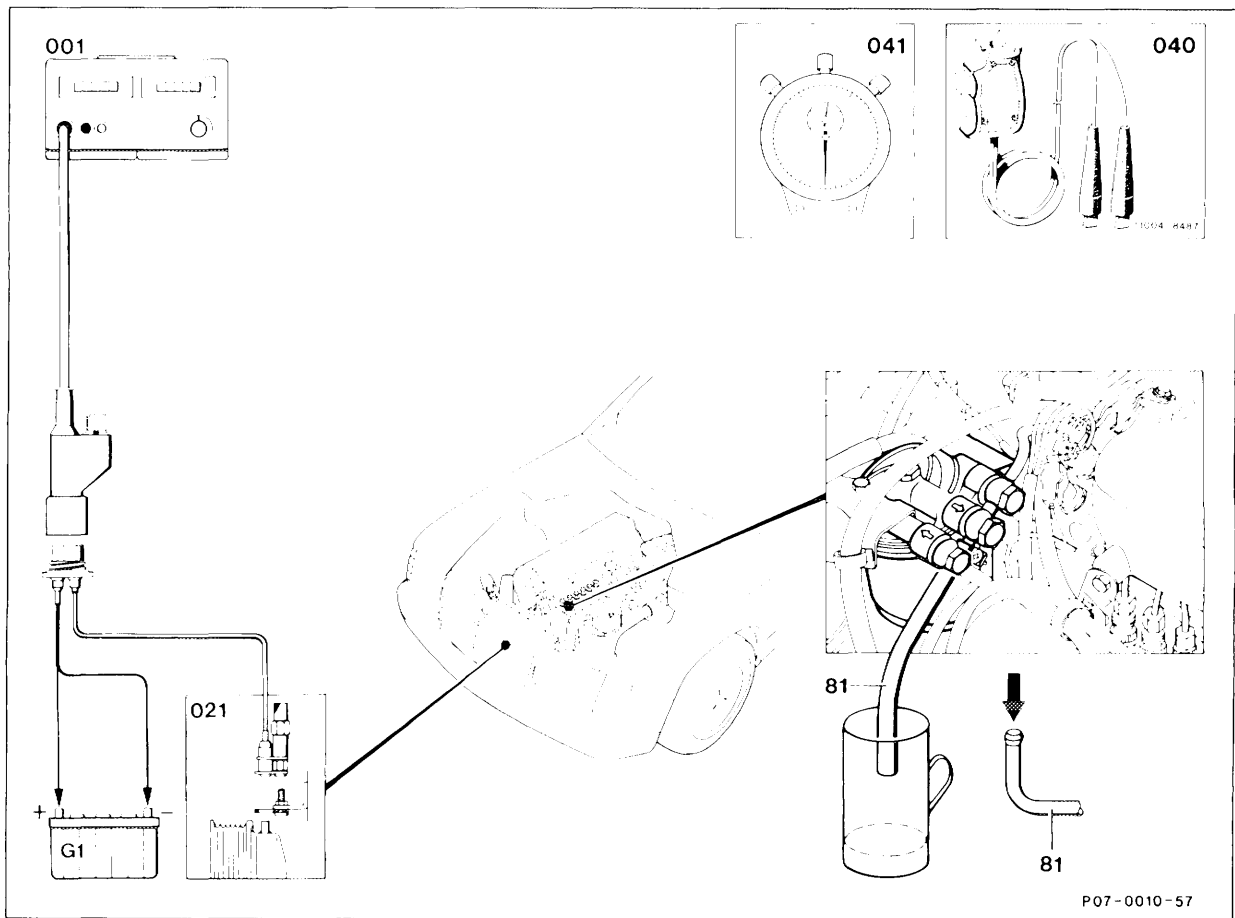

Testers (001, 015, 016, 021) connect
 Return line (81) disconnect and hold in the measuring cup approx. 1 l.

Note

The return to the fuel tank must be sealed.

Key in steering lock position turn to "0", this means the injection pump is in zero delivery position.

Connect contact handle (040) to terminal 30 and terminal 50 and start engine for 30 seconds (starting voltage min. 10 V).

Set value

Transfer pump at least 150 cm³/30 seconds. Replace fuel filter and/or transfer pump if required. Check fuel pressure (07.1-146).

Use stop watch (041)

Test values

Engine	601, 602, 603
Rate of delivery at 150/min minimum	at least 150 cm ³ /30 s
Test requirement	Glow starter switch in position "0"

Special tools

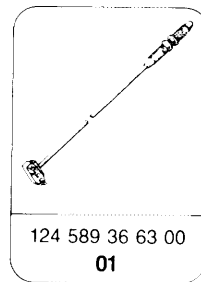
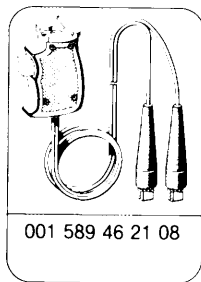
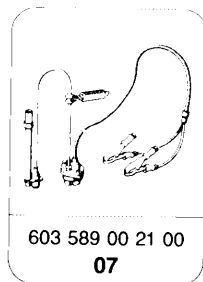
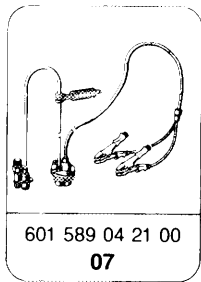

Commercially available tools

Digital tester	e.g. Bosch, MOT 001.03
Measuring glass or cup (at least 1 liter)	
Stop watch	

Checking

1 Connect digital tester (001) according to connection diagram.

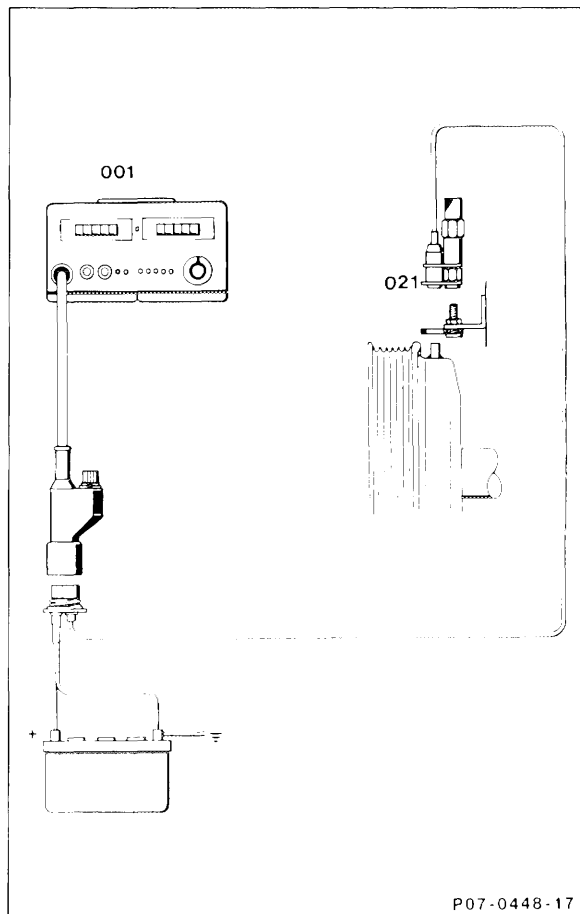

2 Disconnect return line (E) and hold into the measuring cup.

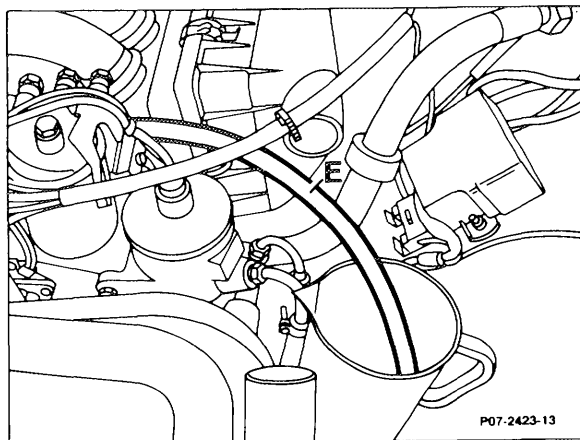

3 Turn ignition lock in position "0", the injection pump is now in "zero" delivery position.

4 Pull off coupling (X 27) and connect adapter line to terminal 50 (KI 50).

Model 201

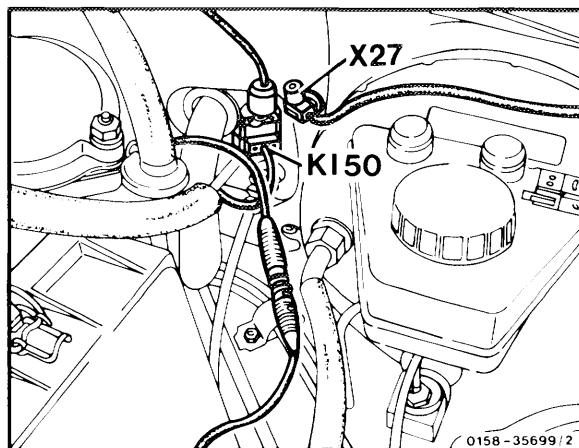

Connect contact handle to adapter line and to one of the terminals 30 (KI 30) on terminal block (arrow) and start engine for 30 seconds.
(Starting voltage at least 10 V)

Set value rate of delivery:
at least 150 cm³/30 seconds

If the set value is not achieved, check fuel pressure (07.1-146).

