

07.1-111 Checking start of delivery (position sensor RIV method)

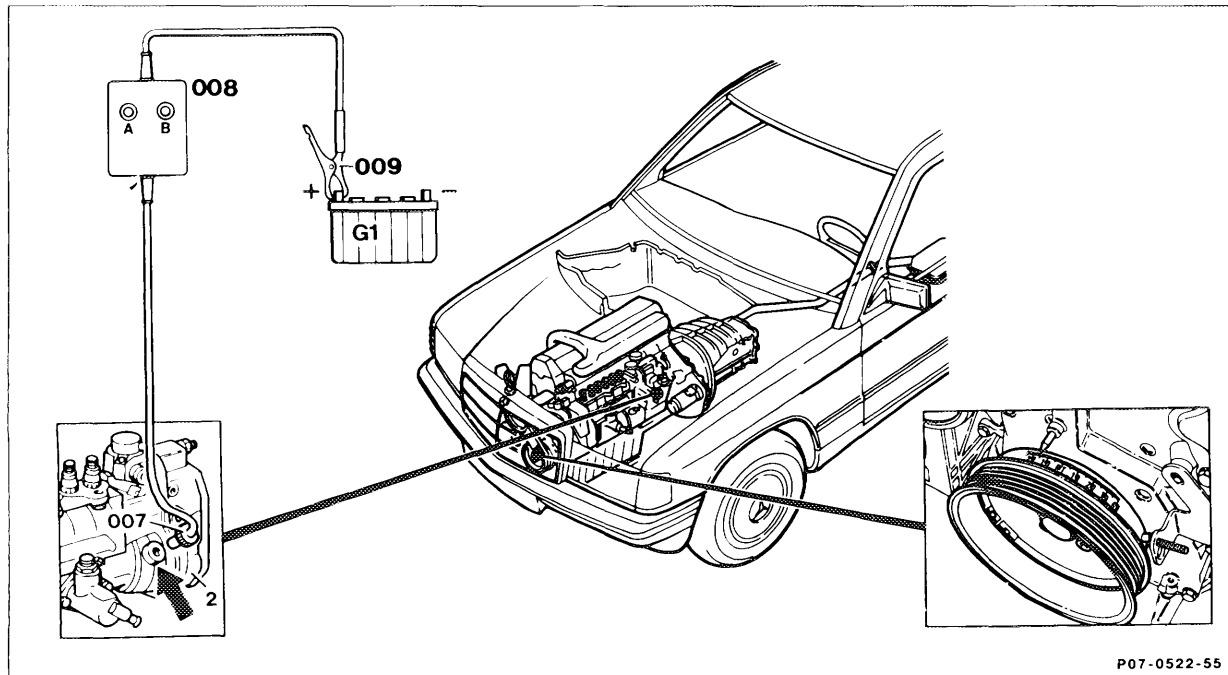

P07-0522-55

Governor housing screw plug (11)	unscrew, tightening torque 30-35 Nm.
Position sensor (007)	turn in.
Battery alligator clamp (009)	connect to battery +.
Manually turn crankshaft until	lamps A and B of the indicating instrument (008) light up simultaneously.
Read RI value (indirect start of delivery)	of the graduated scale, set value $15^{\circ} \pm 1^{\circ}$ ATDC. Adjust start of delivery if required (07.1-116).

Special tools

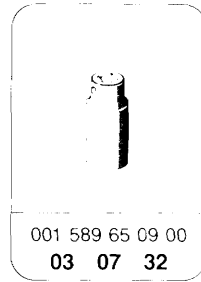
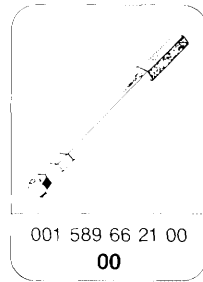

Checking

- 1 Remove screw plug (11).

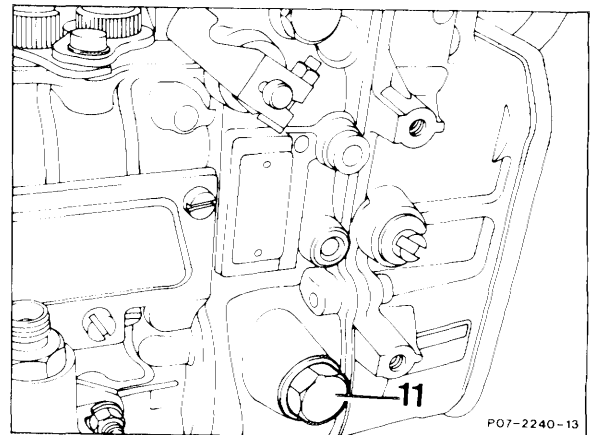

- 2 Turn position sensor into the governor housing. Ensure that the guide pin of the position sensor (arrow) faces up. Tighten union nut by hand.

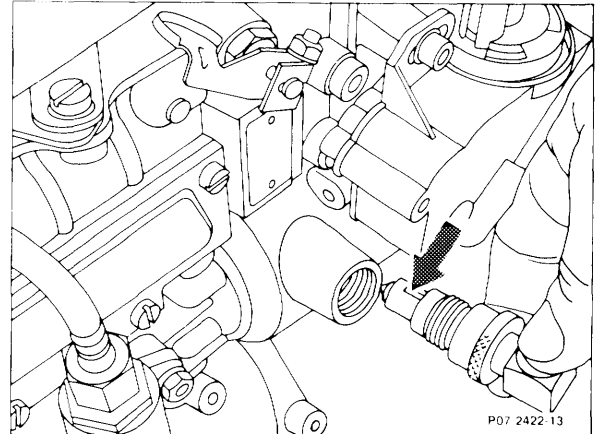

- 3 Connect position sensor according to connection diagram.

- 007 Position sensor
- 008 Indicating instrument
- 009 Battery alligator clamp (battery plus)
- 2i Flyweight (RIV sensor pin)

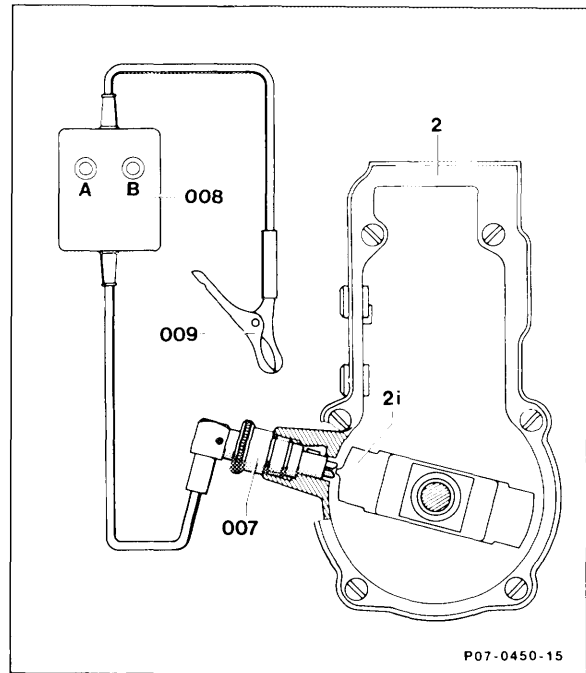

- 4 Use tool to turn crankshaft manually (only in direction of rotation) until lamp "A" lights up. Continue to turn until **both lamps "A + B"** light up. In this position read RI value (indirect start of delivery) off graduated scale.

RI set value: $15^\circ \pm 1^\circ$ ATDC.

If only lamp "B" lights up, repeat test.

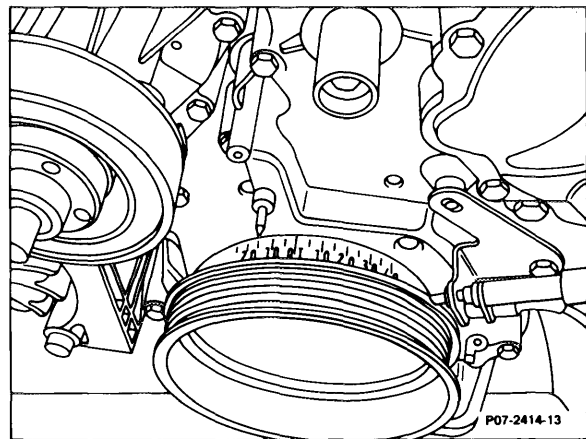

- 5 Remove position sensor.
- 6 Turn screw plug into governor housing (tightening torque 30-35 Nm).
- 7 Carry out leak test with engine running.
- 8 Check engine oil level and correct if required.