

03-324 Replacing front crankshaft radial sealing ring

Preliminary jobs:
 Radiator removed (20-420).
 Poly-V-belt removed (13-342).

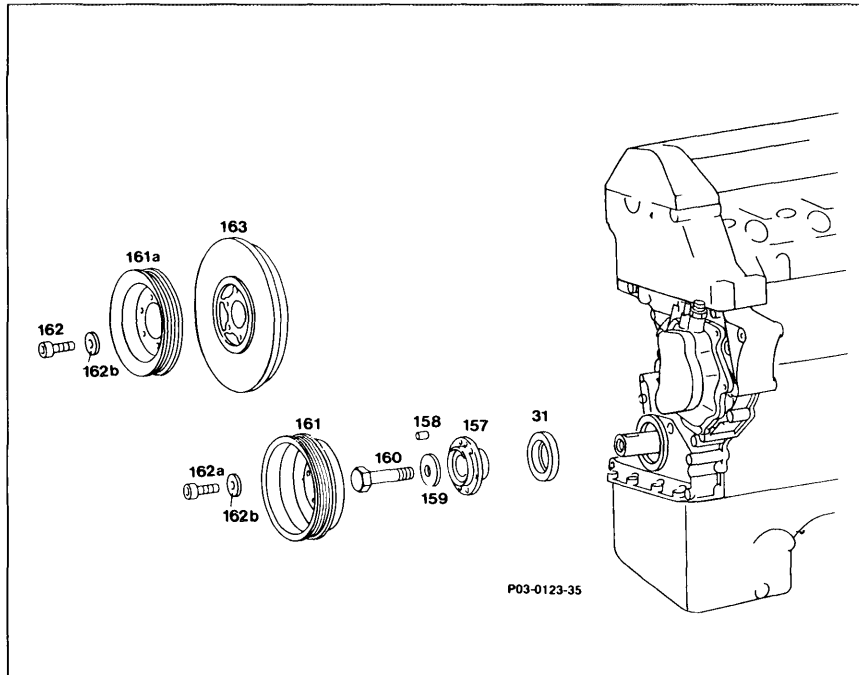

Engines 602, 603:

Crankshaft pulley (161 a) with vibration damper
 (163) and Allen screws (162) and
 washers (162 b)

remove, install (03-341) (item 2).

Note

The vibration damper for engine 602 is not interchangeable with that from motor 603. Do not interchange during repairs.

Hub (157) with hex. head bolts (160) and
 Belleville washers (159)

remove, install (item 3).

Note

The cylindrical pin (158) centers the crankshaft pulley and vibration damper.

Crankshaft radial seal (31) replace. Deburr and clean mounting bore. Coat sealing lip with oil and press in with special tool 601 589 03 14 00 (item 4).

Note

The sealing ring for the repair crankshaft radial seal is offset 3 mm toward the inside so that it will not run in a groove left on the hub by the standard crankshaft radial seal.

Part No. for repair crankshaft radial seal:
010 997 34 47 or 010 997 68 47.

Tightening torques	Nm
Allen bolts for crankshaft pulley	25
Mounting bolt for hub	320

Special tools

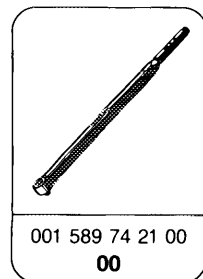
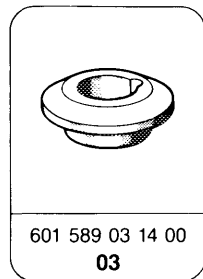
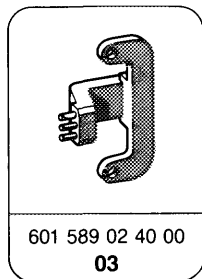
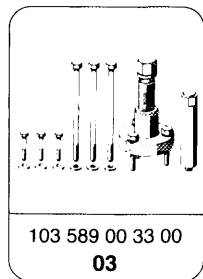
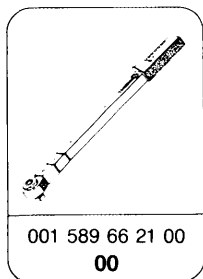

Commercially available too tool

Adapter 3/4" square socket to 1/2" square head	e.g.	Hazet, D-5630 Remscheid Order No. 1058 R-1
------------------------------------------------	------	--------------------------------------------------

Replacement

Engine 601.921

- 1 Remove crankshaft pulley (03-341).

Engines 602, 603

- 2 Remove crankshaft pulley with vibration damper (03-341).

Caution!

Do not interchange vibration dampers.

- 3 Remove crankshaft hub (03-341).

Note

The cylindrical pin centers the crankshaft pulley and vibration damper.

- 4 Press out crankshaft radial seal with screwdriver. Do not damage crankshaft journal or mounting bore.

Installation note

Deburr and clean mounting bore for crankshaft radial seal.

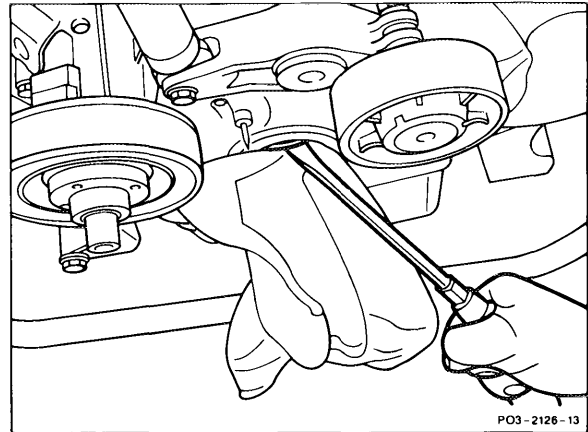

Coat sealing lip of new crankshaft radial seal with oil and press in with special tool 601 589 03 14 00.

Assure that the crankshaft radial seal is seated properly.

- 5 Reinstall in opposite order.

