

01-210 Removal and Installation of timing cover

Preliminary operations:

Engine compartment capsule, bottom section removed (01-006).

Radiator removed (20-420).

Magnetic or viscodrive fan clutch removed (20-335, 20-312).

Crankshaft pulley and hub removed (03-341).

Poly-V-belt tensioning device removed (13-345).

Piston vacuum pump removed (43-618).

Power steering pump or tandem pump removed (46-710).

Hydraulic pump on cylinder head removed (05-437).

Alternator removed (15-510).

Engine oil drained.

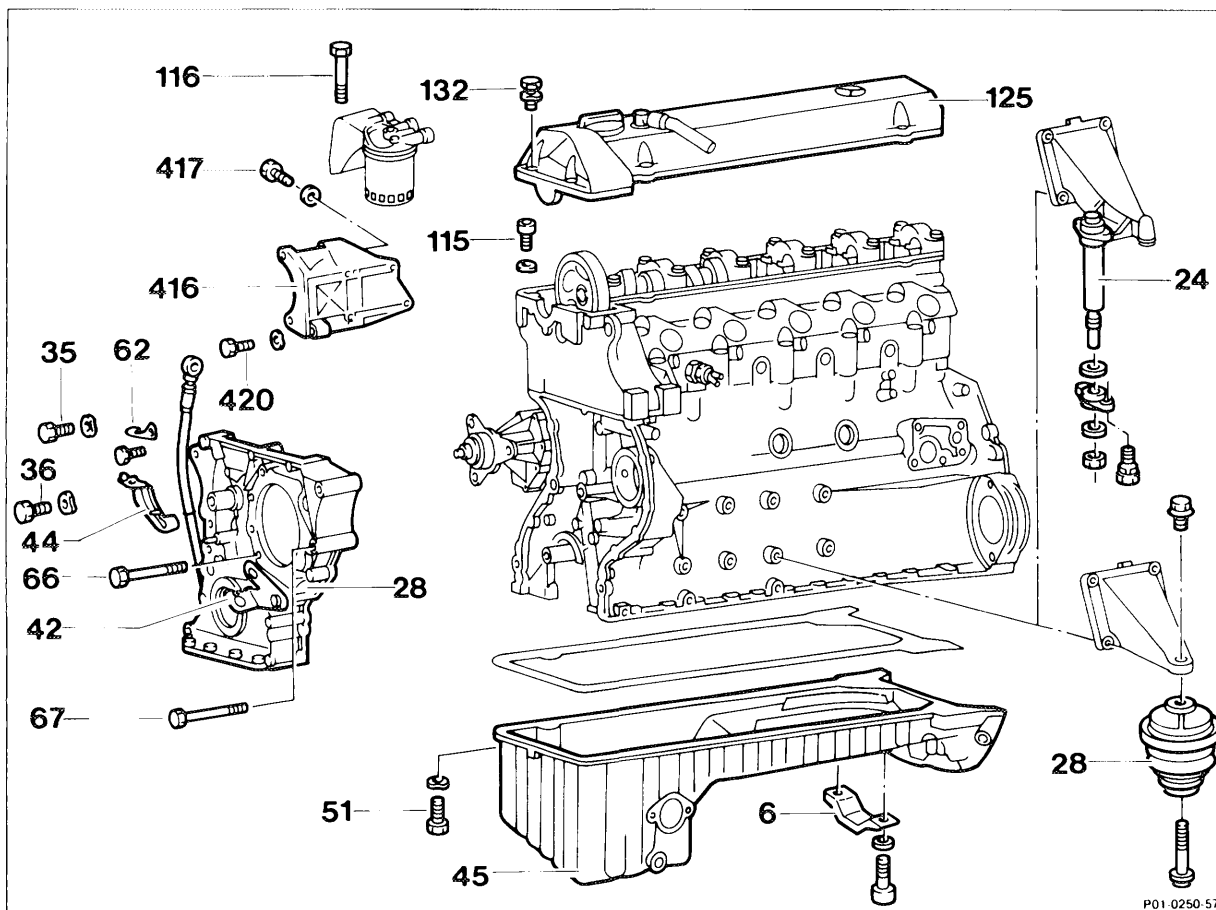

P01-0250-57

Air conditioning:

Condenser

Caution!

Attach guard plate.

Cylinder head cover (125)

remove if not yet removed, install, 10 Nm (item 1).

Note

On turbo-engines the charge air pipe must be removed before removing the cylinder head cover.

Front hex. head bolt (116)	for fuel filter, remove, reinstall, 25 Nm (item 2).
Holder (62)	for oil dipstick tube, remove, reinstall, 25 Nm (item 3).
Hex. head bolts (417)	on mount (416) for alternator, remove, reinstall and remove mount, install, 45 or 25 Nm (item 4).
Holder for TDC sensor (42 or 44)	mark position and unbolt, reinstall (item 5).

Note

Check TDC sensor adjustment, readjust if required (03-345).

Model 201 (up to 03/85):

Mount (6) for engine stop	remove, reinstall, 25 Nm (item 6).
-------------------------------------	------------------------------------

Model 201 (up to 03/85):

Engine shock absorber (24), left	remove, install, 10 Nm (item 7).
--	----------------------------------

Note

Check engine stop, adjust, 130 Nm (22-220), adjustment gauge 201 589 04 23 00.

Model 126:

Engine shock absorbers (24), left and right	remove, install, 10 Nm (item 8).
---	----------------------------------

Front suspension eye on engine	hook in engine hoist (item 9).
--	--------------------------------

Engine mounts (28), front, left and right	remove Allen bolts at bottom, reinstall, 40 and 70 Nm (item 10).
---	--

Engine	lower back on engine mounts with engine hoist (item 14).
Hex. head bolts (66, 67)	for mounting injection pump, remove, reinstall, 25 Nm (item 15).
Allen bolts (115)	in timing chain housing, remove, reinstall, 25 Nm (item 16).
Hex. head bolts (35, 36)	in timing case cover, remove, reinstall, 25 Nm (item 17).
Timing case cover (28)	remove, install (item 17).

Caution!

When removing timing case cover pay attention to cylinder head gasket and oil pan gasket. Avoid damaging. Replace damaged cylinder head gasket.

Note

Clean parting surface on timing case cover, seal cover with sealant 001 989 95 20.

Check crankshaft radial seal in timing case cover, remove if required, install, sleeve 601 589 03 14 00 (item 17).

After installation	warm up engine and check for leakage (item 19).
------------------------------	---

Sealant

Hylomar	001 989 25 20
---------	---------------

Tightening torques		Nm
Allen bolts, mount, engine stop, front		10
Adjustment screw, engine stop, front		130
Allen bolt, engine mount, front		40
Allen bolt, engine mount, front, model 126		70
Hex. head bolts, cylinder head cover		10
Cylinder head bolts in timing chain case		25
Hex. head bolts, mount, alternator		45
Hex. head bolts, oil pan	M6	10
	M8	25
Hex. head bolts for mounting injection pump		25
Hex. head bolts for mounting timing case cover		25
Hex. head bolts for engine shock absorber mount		10
Hex. nuts, engine shock absorber		10

Special tools

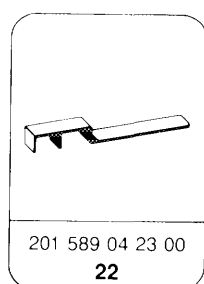
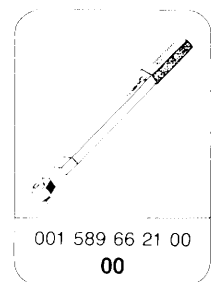
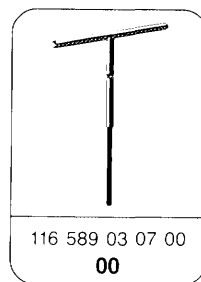
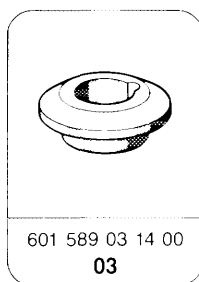
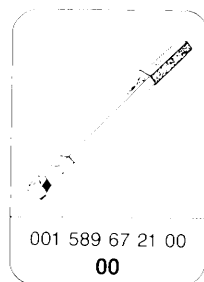
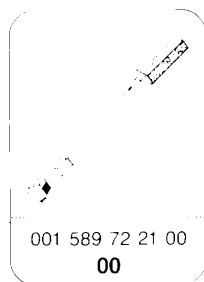

Commercially available tools

Connection 3/4" square ratchet
to 1/2" square head

e.g. Hazet,
D-5630 Remscheid
Order no. 1058 R. 1

Engine hoist no. 3188
(self-braking)

e.g. Bäcker,
D-5630 Remscheid,
Herderstraße

7 mm socket on flexible shaft for hose
clamps with worm drive

e.g. Hazet,
D-5630 Remscheid
Order no. 426-7

Self-made tool

Guard plate for air conditioner condenser

Dimensions: approx. 480 x 600 x 1

Removal, installation

Caution!

On vehicles with air conditioning attach guard
plate to condenser before starting work.

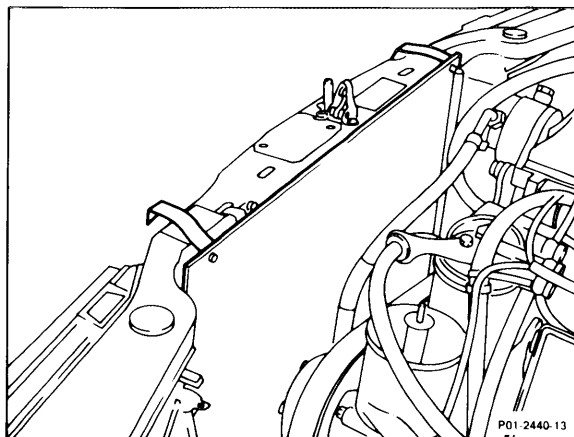

1 Remove cylinder head cover, if not already
removed.

Installation note

Tightening torque 10 Nm.

Note

On turbo-engines the charge air pipe (arrow)
must be removed before removing the cylinder
head cover.

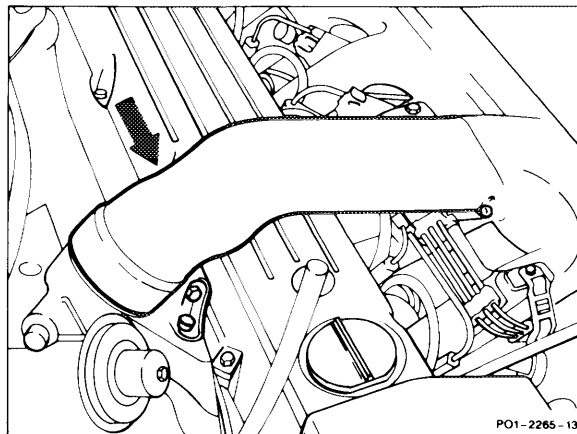

2 Remove hex. head bolts (116) at front of fuel filter.

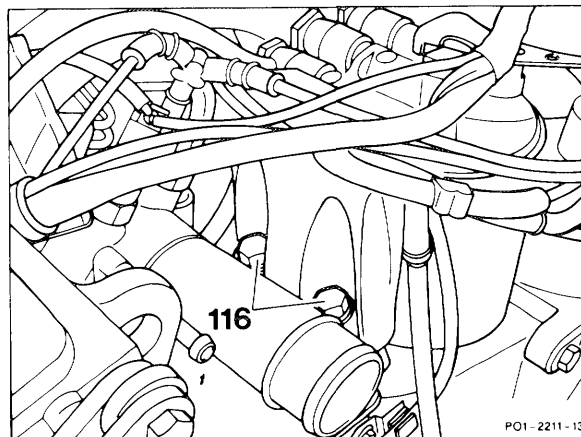

3 Unbolt holder (62) for oil dipstick tube, 25 Nm.

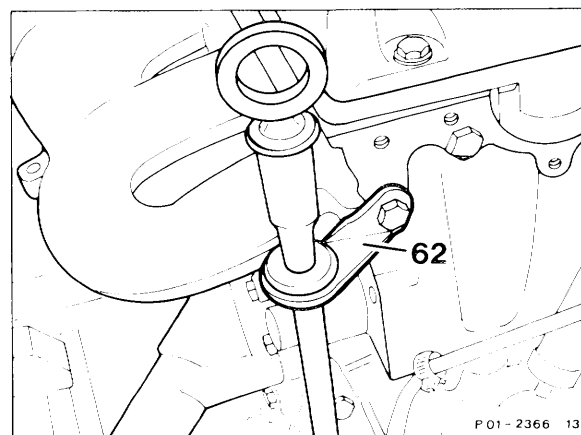

4 Remove hex. head bolts (arrows) on mount for alternator and remove mount.

Installation note

Tightening torques

Mounting bolts for mount

45 Nm

Mounting bolt on timing
case cover

25 Nm.

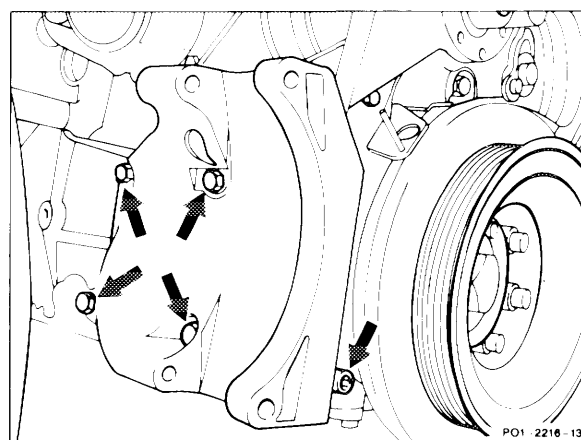

5 Mark position of mount for TDC sensor (42 or 44) and unbolt mount.

Installation note

Check TDC sensor and adjust if required
(03-345).

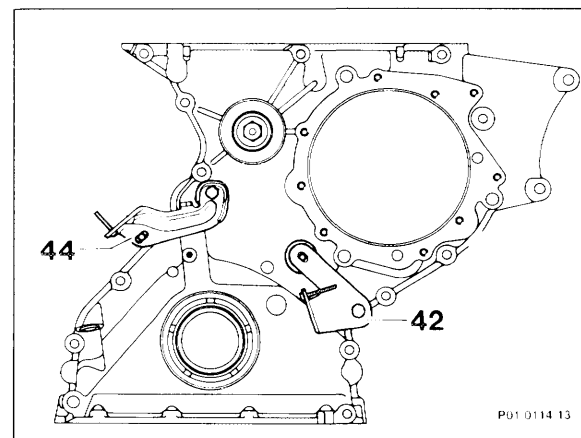

Model 201 (up to 03/85):

6 Remove Allen bolts (arrows) on mount for engine stop at front and remove mount.

Installation note

Tightening torque 25 Nm.

Check engine stop with adjustment gauge 201 589 04 23 00 and adjust (22-220).

Tightening torque for adjustment bolt 130 Nm.

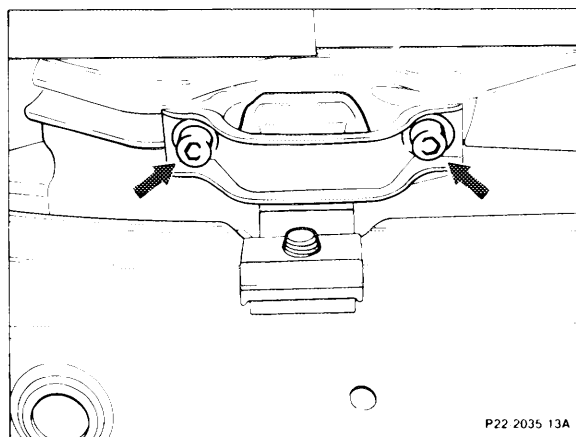

Model 201 (up to 03/85):

7 Remove engine shock absorber on left; remove hex. head bolts (arrows) on mount and remove engine shock absorber from frame cross member.

Installation note

Tightening torque 10 Nm.

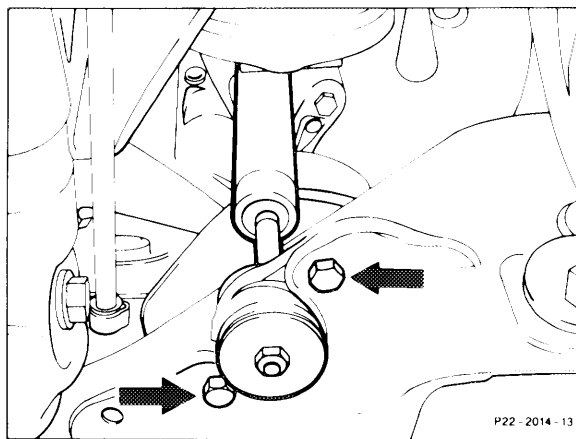

Model 126:

8 Remove engine shock absorbers (24) on left and right; unscrew hex. nuts (50) and press shock absorber upward out of mount on frame cross member (49).

Installation note

Tightening torque 10 Nm.

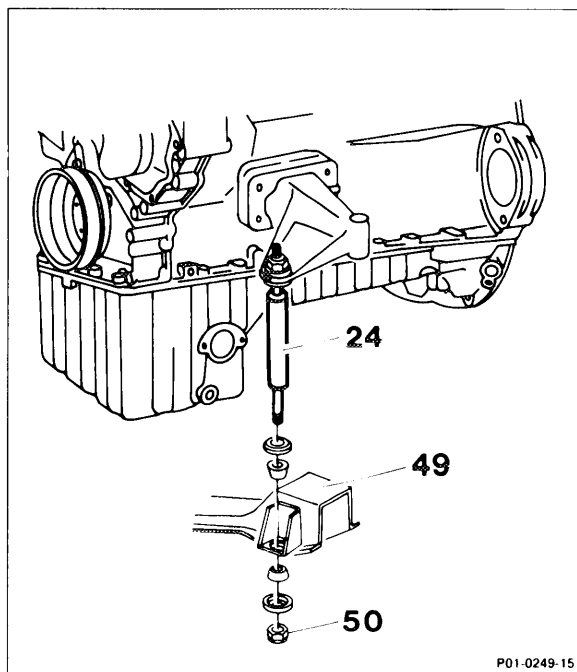

9 Attach engine hoist cable to front suspension eye (arrow).

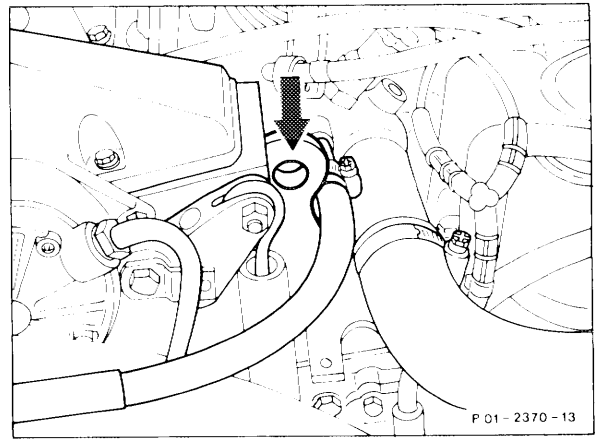

10 Remove Allen bolts for front engine mount from frame cross member from bottom.

Installation note

Tightening torque

Model 124 and 201

Model 126

40 Nm

70 Nm

Allen bolt, engine mount, left

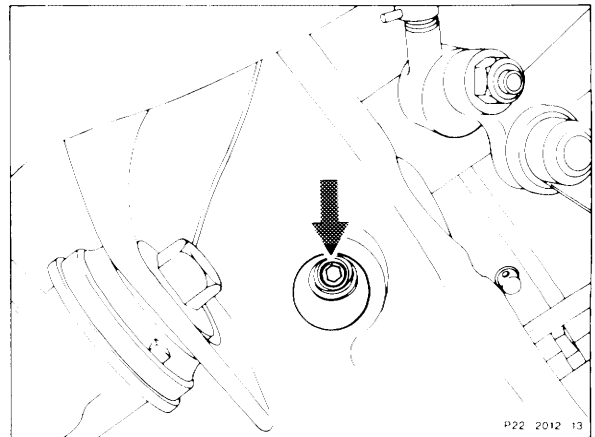

Allen bolt, engine mount, right

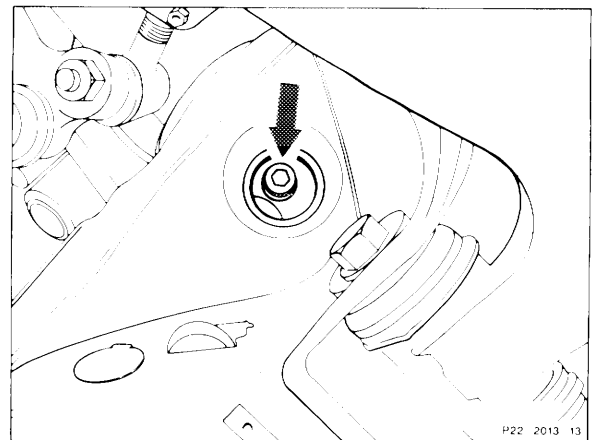

12 Hoist engine with engine hoist until hex. head bolts in oil pan are accessible in area of timing case cover.

13 Remove hex. head bolts in oil pan in area of timing case cover and loosen remaining bolts.

Installation note

Tightening torque M6 10 Nm,
 M8 25 Nm.

14 Lower engine back onto front engine mounts.

15 Remove hex. head bolts (arrows) for mounting injection pump. Remove square nuts on injection pump flange.

Installation note

Tightening torque 25 Nm.

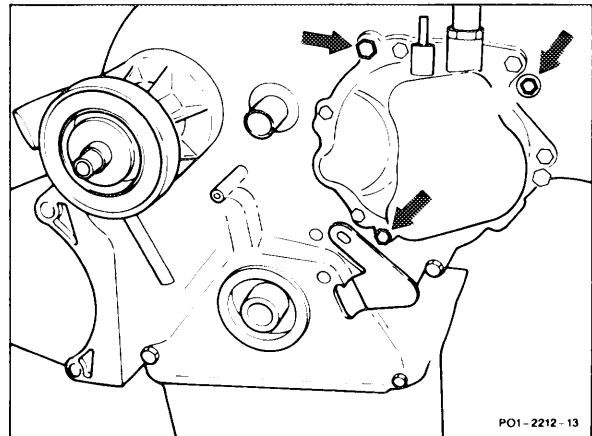

16 Remove Allen bolts (arrows) in timing chain case.

Installation note

Tightening torque 25 Nm.

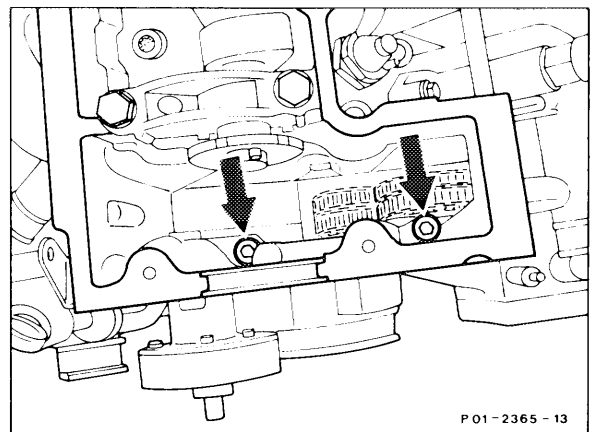

17 Remove all remaining hex. head bolts (arrows) in timing case cover and remove timing case cover.

Caution!

When removing timing case cover be careful of cylinder head gasket and oil pan gasket. Avoid damaging. Replace damaged gaskets.

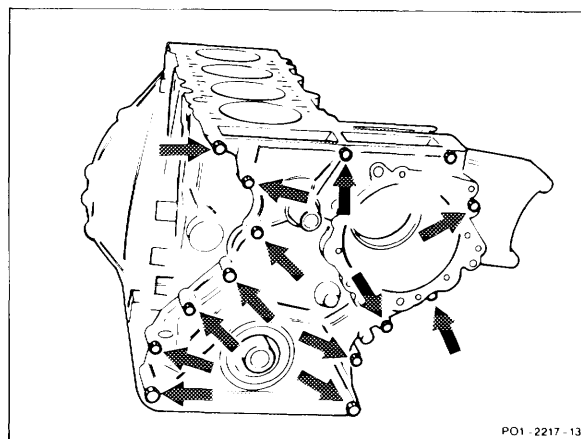

Installation note

Clean gasket residues off of parting surface on timing case cover.

Check crankshaft radial seal in timing case cover and replace, if required, installation sleeve 601 589 03 14 00.

Coat parting surface of timing case cover with sealant 001 989 25 20. Tightening torque 25 Nm.

18 Assemble in opposite order.

19 After installation warm up engine and check timing case cover for leakage.

