

42-0150 Disassembly and assembly of fixed caliper, renew parts according to condition

Preliminary jobs:

Remove fixed caliper on front axle (42-0100).
Remove fixed caliper on rear axle (42-0120).

Operation no. of the operation texts and work units
or standard texts and flat rates _____

42-0351

A. Front axle

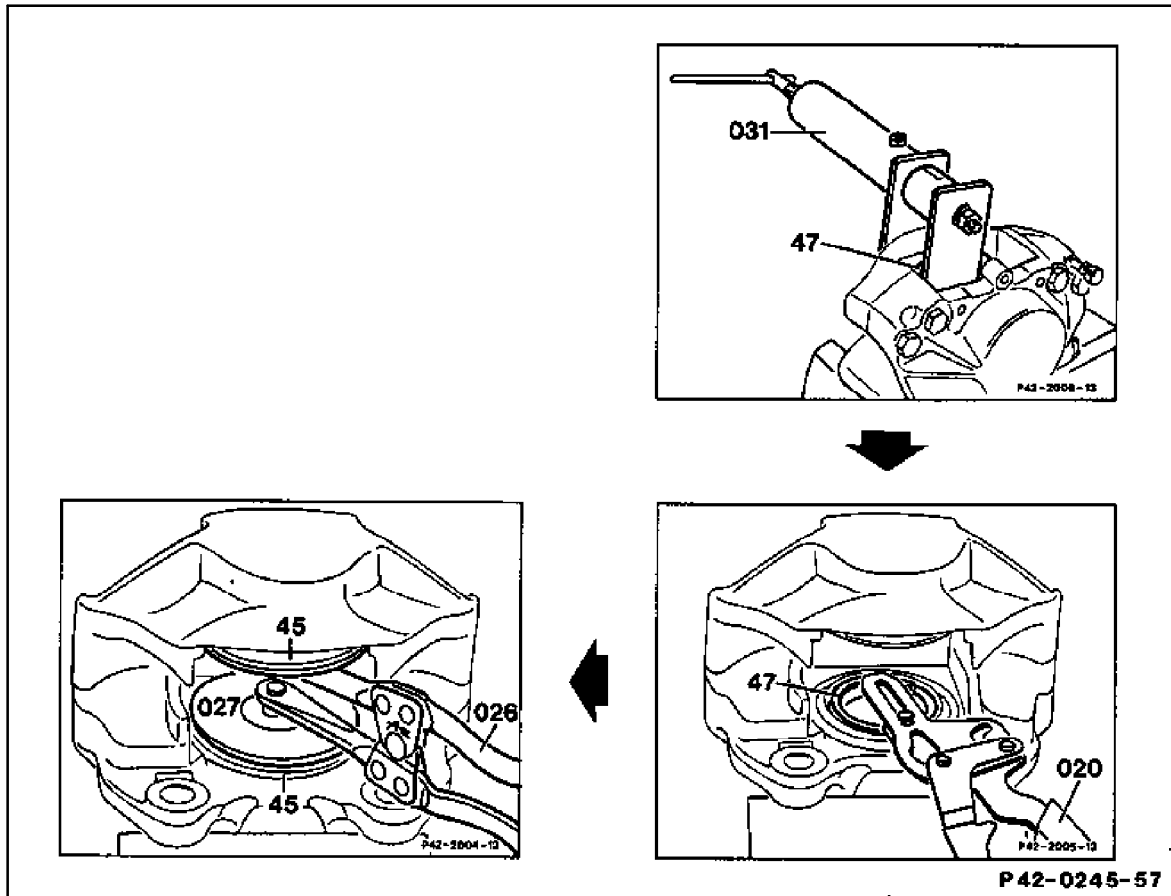

M

Do not separate the two halves of the fixed caliper from one another, because the mounting bolts are tightened to a certain torque at the production plant.

Failure to observe can result in leakage at the brake caliper.

Dust cap (45) _____ press off of housing with screwdriver. To install press dust cap onto collar on fixed caliper with appropriate plates (027) and pliers (026)
000 589 49 37 00.

Piston (047)	<p>hold in place with resetting tool (031) 000 589 52 43 00. Then carefully press opposing piston out with compressed air. If the pistons are seized due to rust, install new fixed caliper. Remove coatings on piston with soft brass wire brush or rough cleaning rag. Do not use polishing or emery cloth on piston, because this would damage the chrome-plated surface. If chrome plating is damaged, renew piston. To install insert piston into bore in fixed caliper so that the raised spot on the piston points upward when the fixed caliper is installed. The raised spot causes the brake pads to make contact on one side only when braking to reduce the tendency to squeal. For this purpose insert feeler gauge (019) 000 589 35 23 00 and turn piston with piston turning pliers (020) 000 589 50 37 00. Install dust cap (045) on piston and attach to collar of fixed caliper.</p>
Piston seal (050)	<p>remove from groove in cylinder bore. Check cylinder bores in fixed caliper for wear. If scoring or rusted spots are present in the bores, renew complete fixed caliper. Remove slightly rusted spots in the bore with crocus cloth, heavier rust spots in front of the groove for the piston seal with fine emery cloth (grain size 380 to 500). Coat new piston seals lightly with ATE brake cylinder paste and insert into groove in cylinder bore</p>

Note on Bendix fixed calipers

When repairing assure that the ring pressed into the piston bore is seated properly and tightly.

Press heat shield plates on according to piston position with installation tool (028)

000 589 51 43 00. Remove piston again and install dust cap.

M

The high spot on the piston must extend at least 0.1 mm beyond the heat shield plate. The shield plates for the inside and outside pistons are different.

Data

Fixed caliper brand	Teves Bendix up to September 1985	Teves Bendix from September 1985
Housing dia.	59.99 60.04	56.99 57.04
Shaft width for brake pads	90+0.15	90+0.15

Lubricant

ATE brake cylinder paste

Special tools

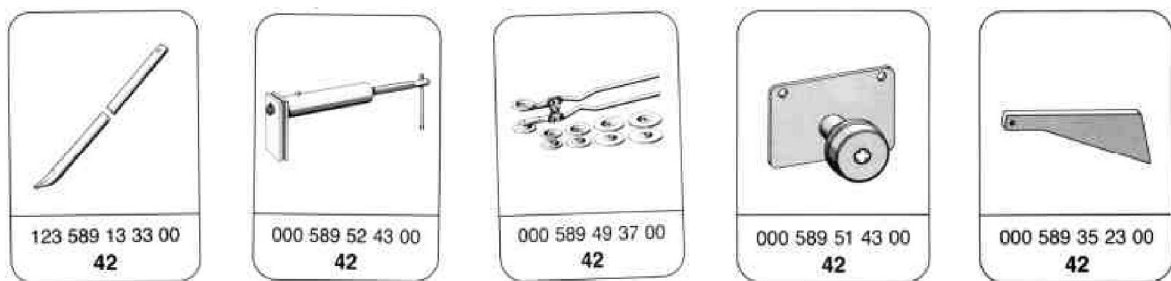

Commercially available tool

Open double box wrench 9B11

e. g. Hazet,
D-5630 Remscheid
Order no. 612

B. Rear axle

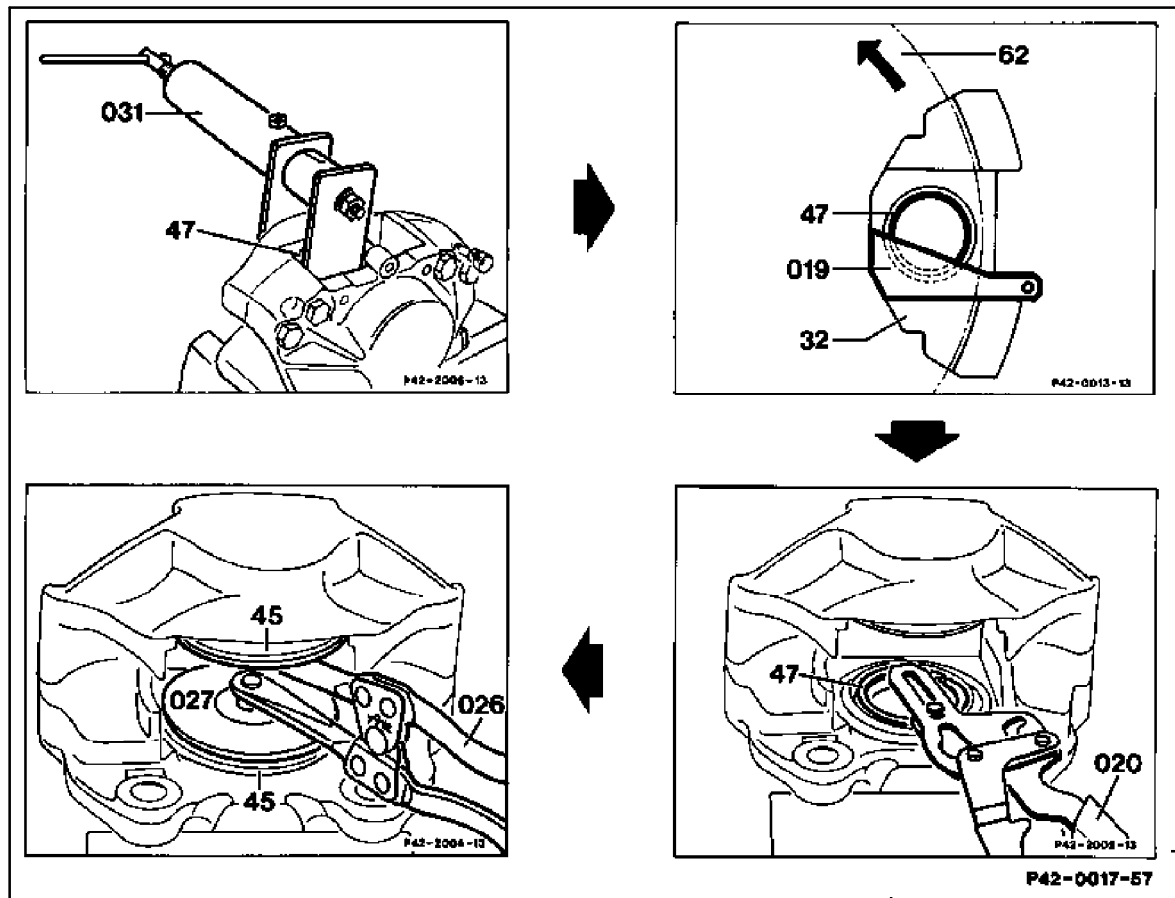

M

Do not separate the two halves of the fixed caliper from one another, because the mounting bolts are tightened to a certain torque at the production plant.

Failure to observe can result in leakage at the brake caliper.

Dust cap (45) _____ press off of housing with screwdriver.

Piston (47)

hold in place with resetting tool (031)

000 589 52 43 00. Then carefully press opposing piston out with compressed air. If the pistons are seized due to rust, install new fixed caliper. Remove coatings on piston with soft brass wire brush or rough cleaning rag.

Do not use polishing or emery cloth on piston, because this would damage the chrome-plated surface. If chrome plating is damaged, renew piston. To install insert piston into bore in fixed caliper so that the raised spot (marked black) on the piston (047) points in the direction of rotation of the wheel. The raised spot causes the brake pads to make contact on one side only when braking to reduce the tendency to squeal. For this purpose insert feeler gauge

(019) 000 589 35 23 00 and turn piston with piston turning pliers (020) 000 589 50 37 00. Install dust cap (045) on piston and attach to collar of fixed caliper.

Piston seal (50)

remove from groove in cylinder bore. Check cylinder bores in fixed caliper for wear. If scoring or rusted spots are present in the bores, renew complete fixed caliper. Remove slightly rusted spots in the bore with crocus cloth, heavier rust spots in front of the groove for the piston seal with fine emery cloth (grain size 380 to 500). Coat new piston seals lightly with ATE brake cylinder paste and insert into groove in cylinder bore

M

Fixed calipers from different manufacturers may be installed on the rear axle. However the fixed calipers **must** have the same piston diameter.

On fixed calipers located behind the center of the axle on diagonal swing axles (a) the high spot on the fixed caliper piston (to reduce brake squeal) must point up.

On fixed calipers located in front of the center of the axle on diagonal swing axles with anti-squat control (b) the high spot must point down.

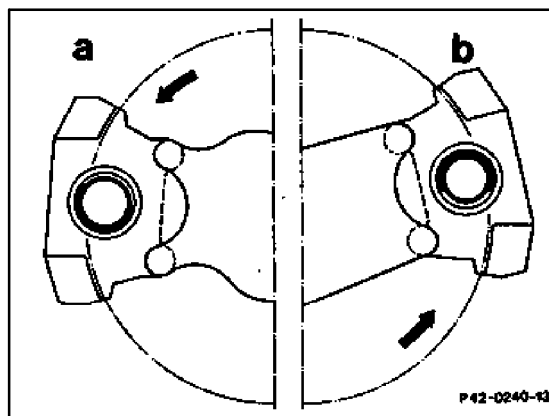

Data

Fixed caliper brand	Girling	Bendix Teves
Housing dia.	38.17 38.22	37.99 38.03
Shaft width for brake pads	62+0.15	62+0.15

Lubricant

Special tools

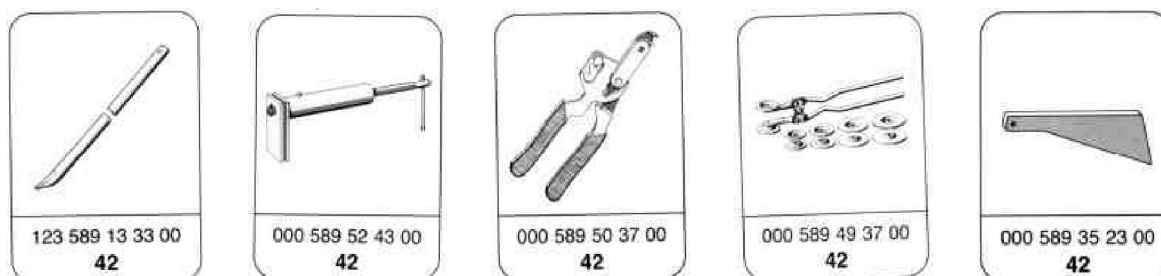

Commercially available tool

Open double box wrench 9B11

e. g. Hazet,
D-5630 Remscheid
Order no. 612

Note on Bendix fixed calipers

When repairing assure that the ring pressed into the piston bore is seated properly and tightly.

Press heat shield plates on according to piston position with installation tool

(028) 000 589 51 43 00. Remove piston again and install dust cap.

M

The high spot on the piston must extend at least 0.1 mm beyond the heat shield plate.