

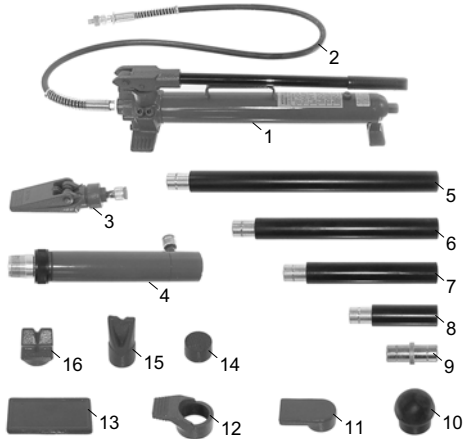

KL-0145-90



Specification:



KL-0145-92

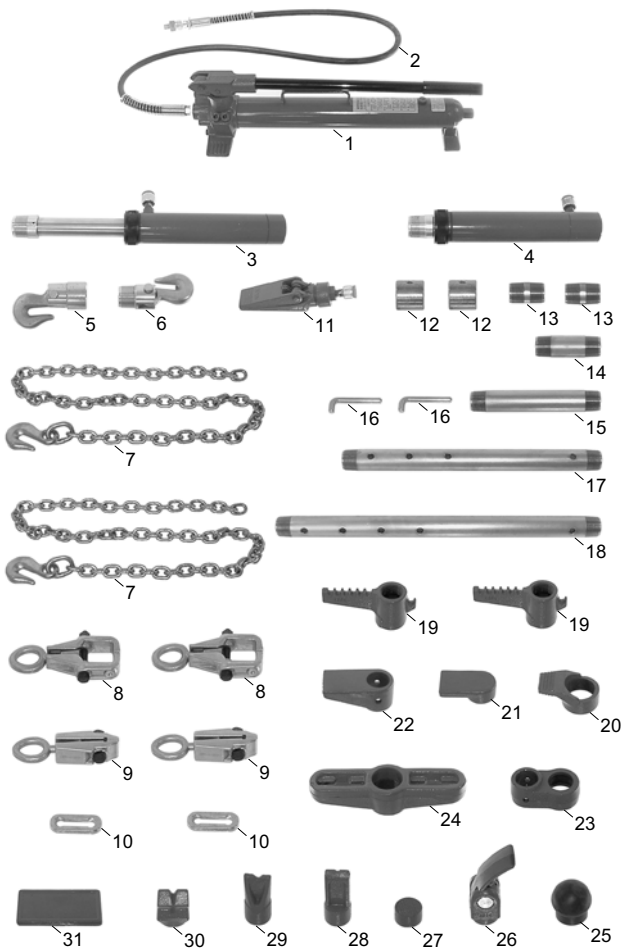

The Hydraulic Set is supplied complete with Storage Trolley.

KL-0145-90 Hydraulic Alignment Set 10 t.

The Hydraulic Press Set **KL-0145-90** allows Pressing and Spreading functions.

Contents:

Part No.	Description	Qty.
1	Hydraulic Hand Pump	1
2	Hydraulic Hose and Connector	1
3	Spreader	1
4	Press cylinder 10 t.	1
5	Extension Tube 530 mm	1
6	Extension Tube 400 mm	1
7	Extension Tube 300 mm	1
8	Extension Tube 170 mm	1
9	Extension Piece	1
10	Plastic Stop Ø 83 mm	1
11	Offset arm for Piston	1
12	Offset arm for Cylinder	1
13	Foot plate	1
14	Press piece flat	1
15	Press piece small prismatic	1
16	Press piece prismatic	1
	Plastic Case	1

KL-0145-92 Hydraulic Alignment Set 10 t.

The Hydraulic Alignment Set **KL-0145-92** allows Press, Pull, Clamp and Spread functions.

Contents:

Part No.	Description	Qty.
1	2 Stage Hydraulic Hand Pump	1
2	Hydraulic Hose and Connector	1
3	Pull cylinder 5 t.	1
4	Press cylinder 10 t.	1
5	Pulling Hooks	1
6	Pulling Hooks	1
7	Pull Chain with one Hook	2
8	Pull Clamp high	2
9	Pull Clamp flat	2
10	Pull Ring	2
11	Spreader	1
12	Threaded Adapter	2
13	Threaded Connector	2
14	Connector Tube 127 mm	1
15	Connector Tube 254 mm	1
16	Pins	2
17	Extension Tube 508 mm	1
18	Extension Tube 635 mm	1
19	Offset arm with Raster	2
20	Offset arm for Cylinder	1
21	Offset arm for Piston	1
22	Offset arm for extension tube	1
23	Adapter for extension tube	1
24	Chain Yoke	1
25	Plastic Stop Ø 83 mm	1
26	Press piece adjustable	1
27	Press piece flat	1
28	Press piece small prismatic	1
29	Press piece conical	1
30	Press piece prismatic	1
31	Foot plate	1
	Trolley	1

KL-0145-91

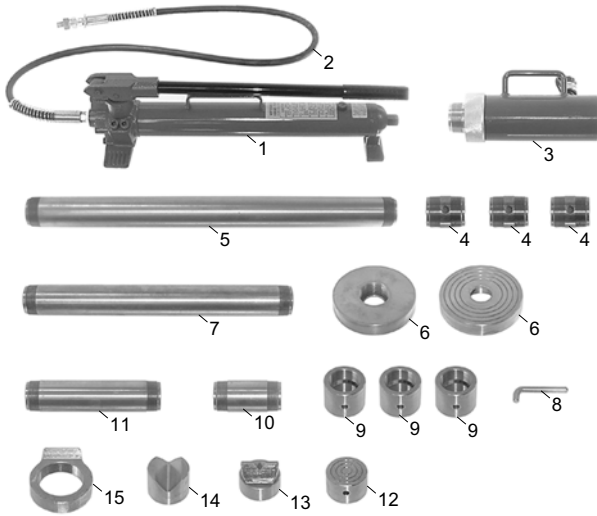

The Hydraulic Set is supplied complete with Storage Trolley.

KL-0049-31 with Adaptor 2¼" UNS on M18



KL-0049-3020



KL-0049-350



KL-0049-360

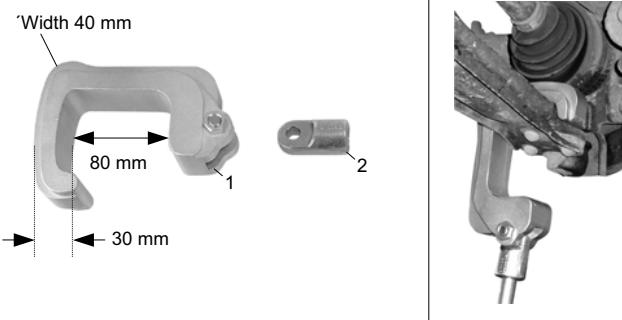

KL-0145-91 Hydraulic Alignment Set 20 t.

The Hydraulic Press Set **KL-0145-91** allows Pressing function.

Contents (KL-0145-91):

Part No.	Description	Qty.
1	2 Stage Hydraulic Hand Pump	1
2	Hydraulic Hose and Connector	1
3	Pull cylinder 20 t.	1
4	Threaded Connector	3
5	Extension Tube 710 mm	1
6	Press disc	2
7	Extension Tube 510 mm	1
8	Pins	1
9	Threaded Adapter	3
10	Connector Tube 130 mm	1
11	Connector Tube 255 mm	1
12	Press piece flat	1
13	Press piece conical	1
14	Press piece prismatic	1
15	Offset arm for Cylinder	1
	Trolley (not ill.)	1

KL-0049-31 Slide Hammer

For axles, drive shafts, wheel hubs, brake discs and brake drums, etc. inclusive Adaptor 2¼" UNS to M18.

Slide weight: 4,8 kg Length: 690 mm

KL-0049-3020 Hook

For the Slide Hammer **KL-0049-31**.

KL-0049-350 Clip with Hook and Joint

To pull body panels together with the slide hammer puller **KL-0049-31**.

The forged clip **KL-0049-3500** has an automatic self stress on on the cone. Ist field of application is a pulling force up to 20 t.

The forged hook **KL-0049-3501** made of hardened and tempered steel is suitable to any chain end of any make. When the chain is moved or remounted, it does not twist but it runs back parallel to itself. The clip **KL-0049-3500** is connected to slide hammer puller **KL-0049-31** by means of the hook **KL-0049-3501** and of the joint **KL-0049-3502**.

Contents (KL-0049-350):

Pos Nr.	Part no.	Description	Qty.
1	KL-0049-3500	Clip	1
2	KL-0049-3501	Hook	1
3	KL-0049-3502	Joint M18	1

KL-0049-360 Jointed Latch Hook

It is specially suitable to dismantle the control arm from the ball joint clamping hole in conjunction with the slide hammer **KL-0049-31**. Due to their profiled shape, hooks can be fixed very close to the ball joint.

Contents (KL-0049-360):

Pos Nr.	Part no.	Description	Qty.
1	KL-0049-3600	Latch Hook without Joint	1
2	KL-0049-3502	Joint M18	1

KL-0198-90 KB



Wiper arm removal with the Pressure Spindle.



Wiper arm removal with the Slide Hammer.



Specification:

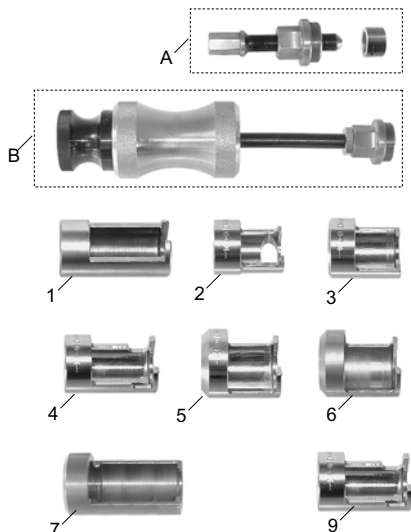

KL-0198-90 KB Wiper-Arm Puller Set (German Utility Model)

Suitable for: VW-Audi, BMW, Citroën Ford, Mercedes, Opel/Vauxhall, Peugeot, Renault etc.

To remove bolted Windscreen Wiper Arms, especially for those which have become rusted or corroded onto the drive-shaft.

Stubborn and deep-seated Wiper Arms may be quickly and easily removed using the **KL-0198-90 KB** Puller Set.

Wiper Arms with integrated Screen-Wash nozzles - e.g. VW-Audi, BMW etc. on the rear window - can be easily removed by using the Slide hammer included in the Set.

Wiper Arms with central holes may be removed by using the Pressure Spindle. Those Wiper Arms with no central hole require the Pressure Bolt to be used with the Pressure Adaptor supplied.

Contents:

Pos.	Part No.	Description	Qty.
	KL-0198-90 KB	Wiper Arm Puller Set	1
	<i>consists of:</i>		
A	KL-0198-9008	Pressure Spindle	1
B	KL-0198-9009	Slide Hammer	1
1	KL-0198-9001	Fork 1 (BMW, Citroën, Peugeot, VW etc.)	1
2	KL-0198-9002	Fork 2 (Citroën, Peugeot etc.)	1
3	KL-0198-9003	Fork 3 (VW-Audi, Citroën, Ford, Mercedes etc.)	1
4	KL-0198-9004	Fork 4 (VW-Audi, BMW, Citroën, Mercedes, Opel, Peugeot, Renault etc.)	1
5	KL-0198-9005	Fork 5 (Audi, BMW 1series, Citroën, Ford, Mercedes, Peugeot 307, Renault, VW Touareg, T5 etc.)	1
6	KL-0198-9006	Fork 6 (VW-Audi, BMW, Ford etc.)	1
7	KL-0198-9007	Fork 7 (BMW etc.)	1
9	KL-0198-9009	Fork 9 (Golf V, T5 rear window wiper, Skoda Superb, Peugeot 206, 307, 806 etc.)	1
	KL-0198-9090	Plastic Storage Case (empty)	1

Wiper Arm Puller Set:

KL-0198-921	Puller Set BMW (consists of: Pos. 1, 4, 6, 7, A)
Suitable for:	3 series Compact (E36) from '94, Z3, 3 series (E46) 1999 onwards, 5 series (E39) 1996 onwards

KL-0198-922	Puller Set Citroën (consists of: Pos. 1, 2, 3, 4, 5, A, B)
Suitable for:	Berlingo, C5, Evasion, Saxo, Xsara, Xsara Picasso

KL-0198-923 A	Puller Set VW-Audi, Ford (consists of: Pos. 1, 3, 4, 5, 6, 9, A, B)
Suitable for:	Audi 80 (from 1986 - '96), A3, A4 (up to 2001), A4 (2001 onwards), A6 (from 1997 - '01) Ford Fiesta (from 1995), Focus, Ka, Mondeo (up to 2001), Mondeo (from 2001), Galaxy (up to 2000), Galaxy (up to 2000) VW Polo (up to '99), Polo ('99 onwards), Lupo, Golf III, Golf IV, Golf V, Sharan (2000 onwards), Passat (up to 2000), Passat (2001 onwards), New Beetle

KL-0198-924	Puller Set Mercedes (consists of: Pos. 3, 4, 5, A)
Suitable for:	A Class, C Class (W203), Vito/ V Class, M Class, E Class (W210)

KL-0198-925	Puller Set Opel/Vauxhall (consists of: Pos. 1, 4, A)
Suitable for:	Corsa B, Corsa C, Astra F, Astra G, Astra G Kombi, Zafira

KL-0198-926	Puller Set Peugeot (consists of: Pos. 2, 4, 5, A)
Suitable for:	106, 206, 306, 306 Cabrio, 307, 406, 605, Partner

KL-0198-927	Puller Set Renault (consists of: Pos. 4, 5, A)
Suitable for:	Clio ('98 onwards), Espace ('96 onwards), Kangoo, Laguna, Laguna Estate, Mégane ('99 onwards), Mégane Limousine, Scénic, Twingo

KL-0198-923 KA



The set will be delivered in a plastic case.

KL-0198-80

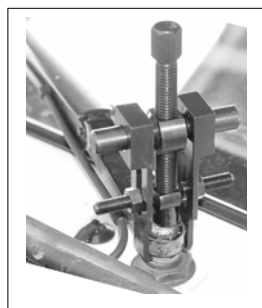
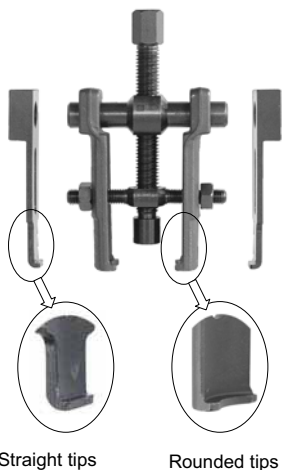

KL-0126-33

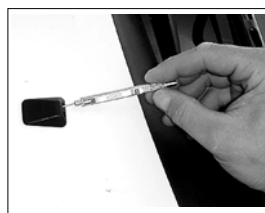

KL-0198-923 KA Wiper-Arm Puller Set (German Utility Model)

Suitable for: **VW-Audi, Ford etc.**

To remove bolted Windscreen Wiper Arms, especially for those which have become rusted or corroded onto the drive-shaft.

Stubborn and deep-seated Wiper Arms may be quickly and easily removed using the **KL-0198-923 KA** Puller Set.

Wiper Arms with integrated Screen-Wash nozzles on the rear window - can be easily removed by using the Slide hammer included in the Set.

Wiper Arms with central holes may be removed by using the Pressure Spindle. Those Wiper Arms with no central hole require the Pressure Bolt to be used with the Pressure Adaptor supplied.

Contents:

Part No.	Description	Qty.
KL-0198-923 KA	Wiper Arm Puller Set	1
<i>consists of:</i>		
KL-0198-9008	Pressure Spindle	1
KL-0198-9009	Slide Hammer	1
KL-0198-901	Fork 1	1
KL-0198-903	Fork 3	1
KL-0198-904	Fork 4	1
KL-0198-905	Fork 5	1
KL-0198-906	Fork 6	1
KL-0198-909	Fork 9	1
KL-0198-9090	Plastic Storage Case (empty)	1

Note: By using further forks also for **BMW, Mercedes, Peugeot etc.** suitable.

KL-0198-80 Wiper Arm Puller

Universally applicable

Its special shape, the two different hook couples (with extra thin straight tips and rounded tips) and the adjusting nut make this puller almost universal in its range of application.

Technical Data:

Drive:..... hex.14
 Hook width (straight tips): 15 mm
 Hook width (straight tips): 2,3 mm
 Hook width (rounded tips): 26,5 mm
 Hook thickness (rounded tips): 2,6 mm
 Pulling-Ø max: 45 mm
 Weight: 560 g

KL-0126-33 Screen Washer Jet Needle

The Screen-Washer Jet tool allows cleaning of blocked jets and accurate adjustment of spray-direction of all screen-washer jets.

Weight: 40 g

KL-0190-6

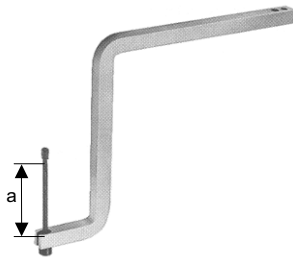

Opel, Ford,
Peugeot, Citroën

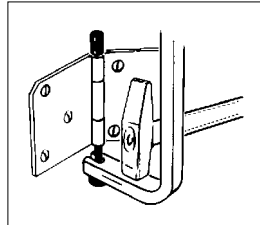

Spare Parts:



KL-0190-6 Slide Yoke

For removal and replacement of door hinge pins.
Application: Opel/Vauxhall, Ford, Peugeot, Citroën.

Consists of:

KL-0190-60 Slide Yoke

Without pulling bolts.

KL-0190-61 Pulling Bolts for Ø 5 mm (10 Pcs.)

Application: Opel/Vauxhall, Ford, Peugeot, Citroën. etc.

Length: 103 mm a: 72 mm

KL-0190-62 Pulling Bolts for Ø 4 mm (10 Pcs.)

Application: Ford, Citroën, etc.

Length: 118 mm a: 87,5 mm

KL-0190-63 Pulling Bolts for Ø 5 mm (10 Pcs.)

Application: Renault, etc.

Length: 123 mm a: 91 mm

KL-0270-3 B Wrench with 7 Bit Inserts

Suitable for **Door Hinge Bolts**

e.g. Audi 97 onwards; Renault Safrane / Laguna; Seat Arosa / Cordoba / Ibiza; VW Golf III / Golf IV / Passat 97 onwards / Polo / Vento; Škoda etc.

To quickly and easily loosen and tighten the bolts in door hinges.

Suitable for **Mercedes Toe Adjustment**

e.g. 190 Series (W201), C-Class (W202), C-Class (W203), 200 - 300 E (W124), E-Class (W210), S-Class (W220)

To adjust the Toe on the rear axle. Due to its special form, this tool allows easy and precise adjustments to the inaccessible adjustment bolts.

Technical Data:

Size 5/16"-Drive Bit-Inserts:

T30, T40, T45, T50, XZN-8, XZN-10, XZN-12

Length: 310 mm Weight: 430 g Bit-Drive: 5/16" ●

Accessories: KL-0270-303 Bit-Inserts Set 7 pcs.

Consists of 5/16" Drive Bit-Inserts size:

T30, T40, T45, T50, XZN-M8, XZN-M10, XZN-M12

KL-0270-3 B



For Torx and XZN



VW-Audi, Mercedes



KL-0270-31 B



For Torx and XZN



VW-Audi, Mercedes



KL-0270-31 B Wrench with 7 Bit Inserts

As KL-0270-3B, however in forged design.

Suitable for **Mercedes Toe Adjustment** e.g.

190 Series (W201), C-Class (W202), C-Class (W203), 200 - 300 E (W124), E-Class (W210), S-Class (W220)

Due to its special form, this tool allows easy and precise adjustments to the inaccessible adjustment bolts.

Technical Data:

Size 5/16" Drive Bit-Inserts:

T30, T40, T45, T50, XZN-8, XZN-10, XZN-12

Length: 320 mm Weight: 520 g Bit-Drive: 5/16" ●

Accessories: KL-0270-303 Bit-Inserts Set 7 pcs.

Consists of 5/16" Bit-Inserts size:

T30, T40, T45, T50, XZN-M8, XZN-M10, XZN-M12

Special body grip wrenches

137 K1



137 K2



137 K3



Note:

Further pliers and tools see GEDORE catalog.

Special body grip wrenches

137 K1 Special body grip wrench

With adjusting screw and dip-insulated release lever (blue).

137 K2 Special body grip wrench

With adjusting screw and dip-insulated release lever (blue). Special jaws with domed clamping surfaces, 25 x 20 mm at top, 7 x 7 mm at bottom.

137 K3 Special body grip wrench

With adjusting screw and dip-insulated release lever (blue). Special jaws with flat clamping surfaces, 40 x 14 mm at top, 40 x 35 mm at bottom.

KL-0120-80



Universal

Hinweis: Tools for the fuel system see chapter 6.2.

KL-0120-80 Tank Sender Spanner Set adjustable

Universal application.

For removing and replacing the Plastic Retaining Ring on the Sender Unit on Fuel Tanks.

Consists of:

KL-0120-801 Tank Sender Spanner Ø80 mm - Ø120 mm

Range:..... 80 - 120 mm

Drive:..... hex 24 mm

KL-0120-802 Tank Sender Spanner Ø110 mm - Ø170 mm

Range:..... 110 - 170 mm

Drive:..... hex 24 mm

KL-0126-205



KL-0126-205 Magnetic Lifter Telescope with Scribing Iron

Universal application in handy form for pocket storage.

With a strong magnetic head with 7,5 mm Ø providing a lifting force of 300 g. Extendable to a total length of 670 mm, collapsed length only 155 mm. The Scribe may also be used to adjust the aim of screen-wash nozzles.

KL-0272-10

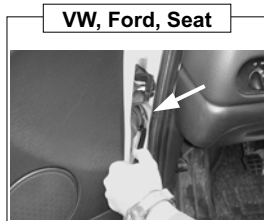

VW, Ford, Seat

KL-0272-10 Slotted-Nut Spanner Set (3 pcs.)

For: VW Polo, Sharan; Ford Galaxy; Seat Alhambra.

For quick and easy removal and replacement of the Slotted-Nut retaining the multi-pin electric socket on the door-pillar. Required when the door needs to be removed.

Size	Application examples
Size 1	VW Polo front door VW Sharan, Ford Galaxy, Seat Alhambra rear door
Size 2	VW Sharan, Ford Galaxy, Seat Alhambra up to 2000 front door
Size 3	VW Sharan, Ford Galaxy, Seat Alhambra from 2001 front door

® = reg. trademark of Camcar-Textron Inc. USA

KL-0270-2

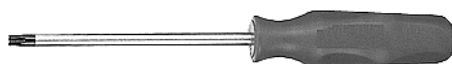

VW-Audi

KL-0270-2 Screwdriver XZN M4

Application: For door handle **VW Passat from 96 onwards and Golf IV.**

KL-0271-1



VW-Audi

KL-0271-1 Headlamp Adjusting Tool

For **VW Golf III and Vento.**

Length: 300 mm

KL-4305-6225



VW

KL-4305-6225 Screwdriver Torx® T25

For removal and replacement of VW Sharan Headlamps from 2000 onwards.

The long, slim form of this Screwdriver allows the Torx® -Bolts on the headlamps to be quickly and easily reached.

Length: 300 mm

Weight: 70 g

KL-0570-20

BMW



KL-0570-20 Special Torx® Socket T80

Necessary for removal and replacement of the windscreen wiper arm and adjusting the pressure on **BMW E31, E38 and E39**.

This special Torx® nut is mounted within the wiper arm bearing assembly.

Drive: 1/2"□

KL-4306-6330

BMW



KL-4306-6330 T-Handle Screwdriver Torx® T30

For the front mudguard fixing bolts on e.g. Audi A4, A6; BMW (3 series E36/E46, 7 series E38).

This tool is required to allow the front mudguards to be removed and replaced without the need to remove the front doors. The long, slim form of the tool allows the recessed Torx® Bolts in the A-post to be removed and replaced through the door-opening.

For removal and replacement of Audi (A4, A6) Headlamps.

The long, slim form of this T-handle allows the Torx® Bolts on the headlamps to be quickly and easily reached.

For removal and replacement of the door panelling e.g. BMW (3 series E36, 5 series E60)

Length:.....350 mm

KL-4305-6220

Mercedes



KL-4305-6220 Screwdriver Torx® T20

For removing and replacing the door handle Mercedes A Class and C Class.

The long, slim form of this Screwdriver allows the Torx® -Bolts on the door handle to be quickly and easily reached.

Length:.....300 mm

Weight:60 g

KL-4306-8320

Mercedes



5-Point

KL-4306-8320 5-point screwdriver set (T20 x 260 mm)

Suitable for Mercedes.

The length and narrow shape of the **KL-4306-8320** five-star screwdriver makes it ideal for removing and installing outside mirrors on Mercedes vehicles.

Note:

(The following retaining screws are used on Mercedes vehicles with the outside mirror shown here:)

OEM: = Torx® T20 (KL-4306-6320) or 5-point T20
MB spare part = 5-point T20

Weight:100 g

Size:.....T20

Shaft Length255 mm

Overall length:295 mm



KL-4306-8320

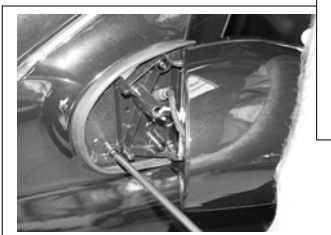

Note: Further screwdriver and screwdriver sets see chapter 10.

KL-0375-10

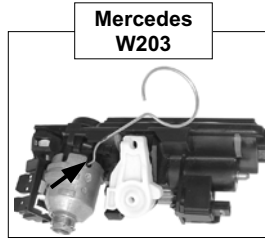
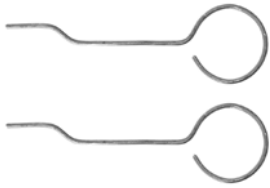

Mercedes
W203

KL-0375-10 Needle Set for Tail Gate Lock

For Mercedes C Class (W203) Tail gate lock.

For quick and easy removal of the Locking Cylinder from the Tail gate Lock mechanism.

The Set consists of 2 Pins made from stainless steel (V2A).

KL-0374-30

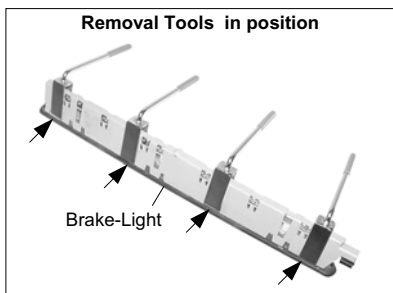
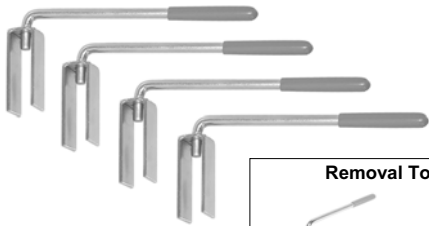

Mercedes
W210

Removal Tools in position

Brake-Light

KL-0374-30 Removal Tool Set (4 pcs.)

For Mercedes E Class (W210) Estate Car.

Required to remove the high-level brake-light from the tail-gate. All four retaining clips must be held open using the 4 piece removal tool set.

Failure to use these tools will result in damage to the mounting and the brake-light.

KL-0374-1

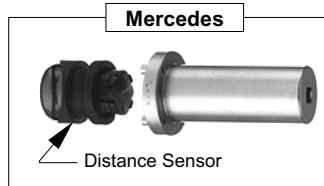

Mercedes

Distance Sensor

KL-0374-1 Toothed Socket for Distance Sensor

For removal and replacement of the Distance Sensor which is built-in to the rear bumpers of Mercedes S Class (W140) and E Class (W210).

Not only for removal and replacement, but also for mounting the Distance Sensor with the correct tightening torque.

Drive: 3/8"□

Length: 135 mm

KL-0192-22



Mercedes

KL-0192-22 Safety Clip Pliers

Suitable for all Audi A3, VW Golf IV with Petrol engines

To release the fuel line unions. Needed for example when the fuel filter is changed.

Suitable for Mercedes W124, W140 and W202.

For installing retaining clips to secure the chrome strip on the bumper of the Mercedes W124, W140 and W202.

Therefore, the pliers is equipped with special clip retaining notches.

Length: 210 mm

Weight: 200 g

KL-0190-41

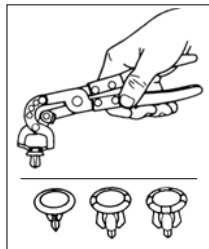

KL-0190-41 Rivet Removal Pliers

With 90° rotating head.

To remove 2-part re-usable plastic rivets - examples: on Trim or inner door facings.

By lifting the central spreader pin with the Pliers KL-0190-41 the Plastic Rivet may be withdrawn.

KL-0190-7

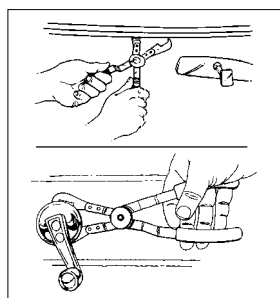

KL-0190-7 Windscreen Moulding / Door Handle Clip Pliers

For removal and replacement of the Ω Retaining Clips on Sun Visors, Rear-view Mirrors and Window-winders, etc.

This tool is applicable to most vehicles.

The tool prevents damage to Visors, Head-linings, Door-linings, etc.

KL-0190-81

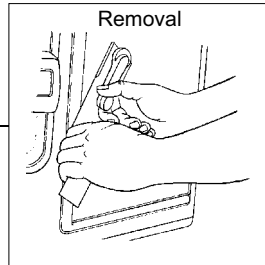
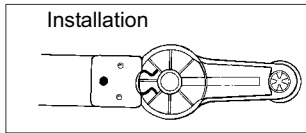

KL-0190-82



KL-0190-10

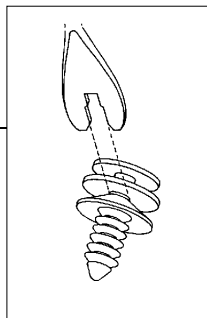

KL-0190-4



KL-0194-130

KL-0194-13



KL-0194-14



KL-0194-15



KL-0194-16



KL-0194-100

KL-0194-10



KL-0194-11



KL-0194-12



KL-0190-81 Window and Door Handle Clip Remover/Installer

For removal and replacement of the Ω Retaining Clips on Door-handles, Window-winders, etc.

This tool is applicable to most vehicles.

The tool prevents damage to Visors, Head-linings, Doorlinings, etc.

Weight: 140 g

KL-0190-82 Window and Door Handle Clip Remover/Installer

To remove and replace the Ω -Retaining Clips found on Door handles, Window Winders, etc.

Application: For almost all passenger cars.

KL-0190-10 Trim Pry

For removal of door inner-linings.

Weight: 200 g

KL-0190-4 Upholstery Pliers

Universal.

For removal of door inner-linings and other trim items held in place by plastic rivets.

KL-0194-130 Set of plastic wedges (4 pcs.)

The four plastic wedges are particularly suitable for body work such as removing and installing trim strips, door trims, door clips etc.

Contents / Technical Data:

Part-No.	Description	Measures [mm]	Weight [g]
KL-0194-130	Set of plastic wedges		250
<i>consists of:</i>			
KL-0194-13	Plastic wedge with felt	255 x 20 x 25	75
KL-0194-14	Plastic wedge with straight and angled tip	250 x 20 x 10	35
KL-0194-15	Plastic wedge	200 x 30 x 25	75
KL-0194-16	Plastic wedge angled with cutout and pin (for door clips).	230 x 22 x 8	55

KL-0194-131 Set of plastic wedges (3 pcs.) (not ill.)

As **KL-0194-130** but consists of **KL-0194-13**, **KL-0194-14** and **KL-0194-15**.

KL-0194-100 Nylon Lever Set

The Nylon Lever Sets allows the easy removal of ornamental ledges, door covering, windscreen rubber, etc.

Because the lever sets are made of nylon no damage is caused when used on glass, paintwork and door covers.

Specification / Technical Data:

Part No	Description	Measures [mm]	Weight [g]
KL-0194-100	Nylon Lever Set		
<i>consists of:</i>			
KL-0194-10	Nylon Mount Wedge	200 x 26 x 26	100
KL-0194-11	Nylon Mount Lever	Length: 201	15
KL-0194-12	Nylon Mount Lever	Length: 202	25

KL-0190-100

KL-0190-100

KL-0190-10

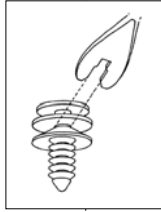

KL-0190-4

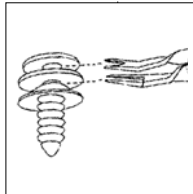

KL-0190-82

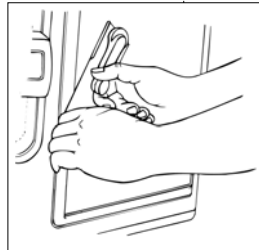

KL-0194-130

KL-0194-13

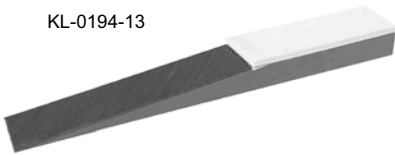

KL-0194-14



KL-0194-15

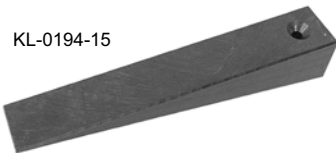

KL-0194-16

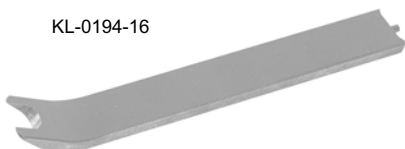

KL-0190-100 Removal Tool Set for door and side panel trims

Correct removal of interior trim elements or similar still remains a problem for the mechanic.

In contrast to work inside the engine compartment, under the car or on the brakes, the car's owner will not overlook *marks or damage inside the car caused by repair works.*

Damaged screw heads, scratched paint or marks caused by the use of unsuitable tools reflect badly on the quality of the workshop.

If interior trim elements are removed carefully, by the correct procedure and using suitable tools, it will be easy to avoid such problems.

Advantage

- universal using.
- Clean working methods.
- No damage to trim elements.

Consists of:

Part no.	Description	Qty.
KL-0190-10	Release lever to remove door panel trims.	1
KL-0190-4	Universal door trip pliers to release most types of clip. Also suitable for trim strips, rubber bumper facings, etc.	1
KL-0190-82	Door spring release tool to remove and install retaining clips e.g. on door handles, window crank handles, etc. Suitable for almost all vehicles.	1
KL-0194-130	Set of plastic wedges (4 pcs.) The four plastic wedges are particularly suitable to operate on the car body e.g. removing and installing door trims, door clips, trim strips, etc. consists of:	1
KL-0194-13	Plastic wedge with felt (255x20x25mm)	
KL-0194-14	Plastic wedge with straight and angled tip (250x20x10mm)	
KL-0194-15	Plastic wedge (200x30x35mm)	
KL-0194-16	Angled plastic wedge with cutout and peg for door clips (230x22x8mm)	

Accessories: KL-4990-1007 - Plastic storage case
(not ill.)

Measures: Outer 340x275x83 mm
Inner 326x222x77 mm

KL-0190-50



KL-0190-50 Hog Ring Pliers Set

For closing Hog Rings to repair passenger car seats (various manufacturers).

Size: 220 × 115 × 33 mm

Weight: 500 g

Contents:

Part No.	Description	Qty
KL-0190-50	Hog Ring Pliers Set	1
<i>consists of:</i>		
KL-0190-5	Hog Ring Pliers	1
KL-0190-501	Hog Rings (100 Pcs)	1
	Plastic Storage Case	1

KL-0470-10

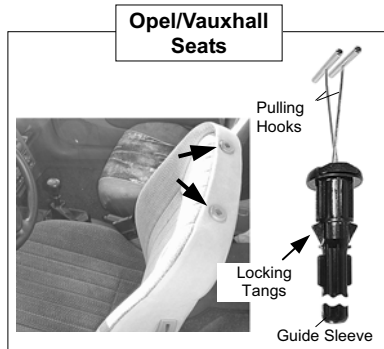

KL-0470-10 Pulling Hook Set

Suitable for Opel/Vauxhall Astra, Corsa, Frontera, Omega, Tigra, Vectra, Zafira

To allow the removal of the Head Support columns in the seat-back to be removed without the need to dismantle the upholstery, it is necessary to depress the inner locking tangs using KL-0470-10 Hook Set.

Length: 166 mm

Weight: 42g

KL-0194-41

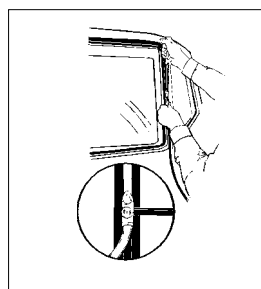
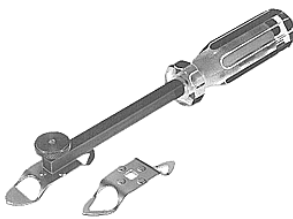

KL-0194-41 Windscreen Locking Strip Tool

Two Double-Ended Tips to Fit Most Applications.

Just select the tip with opening that most closely fits locking strip and then feed locking strip into eyelet.

Weight: 170 g

KL-0194-27



KL-0194-273
Square cut wire 50 m



KL-0194-27 Cutting Wire Tool Set

For cutting glued glass panes.

Consists of :

2 self sticking handle grips, 50 m of wire, 1 needle with eyelet, 1 wooden case (275x145x38mm).

Weight: 800 g

KL-0191-1



KL-0191-1 Gasket Scraper - Small

For cleaning of sealing faces especially at narrow space conditions, due to short design. Quenched and tempered blade.

Length: 180 mm
Blade width: 24 mm

KL-0191-2



KL-0191-2 Gasket Scraper

For cleaning of sealing faces on engine, gearbox etc. Long design. Quenched and tempered blade.

Length: 245 mm
Blade width: 24 mm

KL-0191-3



KL-0191-3 Gasket Scraper - Large

For cleaning of sealing faces, large design. This tool is also applicable for removal of under body sealant.

Length: 180 mm
Blade width: 32 mm

KL-0191-61



KL-0191-61 Gasket Scraper

For removing stickers from windscreens, bumpers etc.

Length: 165 mm
Blade width: 40 mm
Weight: 200 g

Spare part:

KL-0191-611 Stainless steel blade set (10 Pcs.)

KL-0191-30



KL-0191-30 Gasket Scraper Set

Suitable to clean sealing faces, small and large design. Required also to remove underbody coatings during repairs.

The tool set contains, for each blade width, a scraper with flexible blade and one with extra sturdy blade.

Length: 230 mm
Blade width: 31,5 mm
Blade strength: 1,2 mm
Weight: 109 g

Length: 230 mm
Blade width: 31,5 mm
Blade strength: 2,5 mm
Weight: 145 g

Length: 180 mm
Blade width: 20 mm
Blade strength: 1,2 mm
Weight: 90 g

Length: 180 mm
Blade width: 20 mm
Blade strength: 2,5 mm
Weight: 107 g

KL-0192-24



KL-0192-25



KL-0157-2

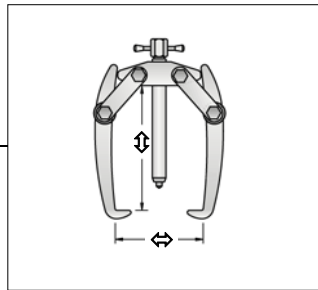

KL-0157-1



KL-0153-5 K



Universal

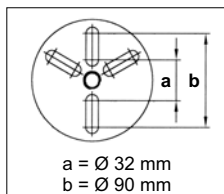

KL-0192-24 Flat Round Pliers

With extra long grip, for difficult to get to positions.

Length:.....280 mm

KL-0192-25 Flat Round Pliers angled 45°

With extra long grip, angled 45°, for difficult to get to positions.

Length:.....280 mm

KL-0157-2 Twin-Arm Battery-terminal puller

The perfect tool for removing small parts such as battery terminals, pulleys, wheels, ball bearings, etc. The hook tips grip automatically.

Part-No:	↔ [mm]	↕ [mm]	Load _{max.}	Weight [kg]
KL-0157-2	60	40	0,5 t.	0,3

KL-0157-1 Twin-Arm Battery-terminal puller

The perfect tool for removing small parts such as battery terminals, pulleys, wheels, ball bearings, etc. The hook tips grip automatically.

Part-No:	↔ [mm]	↕ [mm]	Load _{max.}	Weight [kg]
KL-0157-1	60	60	0,5 t.	0,3

KL-0153-5 K Puller Set

Puller Set for Steering Wheels, Sprockets, Pulleys and Shafts, etc.

Range:..... Ø 32 - Ø 90 mm

Consists of:

- Puller Disc: Ø-110mm (2+3 Hole mounting) with Spindle.
- Allen®-bolt: M8x1,25 x 100 3 pcs.
- Allen®-bolt: M10x1,25 x 100 3 pcs.
- Hex bolt:..... M8x1,25 x 80 3 pcs.
- Hex bolt:..... M10x1,5 x 50 3 pcs.
- Hex bolt:..... 1/4" UNF x 75 2 pcs.
- Hex bolt:..... 5/16" UNF x 90 2 pcs.
- Hex bolt:..... 5/16" UNC x 50 3 pcs.
- Hex bolt:..... 5/16" UNC x 110 3 pcs.
- Hex bolt:..... 3/8" UNF x 50 3 pcs.
- Hex bolt:..... 3/8" UNC x 100 3 pcs.
- Washers:..... 1/4"x19 2 Pcs.; 5/16"x18 3 Pcs.; 3/8"x20 3 pcs.

The Set is delivered in Plastic Storage Case.

KL-0153-1

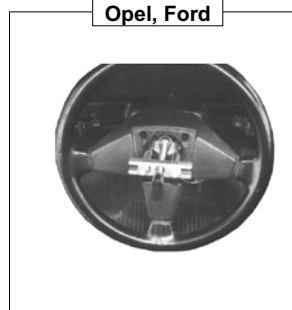

KL-0153-1 Steering Wheel Puller

For **Opel, Ford etc.**

Steering wheels which are stuck on the steering column may be pulled off cleanly, quickly and without damage to the steering column and steering wheel with the puller **KL-0153-1**.

The different length of the puller arms and the longitudinal groove in the yoke allows an almost universal application of this puller tool.

Adjusting Range: max. 90 mm

Height: 135 mm

Advantages of the puller tool:

- Universal application.
- No damage to the steering wheel during pulling action.

KL-0153-3



Opel

KL-0153-3 Steering Wheel Puller

As **KL-0153-1** but for **Opel Frontera**.

The special design of this puller permits a damage free separation of steering wheel and steering column.

Fork opening: 39.8 mm

KL-0153-4



Opel

KL-0153-4 Steering Wheel Puller

As **KL-0153-3** but for **Opel Monterey**.

KL-0153-2



Mercedes



KL-0153-2 Steering Wheel Puller

Suitable for **Mercedes** Transporters and trucks.

Allows easy removal of stubborn steering wheels without risk of damage to either steering column splines or the steering wheel.

Adjusting Range: 40 - 88 mm

Screws: M10 x 60

Advantages of the puller tool:

- Due to the longitudinal grooves in the puller plate, this puller can be universally used as a two arm puller as well as a three arm puller.
- Flanged nut of the spindle prevents a slip off of the operating tool.
- No damage to the steering wheel during extraction.

KL-0372-4

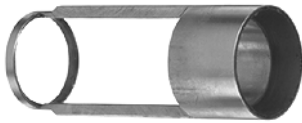

Mercedes W202, W210

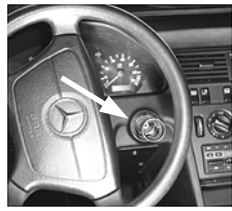

KL-0372-4 Sleeve for Ignition Switch

The mounting sleeve **KL-0372-4** is a special tool designed for removal and refitting the ignition switch on **Mercedes W202 and W210** up to '97.

The tool consists of tubular outer casing with a conical rubber insert.

KL-0372-5

Mercedes



KL-0372-5 Braker Bar

Overcomes problems on **Mercedes W124 and W201** up to 1993 if the ignition key should break in the ignition lock. In this event, the **KL-0372-5** allows the ignition switch assembly to be broken off the steering column so that a new switch assembly may be fitted.

Advantages of the tool:

- No damage to steering column and dash board.
- No drilling out of the locking switch.
- Increased job time saving.
- Low tool costs.
- No accidents.

KL-0372-6

Mercedes

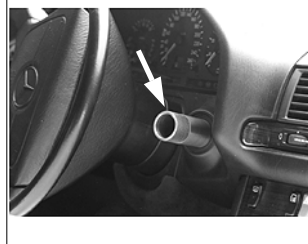

KL-0372-6 Assembly Sleeve for Ignition Switch

For removal and replacement of the ignition switch retaining ring fitted to **Mercedes types W129, W140, W203, W208, W209, W210, W211, W220 and W230 with FBS 2 and FBS 3 Ignition Switch.**

KL-0372-1

Mercedes

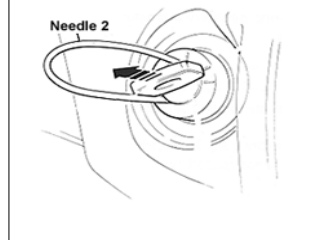
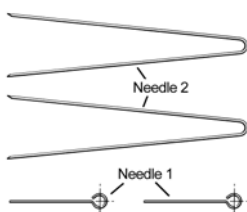

KL-0372-1 Needle Set for Ignition Switch

For removal of ignition switch on **Mercedes** passenger cars
The needle set **KL-0372-1** contains needles of size 1 and size 2 with a diameter of 1.25 and 2.0 mm.

They are applicable for the removal of the ignition switch on following types:

- Needle 1 on **Mercedes W116, W123 and W126**
- Needle 2 on **Mercedes W124 and W201**

Advantages:

- Problem-free and quick removal of the ignition switch on the specified types.

KL-0372-70

Mercedes

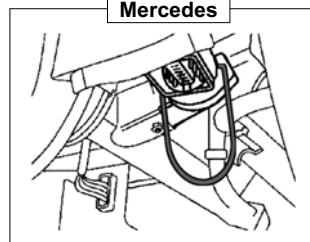

KL-0372-70 Spring Tool for Steering Lock protection sleeve (2 pcs.)

Suitable for **Mercedes W129, W140, W210 and W202 with FBS2 Ignition Switch**

To remove the Protection Sleeve with the Ignition Switch from the Steering Lock, it is necessary to press in both Locking Bolts in the Steering Lock using **KL-0372-7**.

The Set contains 2 Spring Tools made from stainless steel.

KL-0372-3

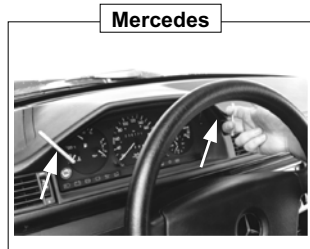
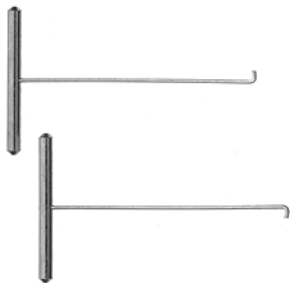

KL-0372-3 Pulling Hooks long

For easy removal of the instrument panel on **Mercedes passenger cars W116, W123, W124, W126, W129, W140, W201, W202, W203, W208, W209, W210, W211, W220 and W 230.**

KL-0191-10



KL-0191-10 Special Torx Driver T30 (with pilot)

This tool allows easy removal and replacement of the retaining screws on airbag fitted to **BMW, Mercedes.**

Access is permitted by special length of 85 mm with 1/4"-drive.

Length: 85 mm

Drive: 1/4"

Weight: 22 g

KL-0191-11



KL-0191-11 Special Torx Driver T30

This Tool allows easy removal and replacement of the retaining screws on airbags fitted to **VW, Audi, Opel, Renault** etc.

Length: 85 mm

Drive: 1/4"

Weight: 22 g

KL-0242-10

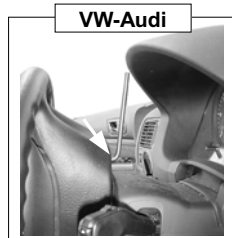

KL-0242-10 Airbag Removal Tool Set (2 pcs.)

Suitable for Driver's air bag housing e.g. VW Golf IV, Lupo, New Beetle, Passat (B5) 97-onwards, Polo 99-onwards.

In order for the driver's air bag housing to be removed, it is necessary to loosen the retaining bridge with the **KL-0242-10** Airbag Removal Tool Set.

KL-0240-1

KL-0240-2

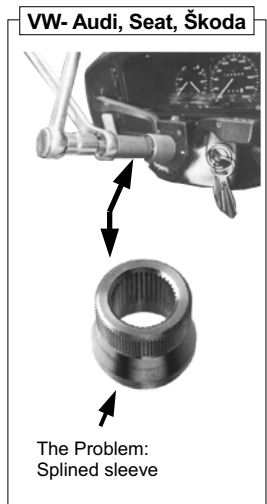

KL-0240-1 Steering Wheel Sleeve Puller vw

On **VW Golf II, Jetta, Golf III, Vento, Polo, Passat, etc.** from '88 onwards it is necessary to remove a splined sleeve after removal of the steering-wheel. The precise fit of this puller ensures a quick and easy removal of the sleeve without the risk of damage to the steering-column splines.

Chuck range: 27 - 30 mm

KL-0240-2 Drift for knocking out steering sleeves

The Drift **KL-0240-2** made of brass allows the sleeves on the steering-column to be separated without risk of damage.

KL-0190-23 KL-0190-24

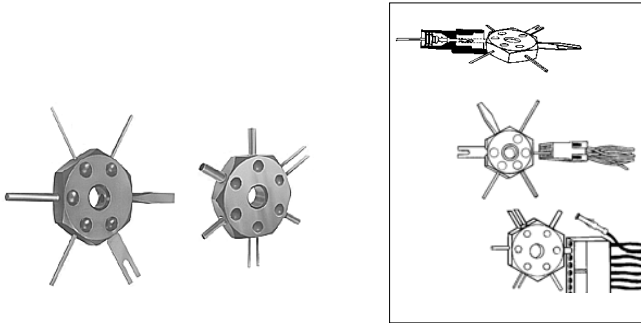

Terminal Tools

Eliminate Damaged Wires and Terminals.

Designed to remove wires from terminals without damage to either.

KL-0190-23 Ejecting Tool for Receptacles

Designed for Pack-Con and Weather-Pack terminals on GM C3 Systems. Tool can also retrieve trouble codes from engine computer on late model GM vehicles.

Weight:60 g

KL-0190-24 Ejecting Tool for Receptacles

Prongs depress the "barbs" on conventional terminals.

Weight:60 g

KL-0190-26 K



KL-0190-26 K Terminal Tool Set for push-on contacts

To release plug and socket cable connections.

During the release procedure the barbed hooks are pushed on the terminals by means of the tool forks, and then cables and plugs can be extracted.

Terminal tools:

Part No.	Description	Measures	Symbol
KL-0190-2601	Terminal Tool round with Spring "A"	3,3mm x 28mm	○
KL-0190-2602	Terminal Tool square "B"	1,4mm x 28mm	■
KL-0190-2603	Terminal Tool slot "C"	1,6mm x 25mm	⊖
KL-0190-2604	Terminal Tool slot "D"	2mm x 22,5mm	⊖
KL-0190-2605	Terminal Tool split slot "E"	8mm x 24mm	⊖
KL-0190-2606	Terminal Tool slot "F"	4,6mm x 25mm	⊖
KL-0190-2607	Terminal Tool round "G"	3,3mm x 28mm	○
KL-0190-2608	Terminal Tool round "H"	4,3mm x 13mm	○
KL-0190-2609	Terminal Tool round "I"	3,8mm x 12,3mm	○
KL-0190-2610	Terminal Tool round "J"	3,0mm x 12,5mm	○
KL-0190-2611	Terminal Tool split slot horizontal "K"	3,2mm x 19,2mm	⊖
KL-0190-2612	Terminal Tool split slot horizontal "L"	1,6mm x 16,3mm	⊖

Weight:300 g

KL-0190-20



KL-0190-20 Bulb Pliers (universal)

Application: **VW-Audi, Opel/Vauxhall, Ford, Mercedes, BMW.**

For quick and easy removal of bulbs from dashboards etc.

Length:..... 165 mm Weight: 150 g

KL-0190-21

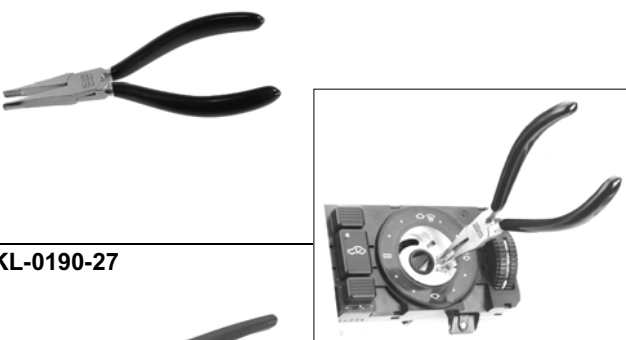

KL-0190-21 Bulb Pliers (universal)

For the removal of small light bulbs (Ø 4-6 mm) from dashboards etc.

Length:..... 135 mm Weight: 78 g

KL-0190-27



KL-0190-27 Bulb Pliers (universal)

Very light all-plastic pliers suitable to extract small glass-based light bulbs installed in control panels or in luminous switches.

Length:..... 156 mm Weight: 5 g

KL-0190-30

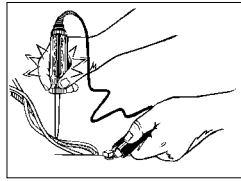

KL-0190-32

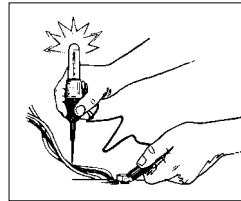

KL-0190-34

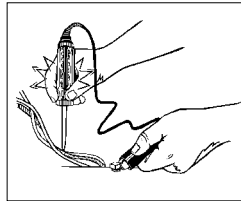

KL-0190-35

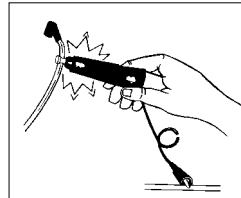

KL-0190-36

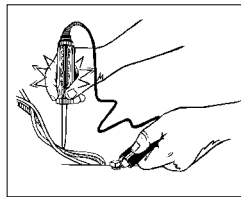

KL-0190-25

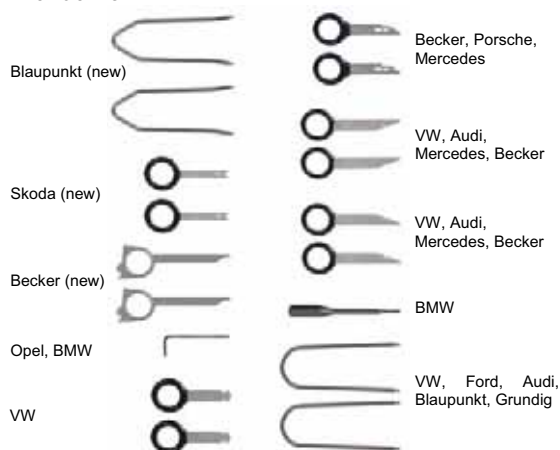

Blaupunkt (new)

Becker, Porsche, Mercedes

Skoda (new)

VW, Audi, Mercedes, Becker

Becker (new)

VW, Audi, Mercedes, Becker

Opel, BMW

BMW

VW

VW, Ford, Audi, Blaupunkt, Grundig

Release locking mechanisms and removal radios

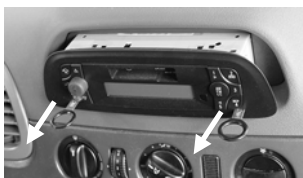

KL-0190-30 Pilot Lamp

The Test lamp allows checking of connections and cables up to 24 volts DC. Locates short-circuits and open-circuits.

The probe-tip is protected by a screw-cap.

Weight: 60 g

KL-0190-32 Pilot Lamp

Quick check both AC and DC current up to 28 volts with power on. Helps locate shorts or breaks in wiring. Complete with insulated grounding clip.

Weight:..... 85 g

KL-0190-34 Pilot Lamp

Quickly Tests Low Voltage up to 28 Volts.

The probe, handle, cord and clamp are reinforced for extra durability.

Weight:..... 170 g

KL-0190-35 Pilot Lamp

Checks Both Low Voltage and Spark Plug Wires.

The low - side checks AC and DC current up to 28 volts with power on. The high - side checks spark plug wires without piercing. Complete with insulated clip.

Weight:..... 85 g

KL-0190-36 Pilot Lamp

The test lamp is ideal for a rapid check on 3 - 20 Volt power lines and for determining the polarity.

Red light means + (positive),

Green light means - (negative) polarity

Can also be used for low currents from 21 mA.

Weight:..... 115 g

KL-0190-25 Unlocking Tool

Necessary to release car radios and navigation systems locking mechanisms.

Suitable e.g. for **VW-Audi, BMW, Ford, Skoda, Opel, Porsche, Mercedes** as well as **Becker, Blaupunkt, Grundig** etc.

Specification / Application:

Field of application	Qty
Blaupunkt (new)	2
Skoda (new)	2
Becker (new)	2
Opel, BMW	2
VW	2
Becker, Porsche, Mercedes	2
VW, Audi, Mercedes, Becker	4
BMW	2
VW, Ford, Audi, Blaupunkt, Grundig	2

The tool set is supplied in a plastic case.



GEDORE
Tools for life



CONVENTIONAL & MODULAR

Professional stripping



tools for life

© copyright GEDORE Germany